

**FOR
SALE**

OVERPASS MEDICAL DEVELOPMENT LAND

Fantastic I-229 & I-29 Development Land

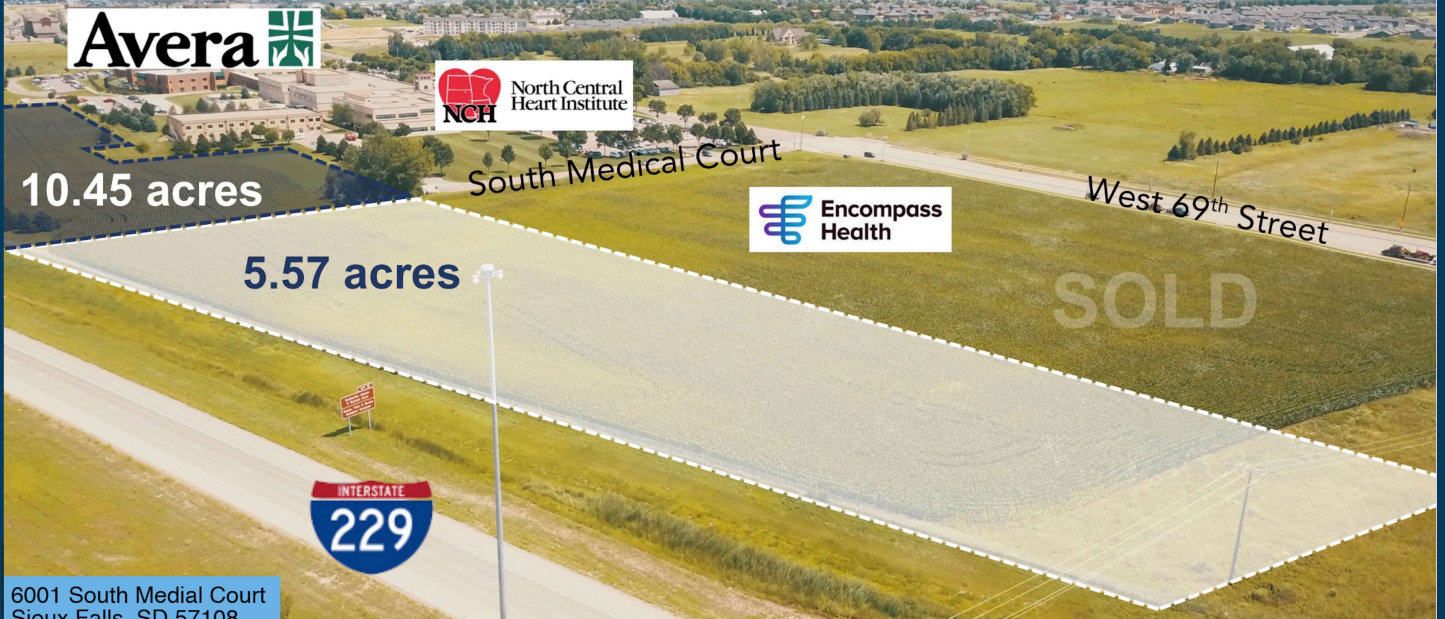

size

Lot 1: 5.57 acres
Lot 2: 10.45 acres
(can be sub-divided)



price

\$15.00 per square foot



traffic

Interstate 229: 40,336 VPD
69th Street: 5,300 VPD



zoning

S-1 Institutional



location

Incredible medical/hotel sites with premier interstate visibility.



co-tenancy

Avera Heart Hospital, North Central Heart Institute, Encompass Health, Avera Behavioral Health Center, Homewood Suites, Holiday Inn Express, Sioux Falls Lutheran School, Citi

Information deemed reliable but not guaranteed.



2571 South Westlake Drive #100
Sioux Falls, South Dakota 57106
VBClink.com | 605.361.8211



605.376.0127
Ryan.Tysdal@VBClink.com

Parcel Map



Aerial Map

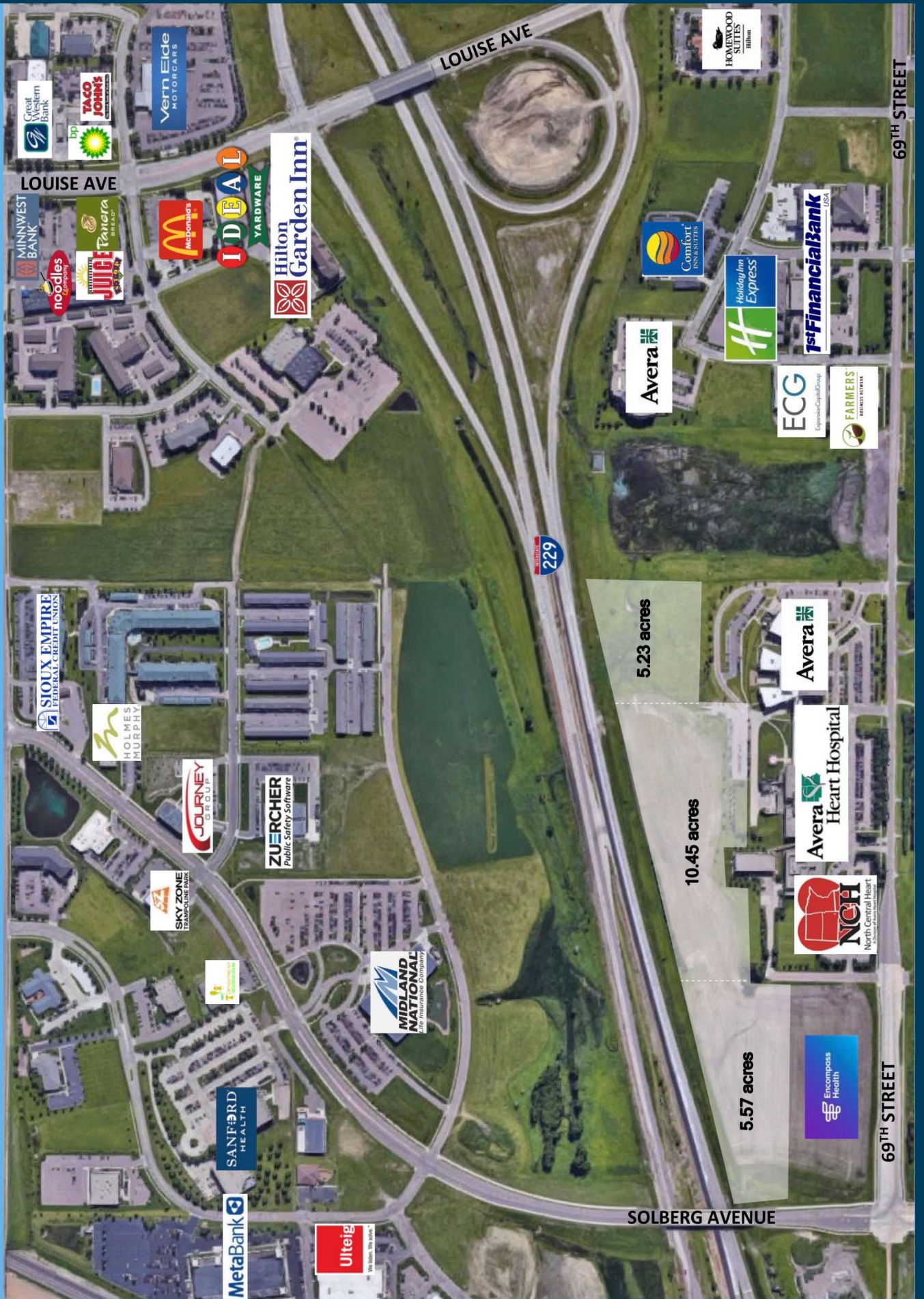



**SOUTHEAST
VIEW**



**WEST
VIEW**

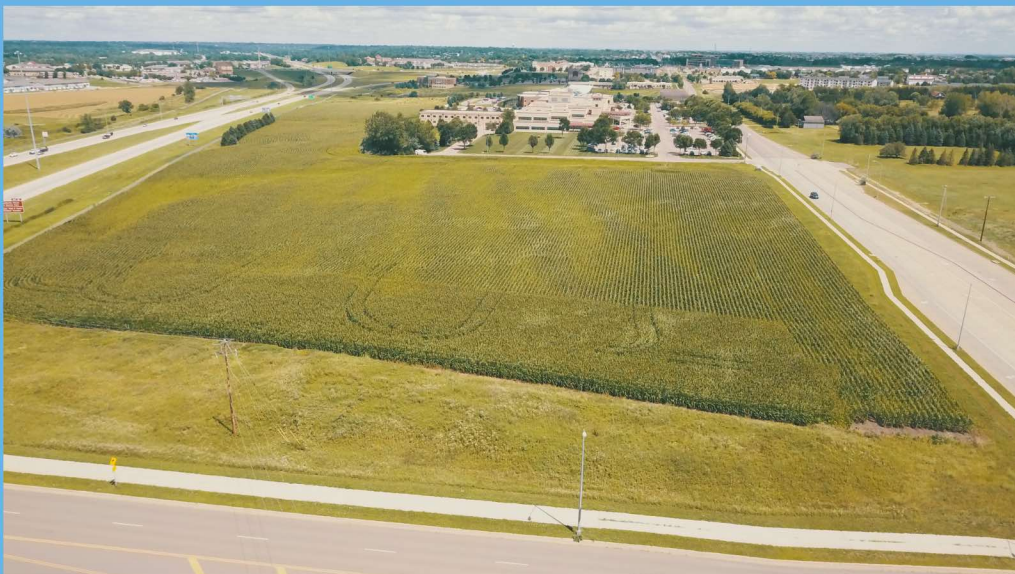

**EAST
VIEW**