

1112 - 1128 CHESTNUT STREET

PHILADELPHIA, PA

±35,220 SECOND FLOOR (DIVISIBLE) AVAILABLE FOR LEASE
SPACE A ±7,484 SF, SPACE B ±22,386 SF

JOIN



FINE WINE & GOOD SPIRITS



property highlights.

- Dramatic second floor space featuring a grand street level entrance/atrium with escalators directly up to space.
- Join a hugely successful Target (ground floor) and brand new Petsmart (lower level) in booming Midtown Village neighborhood.
- 60 dedicated parking spots in the rear of the building.
- Over 200' feet of frontage along Chestnut Street!
- Owned and Managed by

BRICKSTONE

LEADERS IN REAL ESTATE DEVELOPMENT



METRO[®]
COMMERCIAL
REAL ESTATE, INC.

MetroCommercial.com | PHILADELPHIA, PA | PLYMOUTH MEETING, PA | MOUNT LAUREL, NJ | NAPLES, FL

get in touch.

SCOTT BENSON

office 215.893.0300
direct 215.282.0158
sbenson@metrocommercial.com

IRYNA IRYK

office 215.893.0300
direct 215.282.0156
iiryk@metrocommercial.com

MICHAEL GORMAN

office 215.893.0300
direct 215.282.0152
mgorman@metrocommercial.com

SECOND FLOOR PLAN - EXISTING CONDITIONS

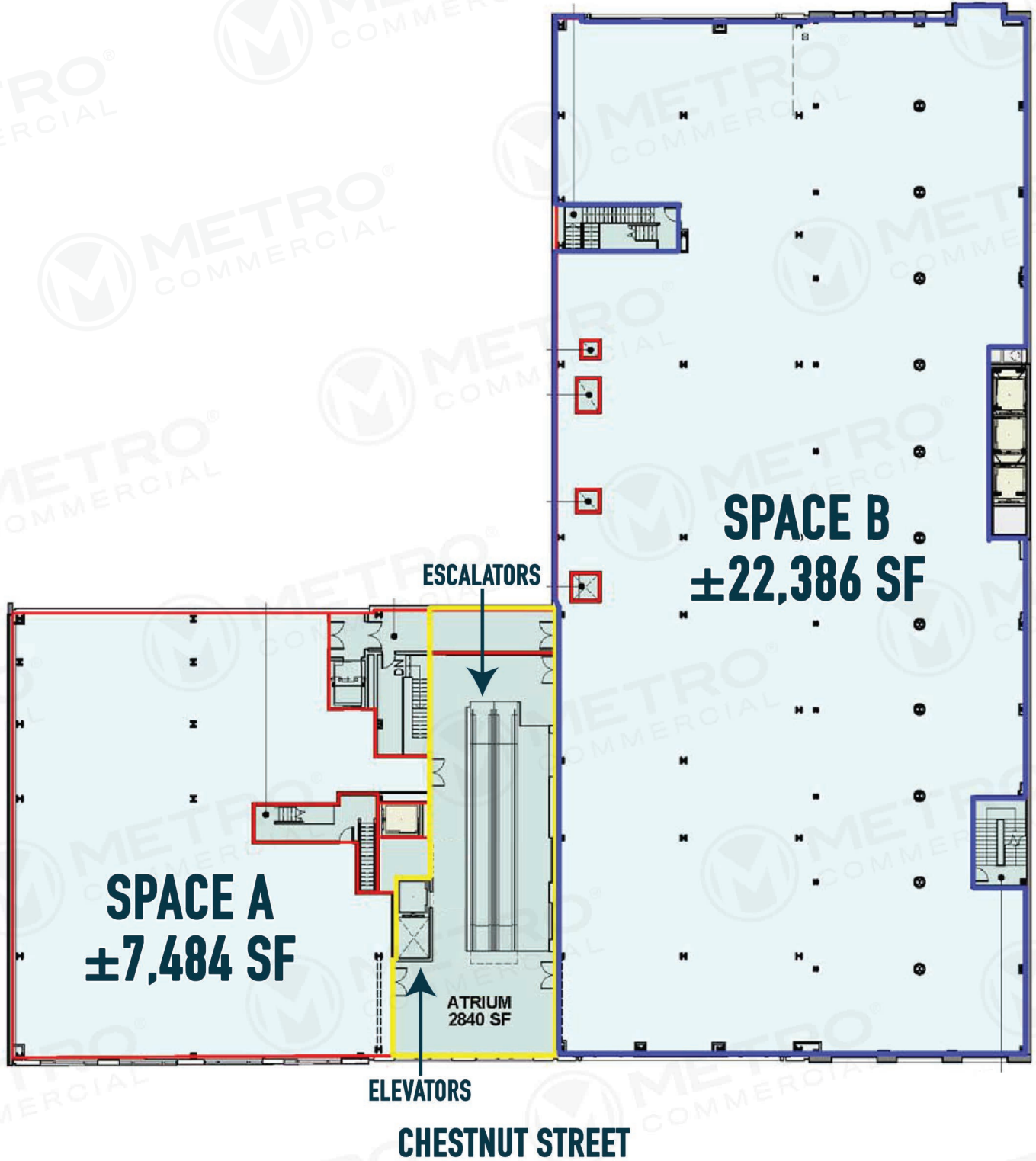

The information and images contained herein are from sources deemed reliable. However, Metro Commercial Real Estate, Inc. makes no representation whatsoever as to their accuracy or authenticity. Images shown may be modified for illustrative purposes. Images may be out-of-date and not current. 10.12.17

1112 - 1128 CHESTNUT STREET
PHILADELPHIA, PA



SECOND FLOOR PLAN - PROPOSED CONTIGUOUS SPACE

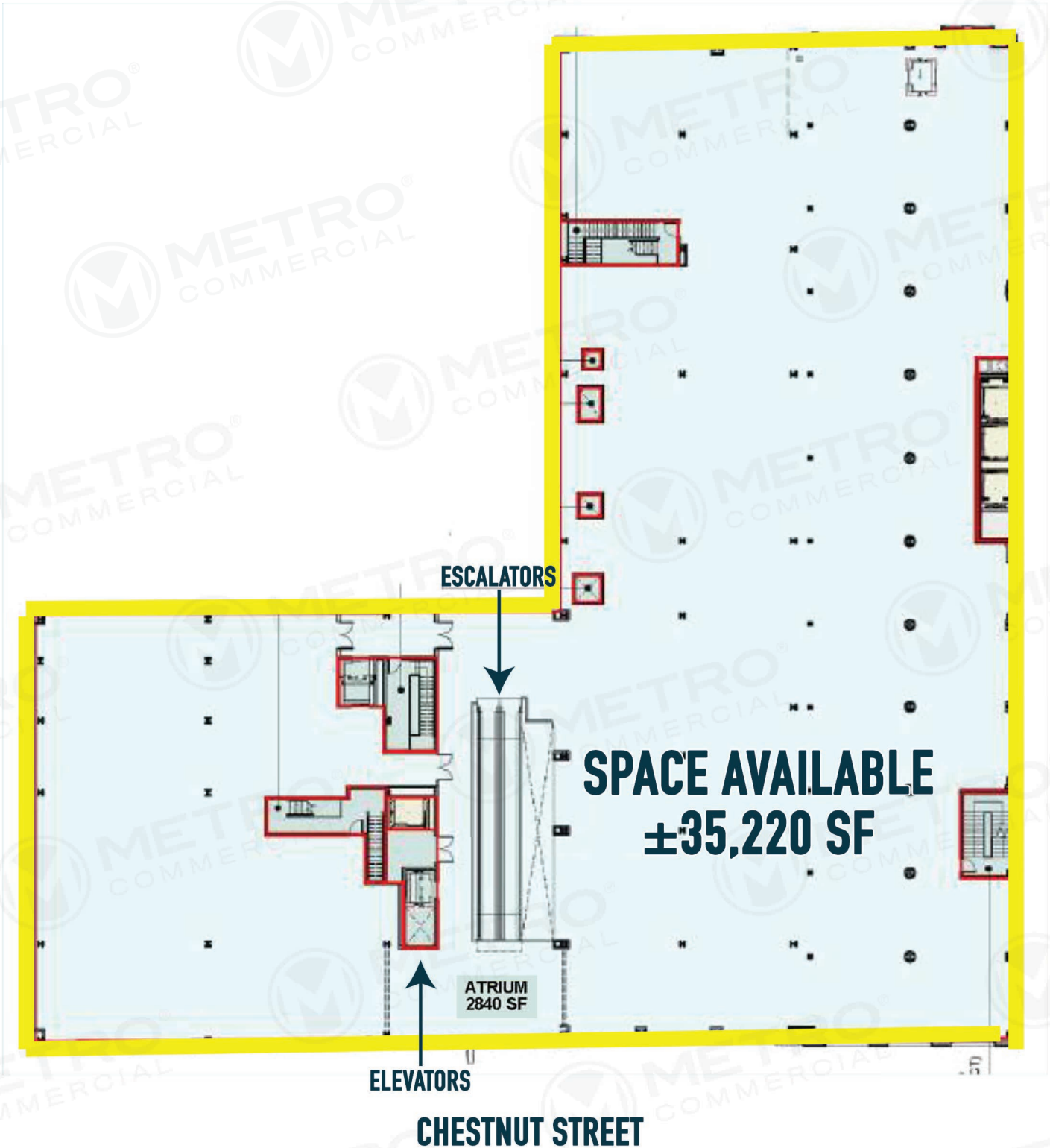

The information and images contained herein are from sources deemed reliable. However, Metro Commercial Real Estate, Inc. makes no representation whatsoever as to their accuracy or authenticity. Images shown may be modified for illustrative purposes. Images may be out-of-date and not current. 10.12.17

**1112 - 1128 CHESTNUT STREET
PHILADELPHIA, PA**



CITY HALL

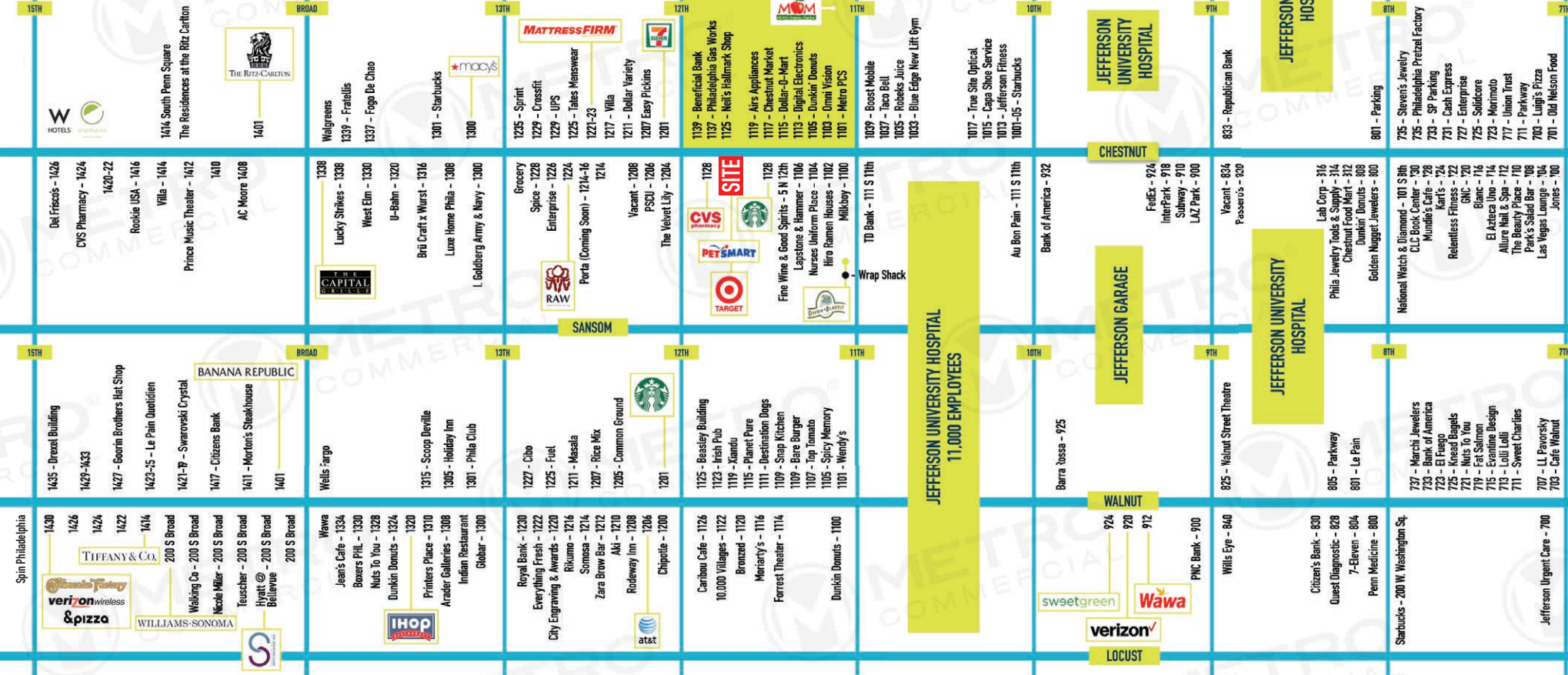

1112 - 1128 CHESTNUT STREET PHILADELPHIA, PA



The information and images contained herein are from sources deemed reliable. However, Metro Commercial Real Estate, Inc. makes no representation whatsoever as to their accuracy or authenticity. Images shown may be modified for illustrative purposes. Images may be out-of-date and not current. 10.12.17

PARKING LOT VIEW FACING NORTH

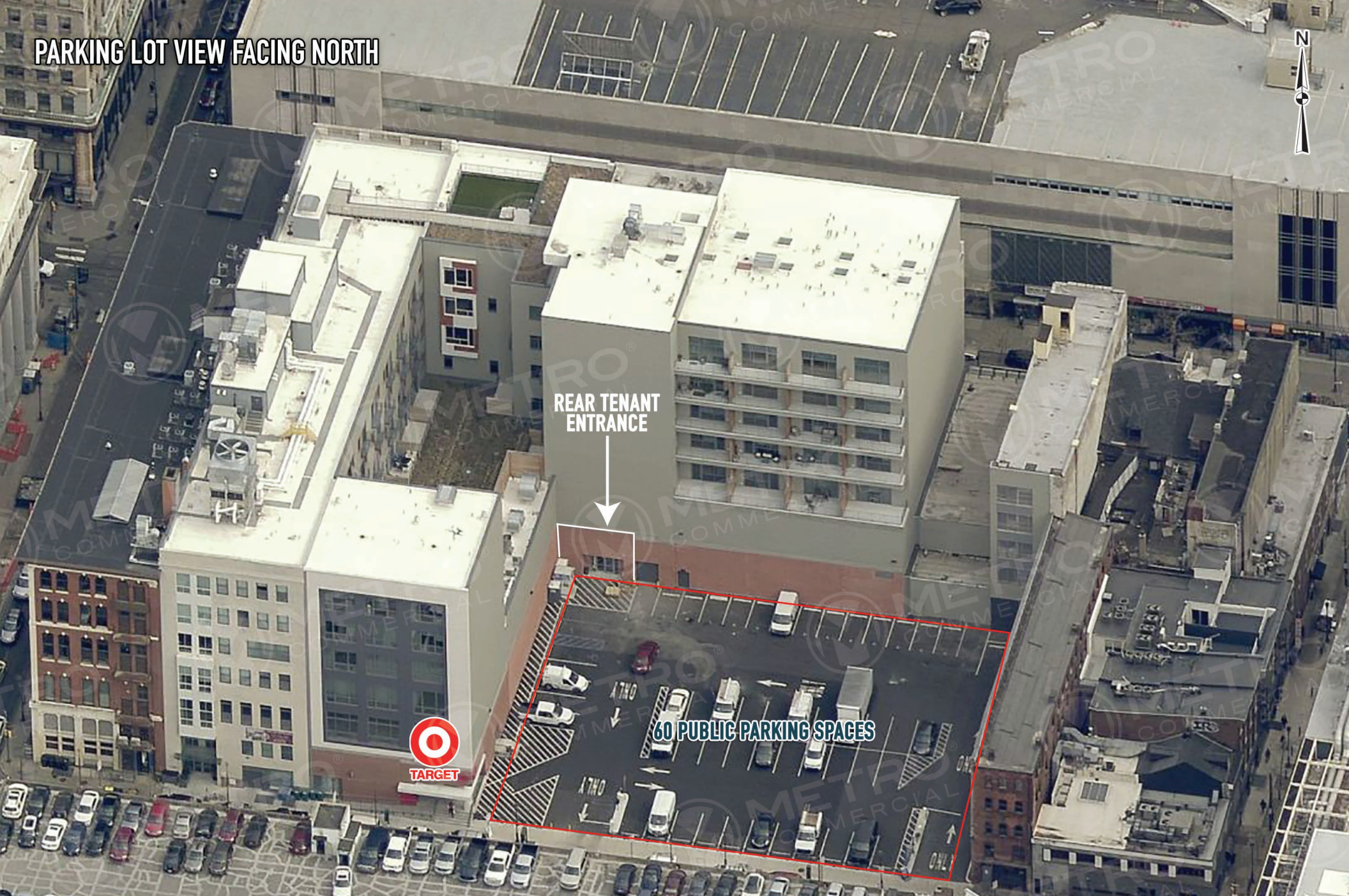

REAR TENANT
ENTRANCE



60 PUBLIC PARKING SPACES

The information and images contained herein are from sources deemed reliable. However, Metro Commercial Real Estate, Inc. makes no representation whatsoever as to their accuracy or authenticity. Images shown may be modified for illustrative purposes. Images may be out-of-date and not current. 10.12.17

**1112 - 1128 CHESTNUT STREET
PHILADELPHIA, PA**

