

F O R L E A S E

# 2210 SOUTH C STREET

Tacoma, WA 98402



CLICK HERE FOR  
VIRTUAL TOUR



## PROPERTY FEATURES

- + Many building improvements underway
- + Total building size:  $\pm 103,023$  SF
- + Multiple demising options available
- + Clear heights:
  - $\pm 12.5'$  -  $14'$  (north side)
  - $\pm 20'$  (south side)
- + Loading doors:
  - 3 GL on C Street (1 north side, 2 south side)
  - 4 DH on Hood Street (1 north side, 3 south side)
- + Heavy Power
- + Call for rates

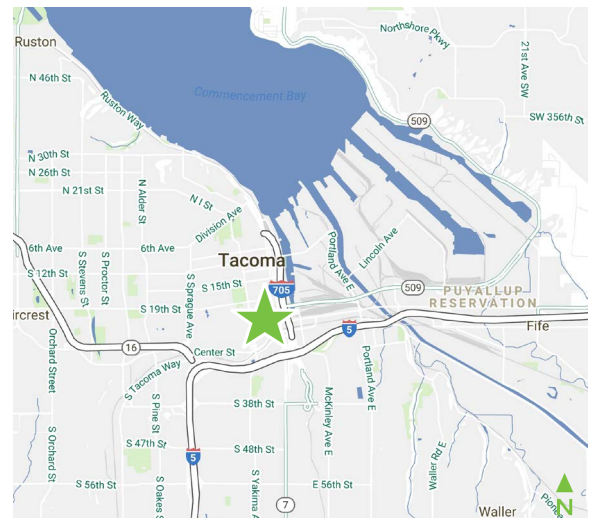

# FIRST FLOOR

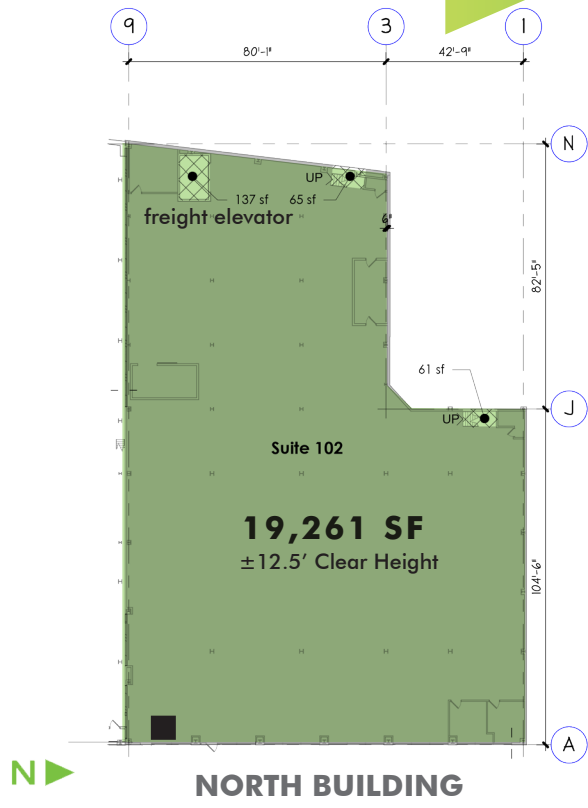
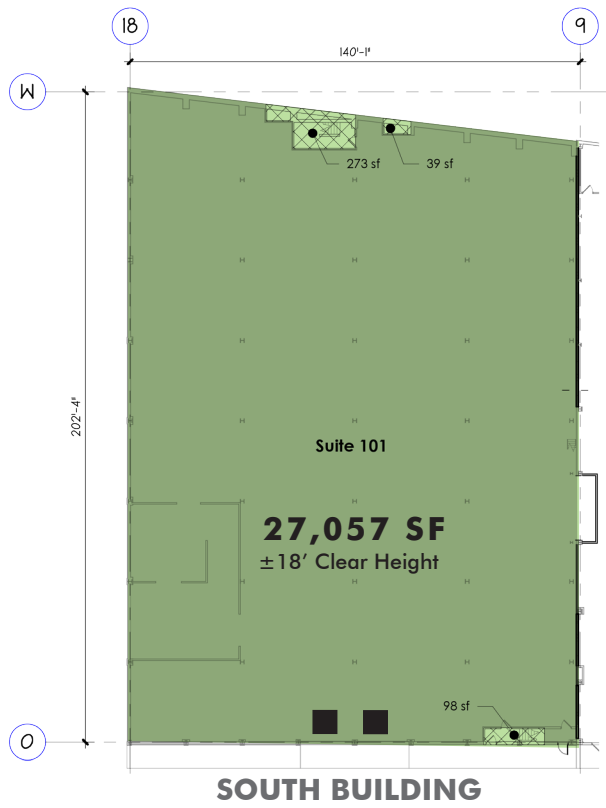

■ Grade Level Doors



## SECOND FLOOR

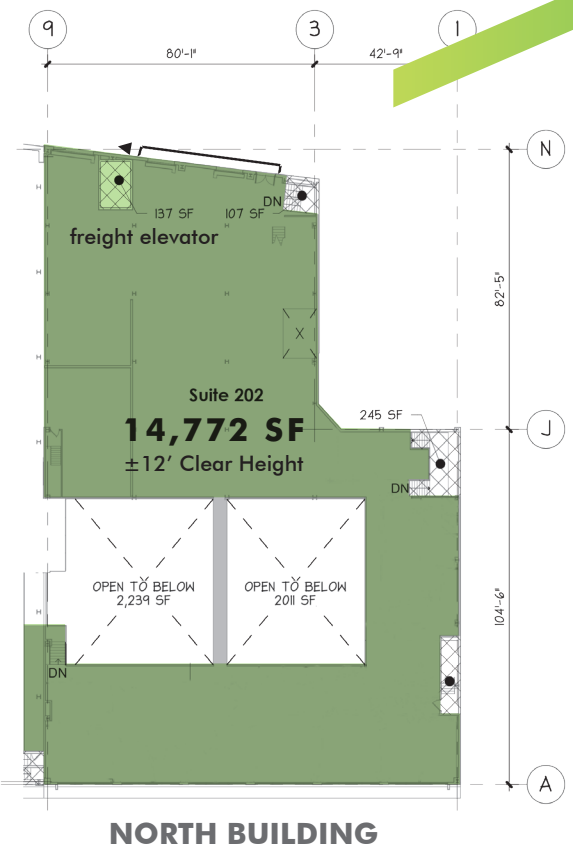

▼ Dock High Doors

## THIRD FLOOR

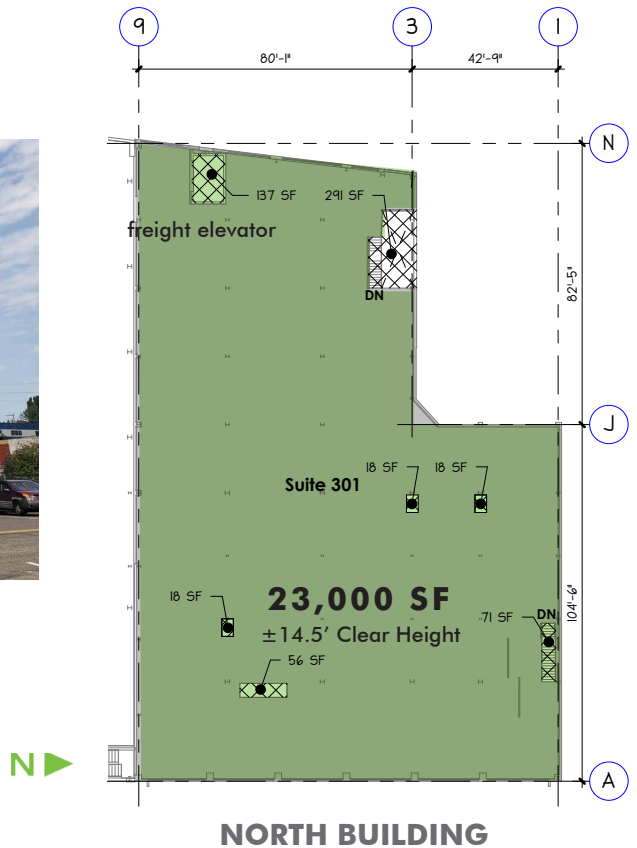

## LOCATION INFORMATION

- + Located in the heart of the Brewery District
- + Quick and easy access to I-705 and I-5
- + Near University of Washington Tacoma
- + Close proximity to Port of Tacoma

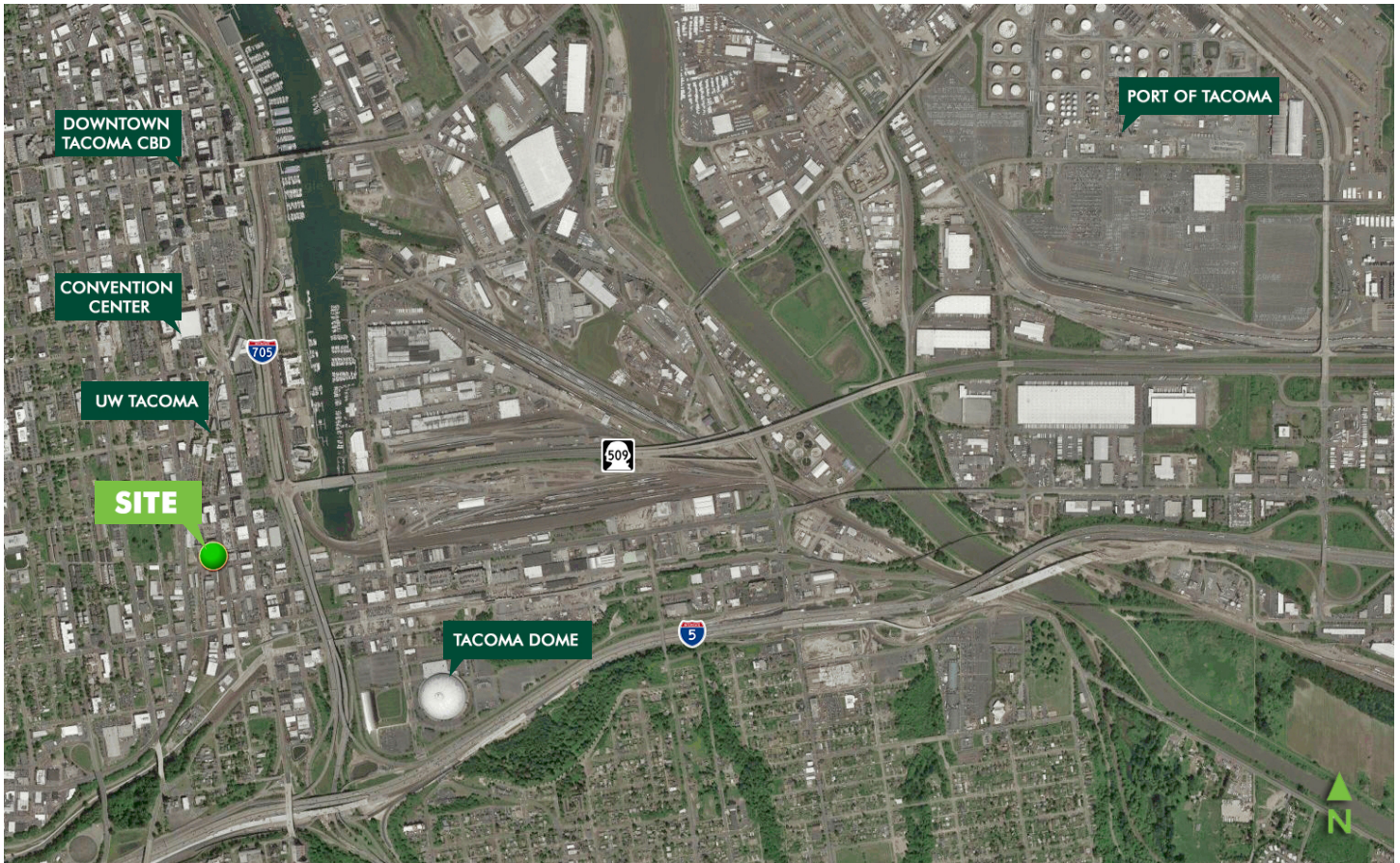

### PLEASE CONTACT:

#### MONTE DECKER

Senior Vice President  
+1 253 596 0041  
monte.decker@cbre.com

#### CHRIS COWLES

Senior Associate  
+1 253 596 0048  
chris.cowles@cbre.com

#### CBRE, INC.

1201 Pacific Avenue  
Suite 1502  
Tacoma, WA 98402

© 2019 CBRE, Inc. All rights reserved. This information has been obtained from sources believed reliable, but has not been verified for accuracy or completeness. You should conduct a careful, independent investigation of the property and verify all information. Any reliance on this information is solely at your own risk. CBRE and the CBRE logo are service marks of CBRE, Inc. All other marks displayed on this document are the property of their respective owners, and the use of such logos does not imply any affiliation with or endorsement of CBRE. Photos herein are the property of their respective owners. Use of these images without the express written consent of the owner is prohibited. RB 07.28.20