



±2,533 SF INDUSTRIAL SPACE AVAILABLE

# FOR LEASE

974 N. DUPAGE AVENUE | LOMBARD, IL 60148

- High-image business park
- Hard-to-find smaller unit with abundant parking
- Well-maintained
- Immediate access to I-355 & North Avenue
- Low DuPage County taxes

**JUSTIN LERNER, SIOR**  
847.588.5665  
justin.lerner@transwestern.com

**JOE KARMIN**  
847.588.5670  
joe.karmin@transwestern.com

 **TRANSWESTERN<sup>®</sup>**

5600 N. River Road, Suite 150, Rosemont, Illinois 60018  
P: 847-588-5700 • F: 847-588-0034 • transwestern.com



±2,533 SF INDUSTRIAL SPACE AVAILABLE

# FOR LEASE

974 N. DUPAGE AVENUE | LOMBARD, IL 60148

Professionally managed by:



## BUILDING SPECS

- Building Size: ±17,871 SF
- Available Size: ±2,533 SF
- Office Area: ±631 SF
- Ceiling Height: ±14' Clear
- Loading: 1 Drive-in Door
- Construction: Masonry
- Year Built: 1988
- Power: 400 Amps, 3-Phase
- Heating: Gas
- Real Estate Taxes: \$1.77 PSF (2017)
- Lease Rate: \$1,955/Month

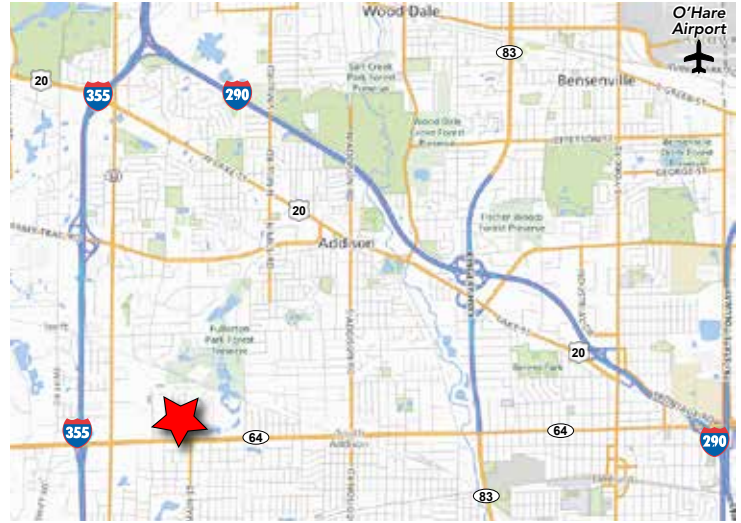

## BUILDING PLAN

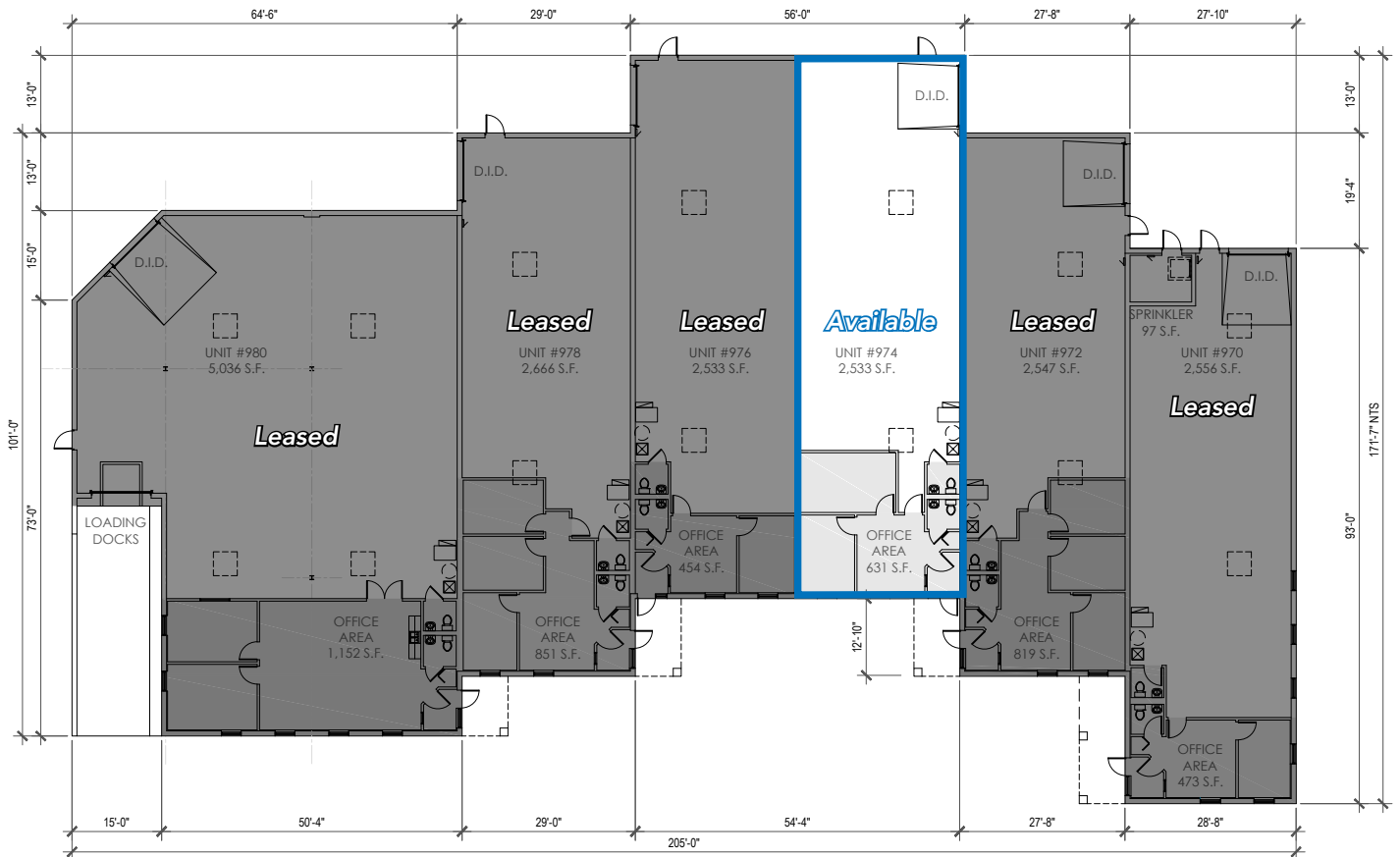

**JUSTIN LERNER, SIOR**  
 847.588.5665  
 justin.lerner@transwestern.com

**JOE KARMIN**  
 847.588.5670  
 joe.karmin@transwestern.com

**TRANSWESTERN®**  
 5600 N. River Road, Suite 150, Rosemont, Illinois 60018  
 P: 847-588-5700 • F: 847-588-0034 • transwestern.com

The information provided herein was obtained from sources believed reliable; however, Transwestern makes no guarantees, warranties or representations as to the completeness or accuracy thereof. The presentation of this property is submitted subject to errors, omissions, change of price or conditions, prior sale or lease, or withdrawal without notice. Copyright © 2018 Transwestern.