

4315 W RIVERSIDE DRIVE
BURBANK, CA 91505

cag | COMMERCIAL
ASSET GROUP

Restaurant Space
cag COMMERCIAL
ASSET GROUP
www.cag.com
For Lease
David Ilovics
David Auchkensy
Ryan Schmal
310.275.8222

TOLUCA LAKE/BURBANK MEDIA DISTRICT
RESTAURANT SPACE FOR LEASE

- +/-650 SF RESTAURANT SPACE ON THE INCREDIBLE BORDER OF THE BURBANK MEDIA DISTRICT AND TRENDY TOLUCA LAKE
- RARE +/-350 SF MULTI-PURPOSE SPACE ON PRIME RETAIL STREET
- LOCATION SERVES OVER 3 MILLION SF OF OFFICE SPACE WITHIN LESS THAN A 1/2 MILE, AS WELL AS THE AFFLUENT AND TRENDY TOLUCA LAKE RESIDENTIAL NEIGHBORHOODS
- DIRECTLY NEXT DOOR TO FUTURE TOCAYA ORGANICA AND LE PAIN QUOTIDIEN
- OTHER NEIGHBORING RESTAURANTS INCLUDE LEMONADE, VEGGIE GRILL, BOBS BIG BOY, STARBUCKS, SWEET SALT, CHIPOTLE, OLIVE & THYME, SIMPLE THINGS, FORMAN'S AND NUMEROUS OTHERS
- UNBELIEVABLE ON-SITE AND STREET PARKING
- PATIO SEATING AVAILABLE IN FRONT OF SPACE

SPACE

UNIT A ±650 SF RESTAURANT SPACE

~~UNIT B ±350 SF RETAIL SPACE~~

(LEASED)

RATE

UNIT A \$4,350 PER MONTH + NNN

~~UNIT B \$2,350 PER MONTH + NNN~~

(LEASED)

NNN

±\$.95 PSF

POSSESSION

UNIT A: 30 DAYS NOTICE

~~UNIT B: IMMEDIATELY~~

(LEASED)

These materials are based on information and content provided by others, which we believe are accurate. No guarantee, warranty or representation is made by Commercial Asset Group, Inc. or its personnel. All interested parties must independently verify accuracy and completeness. As well, any projections, assumptions, opinion, or estimates are used for example only and do not represent the current or future performance of the identified property. Your tax, financial, legal and toxic substance advisors should conduct a careful investigation of the property and its suitability for your needs, including land use limitations. The property is subject to prior lease, sale, change in price, or withdrawal from the market without notice.



UCLA
Health

uclahealth.org



tocaya
MODERN MEXICAN

tocayaorganica.com



Le Pain
QUOTIDIEN

lepainquotidien.net



Big
Boy

bobs.net

YOUR NEIGHBORS

FLOOR PLAN

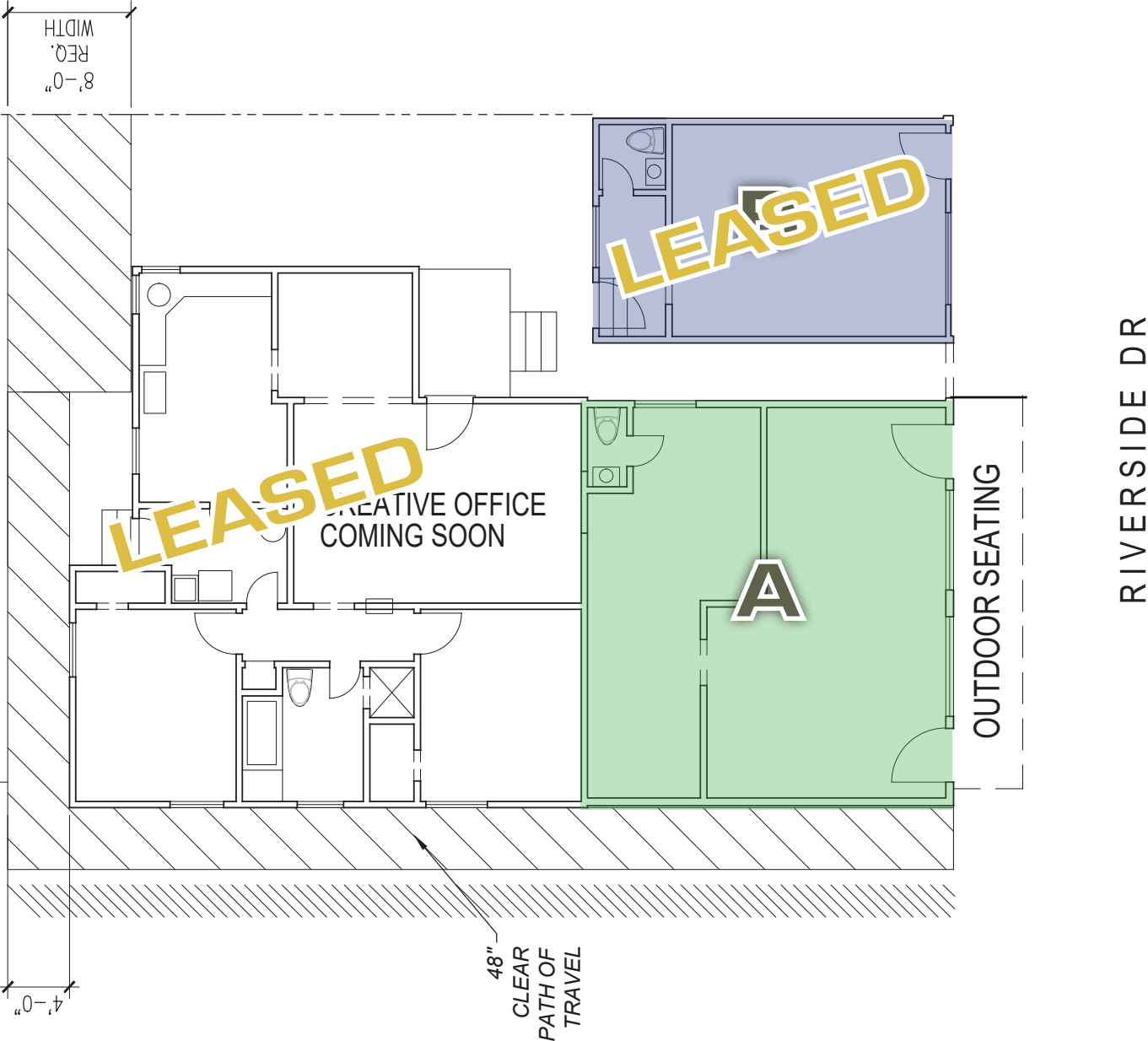



AREA MAP



STREET MAP

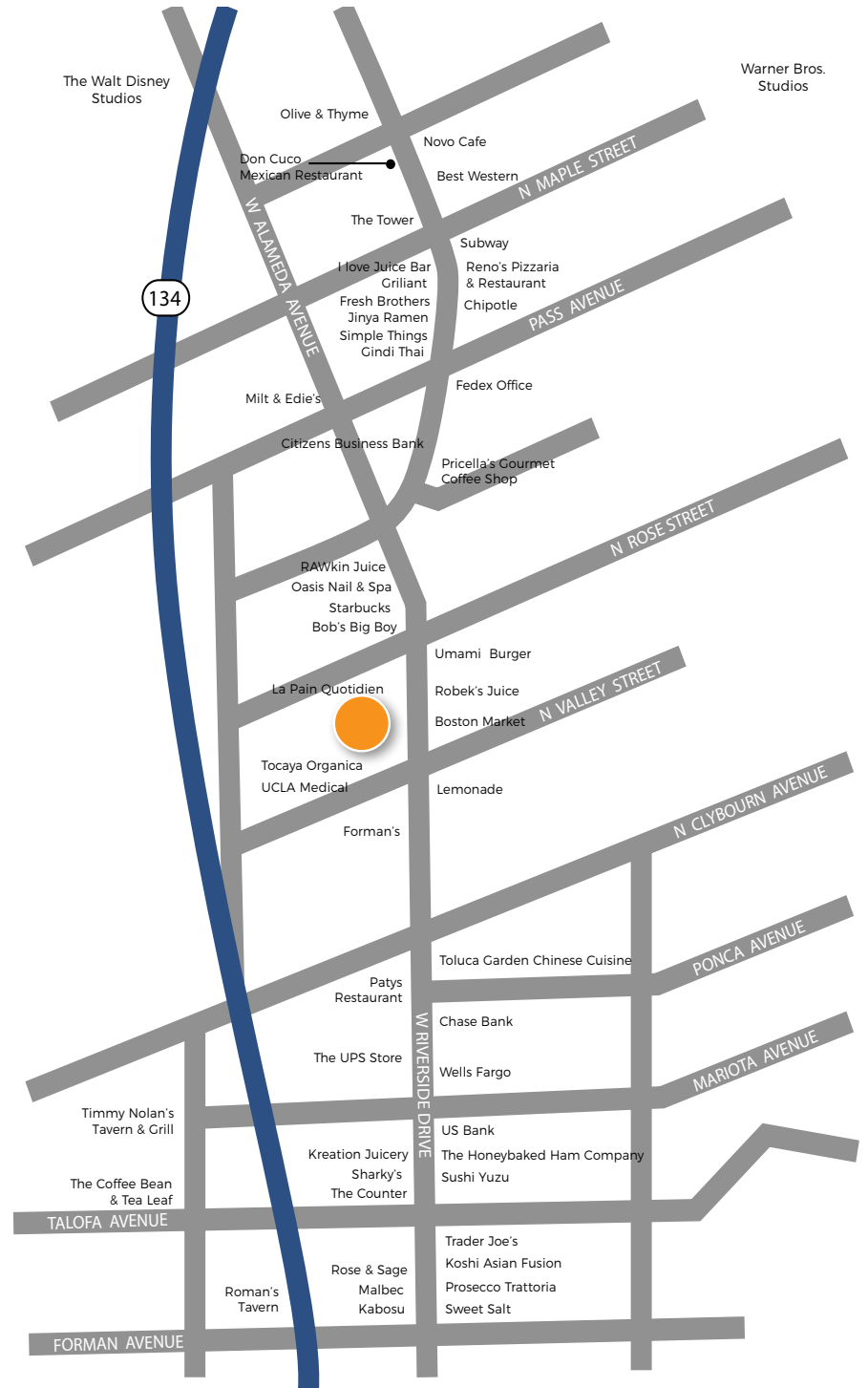



DAVID ASCHKENASY

SENIOR MANAGING DIRECTOR

P 310.272.7381

E DAVIDA@CAG-RE.COM

LIC. 01714442

JEREMY WINTNER

DIRECTOR

P 310.272.7390

E JEREMY@CAG-RE.COM

LIC. 02062054

COMMERCIAL ASSET GROUP

1801 CENTURY PARK EAST, STE 1550

LOS ANGELES, CA 90067

P 310.275.8222 F 818.385.1470

WWW.CAG-RE.COM LIC. 01876070