

260 PARK AVENUE SOUTH



CONCEPTUAL RENDERING

SPACE DETAILS

LOCATION

West block between East 20th and 21st Streets

APPROXIMATE SIZE

Ground Floor 1,840 SF

POSSESSION

Immediate

TERM

Long term

FRONTAGE

30 FT on Park Avenue South

CEILING HEIGHT

Ground Floor 15 FT

SITE STATUS

Formerly a portion of TD Bank

NEIGHBORS

Barbournia, Union Square Café, Herman Miller, Bank of America, Blue Bottle Coffee, New York Health & Racquet Club, Fotografisk, Morton Williams, Equinox Precision Running and Chase

COMMENTS

Unparalleled visibility in the heart of the Flatiron District

Directly between Union Square and the East 23rd Street and Park Avenue 6 subway line

All uses considered; dry use preferred

Lease out on the corner space with a medical use

GROUND FLOOR

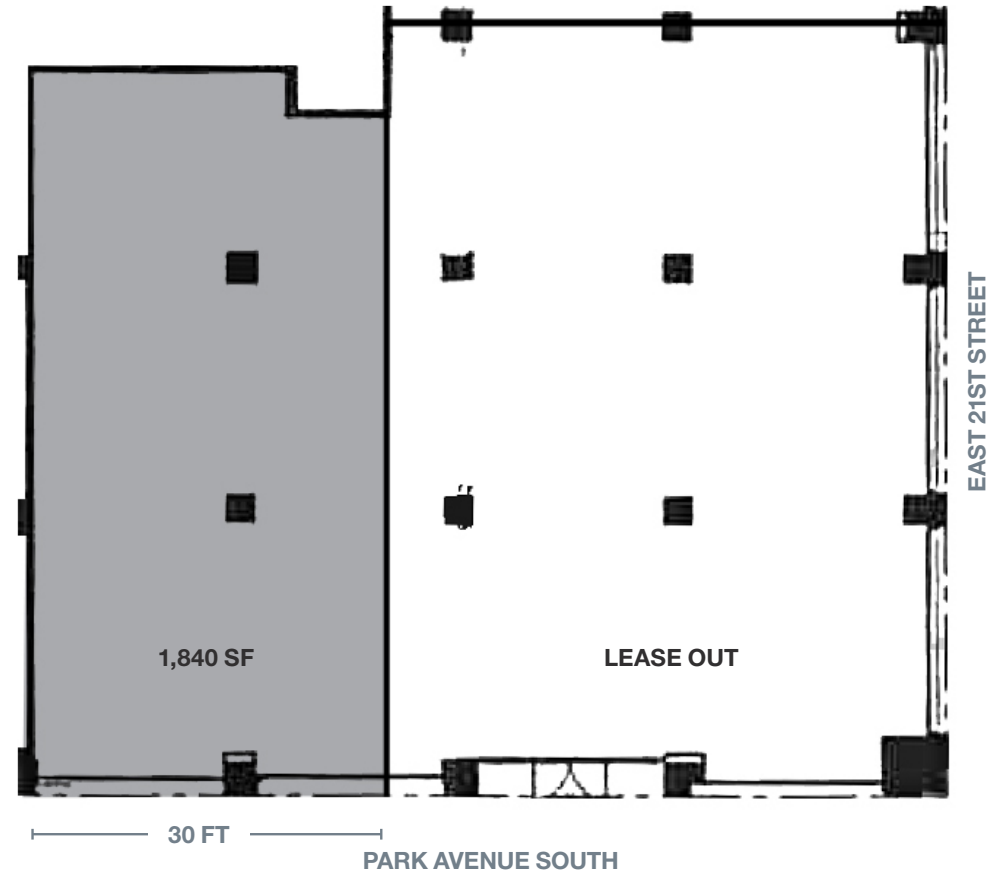

AREA RETAIL



+ COMING SOON

CONTACT EXCLUSIVE AGENTS

MICHAEL PASTER
212.351.9345
michael.paster@ngkf.com

JARED ROBINS
212.916.2925
jared.robins@ngkf.com

ARIEL SCHUSTER
212.331.0132
ariel.schuster@ngkf.com



NGKF.COM

© 2019 NEWMARK KNIGHT FRANK RETAIL. The information contained herein has been obtained from sources deemed reliable but has not been verified and no guarantee, warranty or representation, either express or implied, is made with respect to such information. Terms of sale or lease and availability are subject to change or withdrawal without notice.