

FOR LEASE MONTGOMERY PLAZA



LOCATION: 2925-2965 Beyer Blvd.
San Diego, California 92154

AVAILABLE: See site plan

TRAFFIC COUNT: Over 15,700 ADT (2006)

SANDAG

DEMOGRAPHICS:	<u>1 Mile</u>	<u>2 Miles</u>	<u>3 Miles</u>
Total 2009 Population:	36,257	172,401	259,966
Average 2009 HH Income:	\$51,599	\$59,485	\$65,311

LoopNet

COMMENTS:

- Excellent neighborhood strip center.
- Join O'Reilly Auto Parts, Pizza Hut, and State Farm in this dynamic center.
- Remodeled shopping center including paint and landscape.
- Very dense populated community.



For Further Information Contact:

Craig Duhs
619-491-0612 (Direct)
Craig@DuhsCommercial.com
CA License: 01086079



3026 University Ave, Suite B
San Diego, CA 92104

www.DuhsCommercial.com
619-491-0696 Fax

SITE PLAN

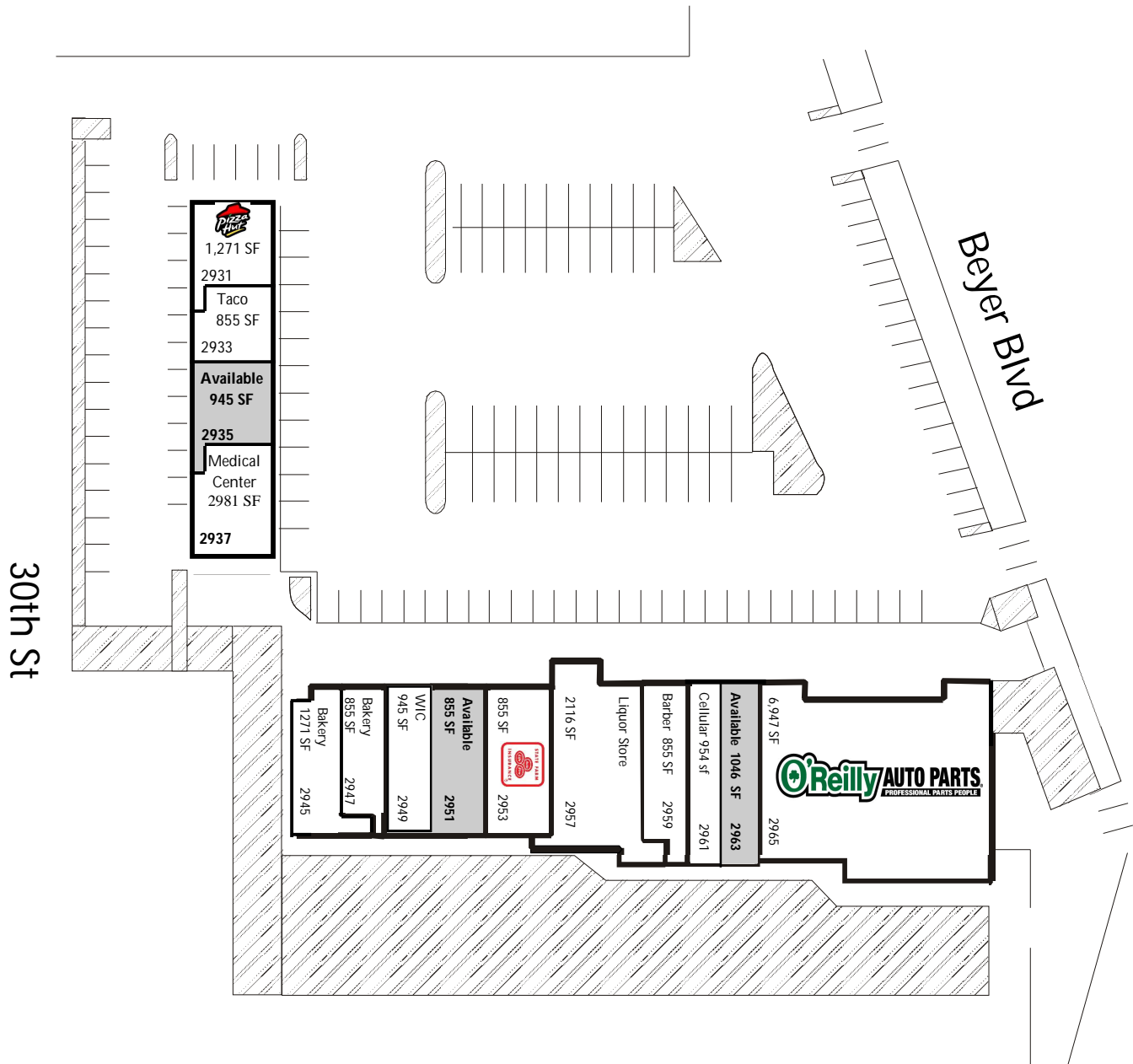

3026 University Ave, Suite B
San Diego, CA 92104

www.DuhsCommercial.com
619-491-0696 Fax

SITE PLAN



3026 University Ave, Suite B
San Diego, CA 92104

www.DuhsCommercial.com
619-491-0696 Fax