



1,582 to 9,938 SF Available
Office/Medical Office



Features

2nd & 3rd floor space available now

Parking ratio: 3.3/1000

Zoning: UC-1 (Urban Core District)

26,300 cars per day (SANDAG)

Asking Rent: \$2.25/SF NNN

Contact

Mary Kay Bier
858.232.0293
mkbier@kiddermathews.com
LIC #01406206

kiddermathews.com

For Lease

296 H St, Chula Vista, CA

Aerial Overview

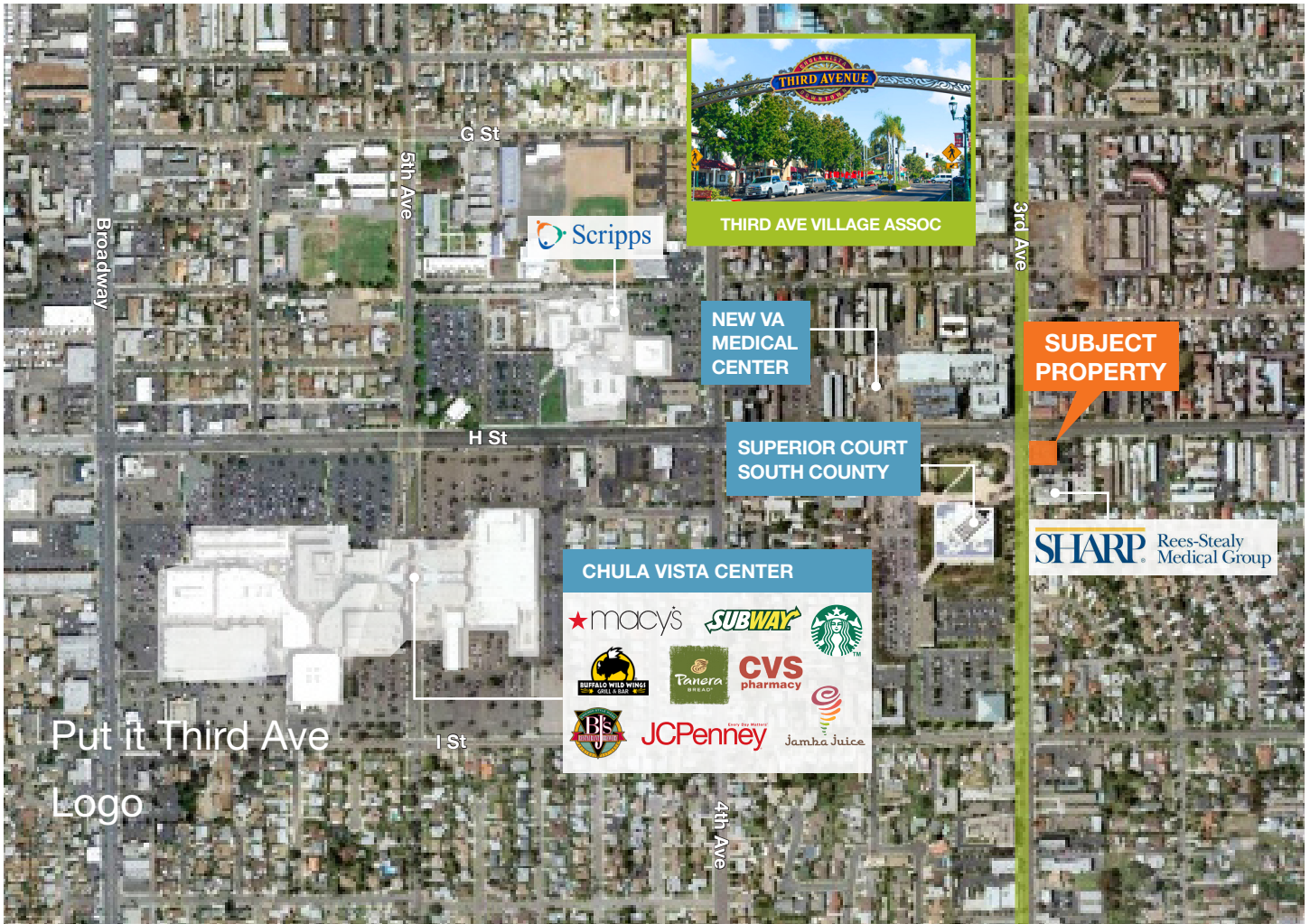

Contact

Mary Kay Bier

858.232.0293

mkbier@kiddermathews.com

LIC #01406206

kiddermathews.com

This information supplied herein is from sources we deem reliable. It is provided without any representation, warranty or guarantee, expressed or implied as to its accuracy. Prospective Buyer or Tenant should conduct an independent investigation and verification of all matters deemed to be material, including, but not limited to, statements of income and expenses. Consult your attorney, accountant, or other professional advisor.



For Lease

296 H St, Chula Vista, CA

Second Floor: 4,969 RSF

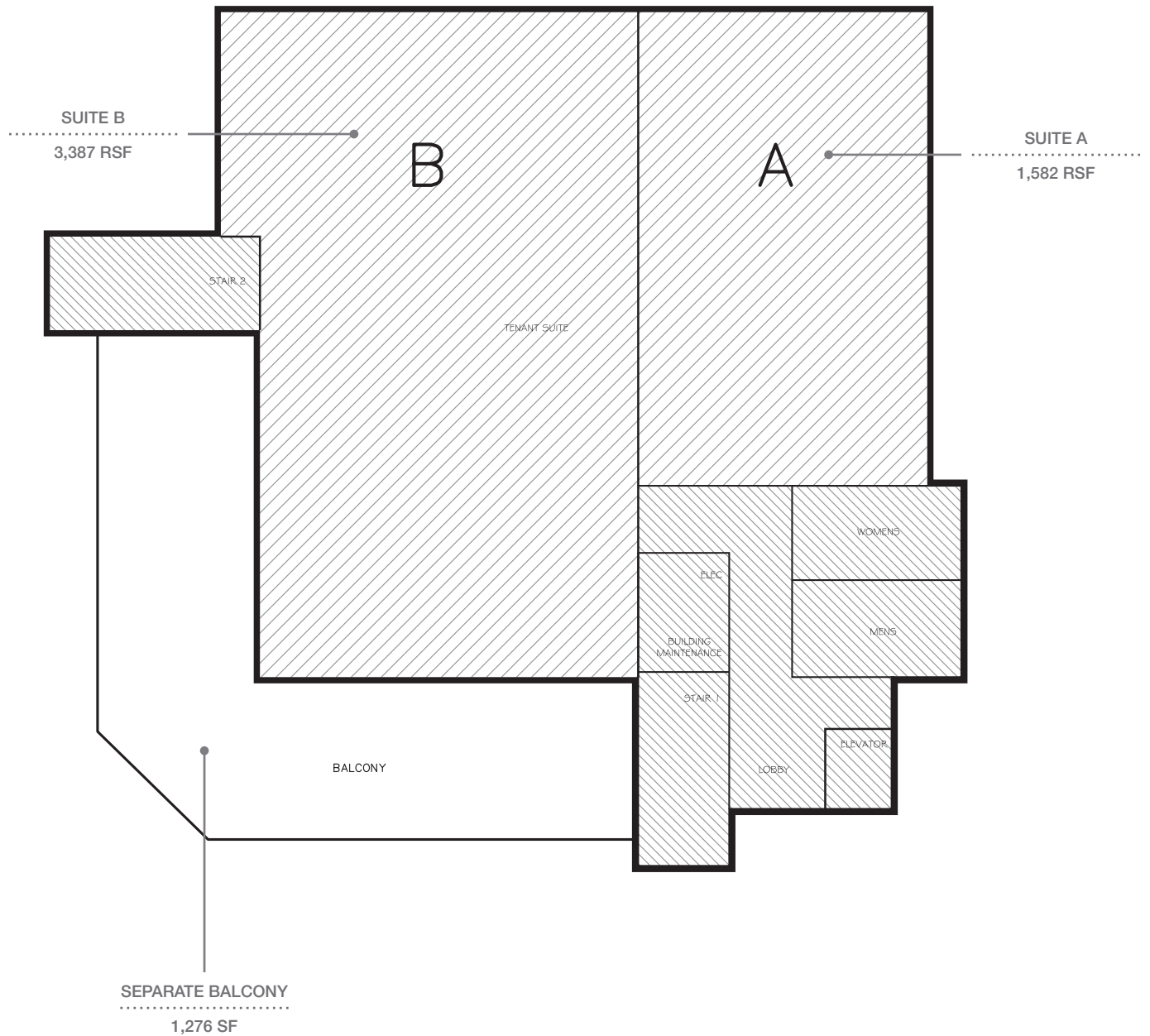

This information supplied herein is from sources we deem reliable. It is provided without any representation, warranty or guarantee, expressed or implied as to its accuracy. Prospective Buyer or Tenant should conduct an independent investigation and verification of all matters deemed to be material, including, but not limited to, statements of income and expenses. Consult your attorney, accountant, or other professional advisor.

For Lease

296 H St, Chula Vista, CA

Third Floor: 4,969 RSF

