

Vineyard Shopping Center

5100 Clayton Road, Concord, CA 94521



Property Highlights

90,274 Gross Leasable Area

12.82 Total Acres

189,694 5 Mile Population

- Located off Clayton Road which is a major connection between Clayton and downtown Concord.
- Benefits from nationally recognized anchor tenants including Kmart, Lucky Supermarket, McCaulou's Department Store, Orange Theory, Leslie's Pool Supplies and Baskin Robbins.
- Strong east Concord demographics which draws from a population within a 3-mile radius of 72,000 with an average household income of \$147,000.



Demographics

	1-Mile	3-Mile	5-Mile
Population	18,921	72,288	189,694
Households	7,433	27,026	68,885
Avg HH Income	\$124,492	\$147,632	\$131,844

Source: Esri, 2020

Vineyard Shopping Center

5100 Clayton Road, Concord, CA 94521

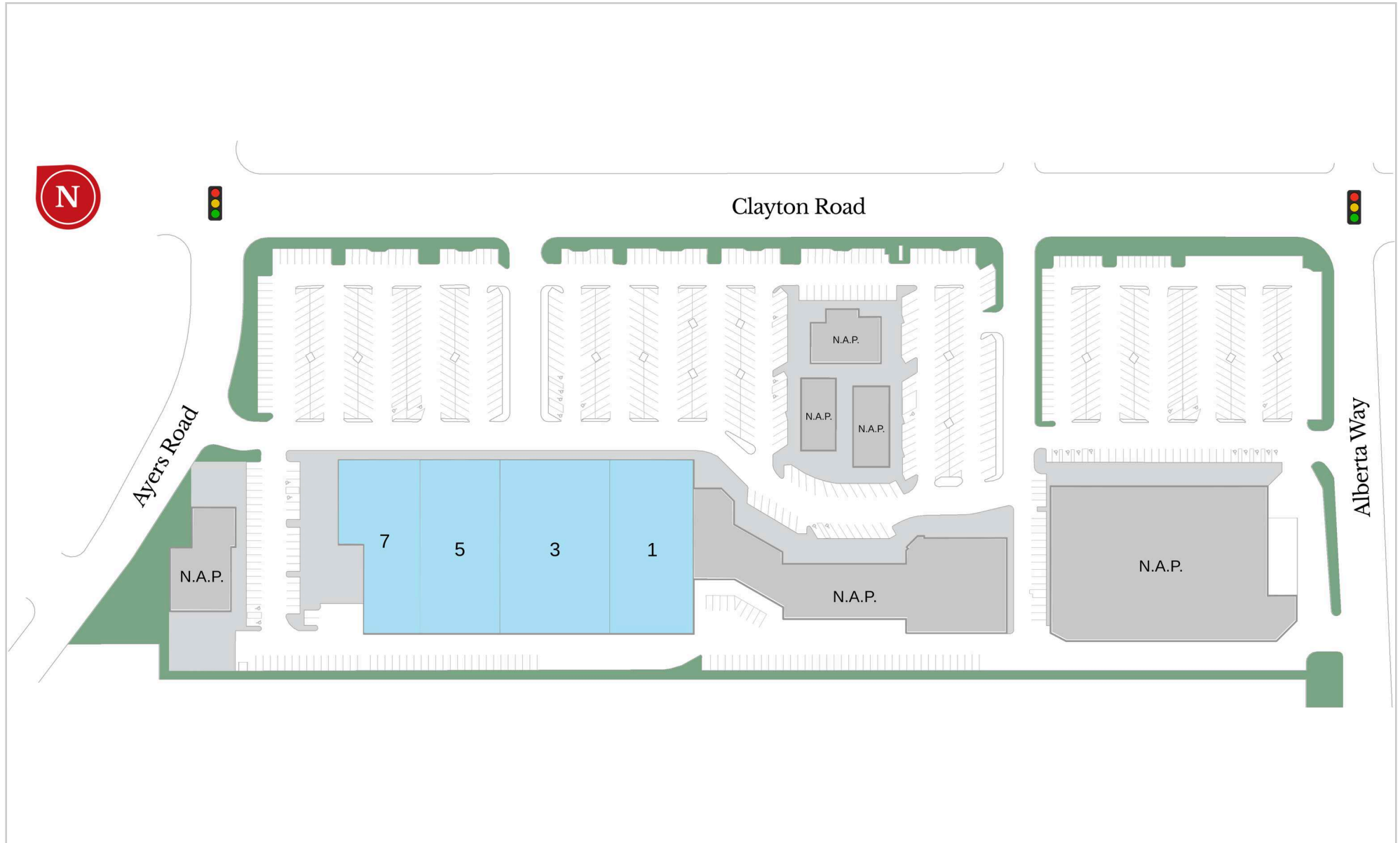

Vineyard Shopping Center

5100 Clayton Road, Concord, CA 94521

Current Tenants

Available/Coming Soon

1	Available	22,011 SF
3	Available	29,170 SF
5	Available	20,203 SF
7	Available	18,890 SF