

FOR SALE / LEASE

# 246 Route 31

WASHINGTON TOWNSHIP, NJ 07882

RETAIL



## PROPERTY INFO

- + Approximately 12 acres available for sale, ground lease, or build-to-suit
- + Located at the intersection of Springtown Road and Route 31
- + Zoned Business Commercial
- + Suitable for bank, medical/urgent care, fast food, daycare, convenience store, specialty market, and many other retail uses
- + Traffic Count – Route 31 = 18,729 cars per day

### Demographics 2018

	1 mile	3 miles	5 miles
Population	4,851	16,233	26,809
Average Household Income	\$95,245	\$109,653	\$113,566
Daytime Population	4,281	13,027	19,945



FOR SALE / LEASE

# 246 Route 31

WASHINGTON TOWNSHIP, NJ 07882

RETAIL

## MARKET AERIAL

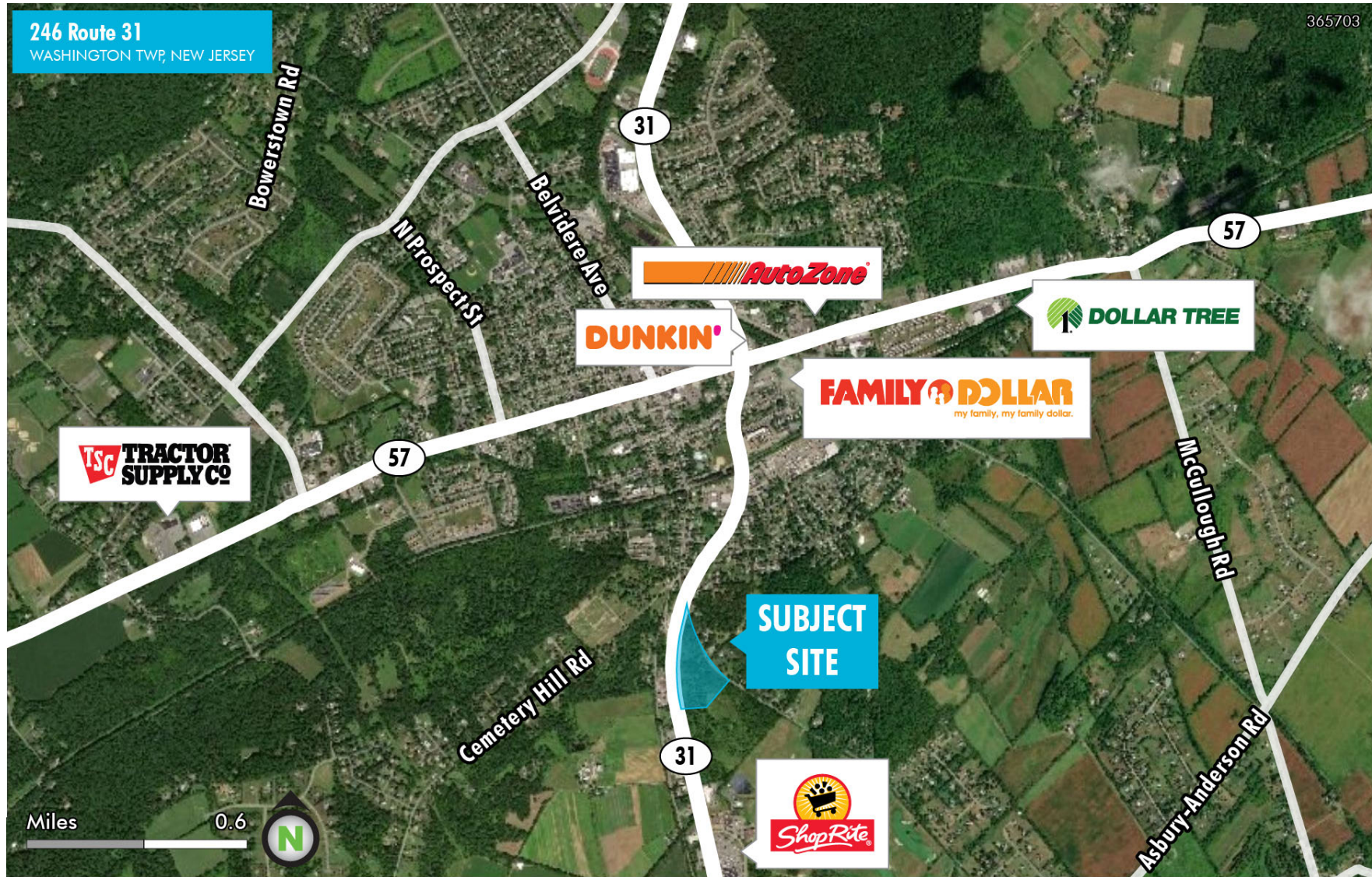



FOR SALE / LEASE

# 246 Route 31

WASHINGTON TOWNSHIP, NJ 07882

RETAIL

## CLOSE-IN AERIAL





FOR SALE / LEASE

# 246 Route 31

WASHINGTON TOWNSHIP, NJ 07882

RETAIL

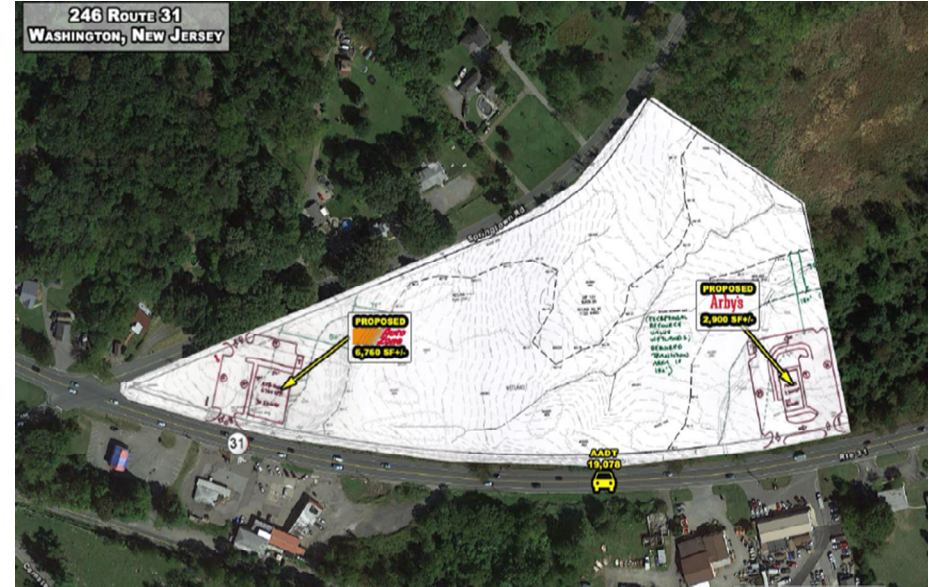

## CONTACT US

### PATTI FIORE-AMCANGELO

Vice President

+1 732 509 2835

+1 732 687 9725 (Cell)

patti.amcangelo@cbre.com

© 2019 CBRE, Inc. All rights reserved. This information has been obtained from sources believed reliable, but has not been verified for accuracy or completeness. You should conduct a careful, independent investigation of the property and verify all information. Any reliance on this information is solely at your own risk. CBRE and the CBRE logo are service marks of CBRE, Inc. All other marks displayed on this document are the property of their respective owners. Photos herein are the property of their respective owners. Use of these images without the express written consent of the owner is prohibited.

[www.cbre.us](http://www.cbre.us)

**CBRE**