



SOUTH BRUNSWICK TOWNSHIP, NJ

# Princeton Park 1100 Cornwall Road



## CALL TO FIND OUT WHY THIS IS THE BEST VALUE IN THE MARKET



- 176,000 SF Class A office building
- Granite exterior
- Ribbon glass window line
- Skylit 3-story atrium lobby
- Glass enclosed elevators
- Exterior balconies (floors 2 & 3)
- Strategically located off Route 1 and within minutes of Routes 18, 287, 130 & 27 and New Jersey Turnpike Exits 8A & 9 (I-95)
- 850 SF – 100,000 SF available
- Generous parking ratio of 5:1000 SF
- Amenities coming soon include: café, fitness center, conference/training center and co-working center

*For information, please contact:*

**Adam Silver**  
t 732-867-9555  
asilver@ngkf.com

**Rob Loderstedt**  
t 732-867-9557  
robert.loderstedt@ngkf.com

**NEWMARK**

201 Route 17 North, Rutherford, NJ 07070  
One Tower Center Boulevard, Suite 2201, East Brunswick, NJ 08816

[nmrk.com](http://nmrk.com)

The information contained herein has been obtained from sources deemed reliable but has not been verified and no guarantee, warranty or representation, either express or implied, is made with respect to such information. Terms of sale or lease and availability are subject to change or withdrawal without notice.



## MAP & FLOOR PLAN

# 1100 Cornwall Road

Map



Floor Plan – 3<sup>rd</sup> floor

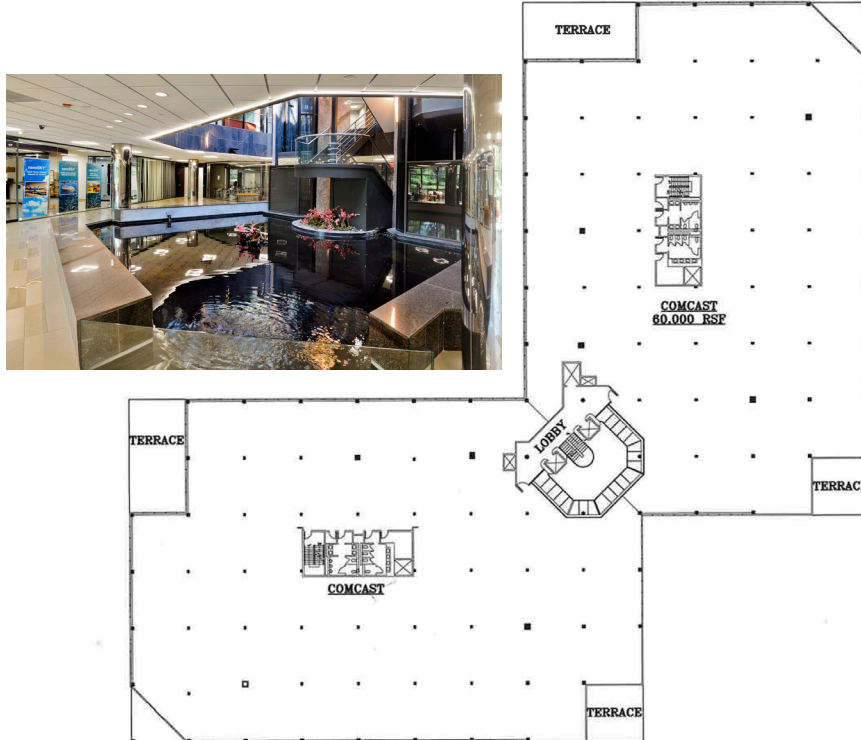

# NEWMARK

201 Route 17 North, Rutherford, NJ 07070  
One Tower Center Boulevard, Suite 2201, East Brunswick, NJ 08816

[nmrk.com](http://nmrk.com)

The information contained herein has been obtained from sources deemed reliable but has not been verified and no guarantee, warranty or representation, either express or implied, is made with respect to such information. Terms of sale or lease and availability are subject to change or withdrawal without notice.