

LINCOLN PARK CENTRE

Southeast Corner North Avenue and Halsted Street
Lincoln Park / Chicago



SPACE DETAILS

AVAILABILITY

4,051 Sq Ft & 5,988 Sq Ft Ground Floor space available at the base of a two-story retail building

Space A 4,051 Sq Ft (Formerly a portion Eddie Bauer)

Space B 5,988 Sq Ft (Currently Sur La Table)

PARKING

On-site dedicated parking

SITE SUMMARY

- Prominent position in dominant Clybourn Corridor retail center
- Immediately across the street from flagship Apple store with exceptional visibility & phenomenal retail co-tenancy at the intersection
- Over \$500M in retail sales in the trade area
- On-site dedicated parking structure with 150 spaces
- 1/2 block from CTA North & Clybourn Red Line Station with 2.128M riders annually (CTA-2016)

OVERALL SITE PLAN

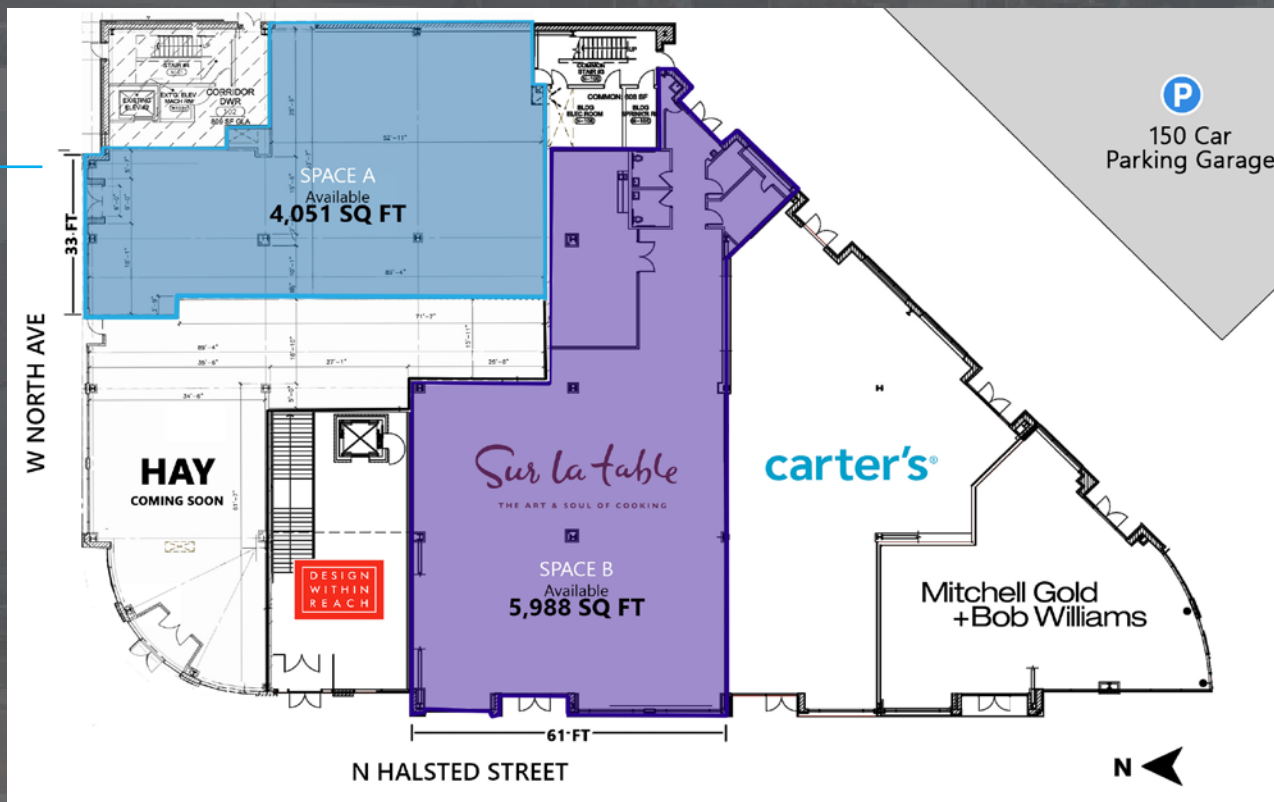

AREA RETAIL MAP



**755 W.
NORTH AVENUE**

francesca's
live
OLD NAVY
BLICK
art materials
modani
Pier 1 Imports

**NORTH AVENUE
COLLECTION**

**LINCOLN PARK
CENTRE**

**NEW CITY
LINCOLN PARK**



**CONTACT
EXCLUSIVE AGENTS**

Anthony Campagni
630.908.5695
ac@arcgrp.com

Elan Rasansky
630.908.5696
elan@arcgrp.com



A·R·C
REAL ESTATE

200 S. Wacker Dr., Suite 1325 Chicago, IL 60606 |
630.908.5700 | arcgrp.com

© 2018 A-R-C Real Estate. All information is from sources believed reliable, not independently verified, and thus subject to errors, omissions, and modifications such as price, listing, square footage, rates and commissions. All information, estimates and projections subject to change, market assumptions, unknown facts and conditions, and future potentialities. A-R-C Real Estate makes no express or implied representations or warranties, as facts and results may vary materially from all information, estimates and projections. All renderings presented are conceptual.