

# 4725 LIPAN STREET

Denver, CO 80211



## PROPERTY DESCRIPTION

Sublease through August 2025

Rate \$11.70 nnn through 8/31/24

Rate \$12.15 nnn through 8/31/25

## PROPERTY HIGHLIGHTS

- Ideally located near I-70 and Pecos
- Easy access to I-70 and I-25
- Paved Fenced Yard
- 2 dock high doors
- One office with open warehouse

## OFFERING SUMMARY

|               |                     |
|---------------|---------------------|
| Lease Rate:   | \$11.70 SF/yr (NNN) |
| Estimated NNN | \$5.30              |
| Available SF: | 3,465 SF            |



### BRANDI SPENCER

Senior Broker

720.880.6977

brandi@algcommercial.com

### ALG COMMERCIAL

7354 South Alton Way, Suite 101

algcommercial.com

The information above has been obtained from sources believed reliable. While we do not doubt its accuracy we have not verified it and make no guarantee, warranty or representation about it. It is your responsibility to independently confirm its accuracy and completeness. Any projections, opinions, assumptions, or estimates used are for example only and do not represent the current or future performance of the property. The value of this transaction to you depends on tax and other factors which should be evaluated by your tax, financial, and legal advisors. You and your advisors should conduct a careful, independent investigation of the property to determine to your satisfaction the suitability of the property for your needs.

# 4725 LIPAN STREET

Denver, CO 80211

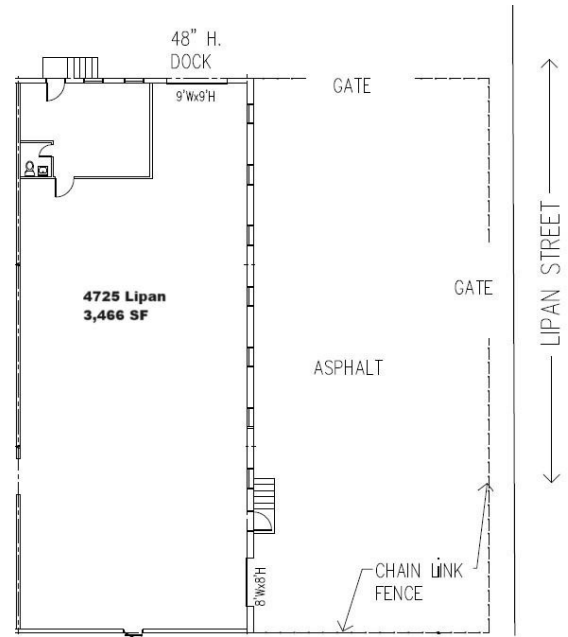

**BRANDI SPENCER**

Senior Broker  
720.880.6977  
brandi@algcommercial.com

**ALG COMMERCIAL**  
7354 South Alton Way, Suite 101  
algcommercial.com

The information above has been obtained from sources believed reliable. While we do not doubt its accuracy we have not verified it and make no guarantee, warranty or representation about it. It is your responsibility to independently confirm its accuracy and completeness. Any projections, opinions, assumptions, or estimates used are for example only and do not represent the current or future performance of the property. The value of this transaction to you depends on tax and other factors which should be evaluated by your tax, financial, and legal advisors. You and your advisors should conduct a careful, independent investigation of the property to determine to your satisfaction the suitability of the property for your needs.

# 4725 LIPAN STREET

Denver, CO 80211

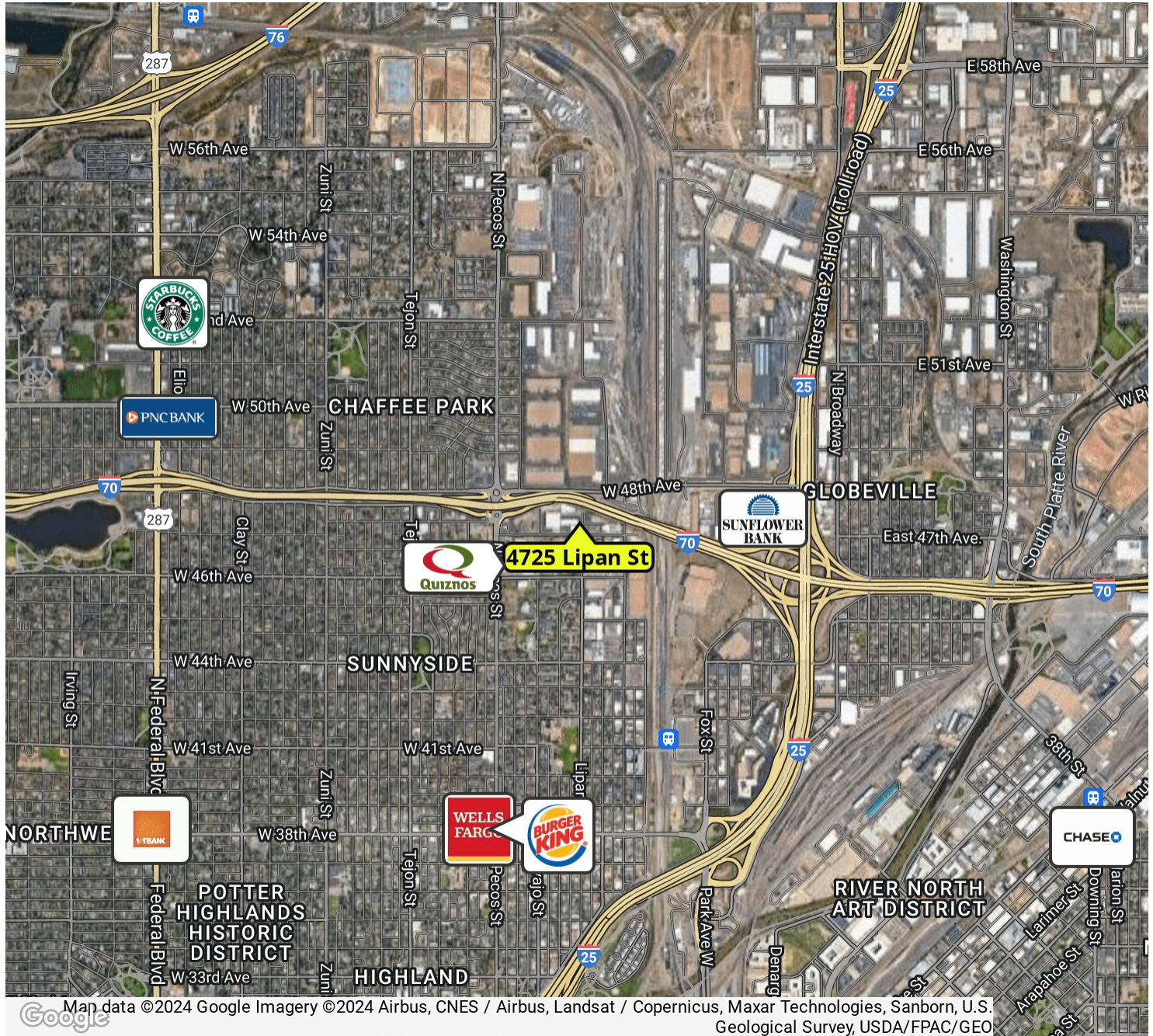

**BRANDI SPENCER**  
Senior Broker  
720.880.6977  
brandi@alcommercial.com

**ALG COMMERCIAL**  
7354 South Alton Way, Suite 101  
alcommercial.com

The information above has been obtained from sources believed reliable. While we do not doubt its accuracy we have not verified it and make no guarantee, warranty or representation about it. It is your responsibility to independently confirm its accuracy and completeness. Any projections, opinions, assumptions, or estimates used are for example only and do not represent the current or future performance of the property. The value of this transaction to you depends on tax and other factors which should be evaluated by your tax, financial, and legal advisors. You and your advisors should conduct a careful, independent investigation of the property to determine to your satisfaction the suitability of the property for your needs.

# 4725 LIPAN STREET

Denver, CO 80211

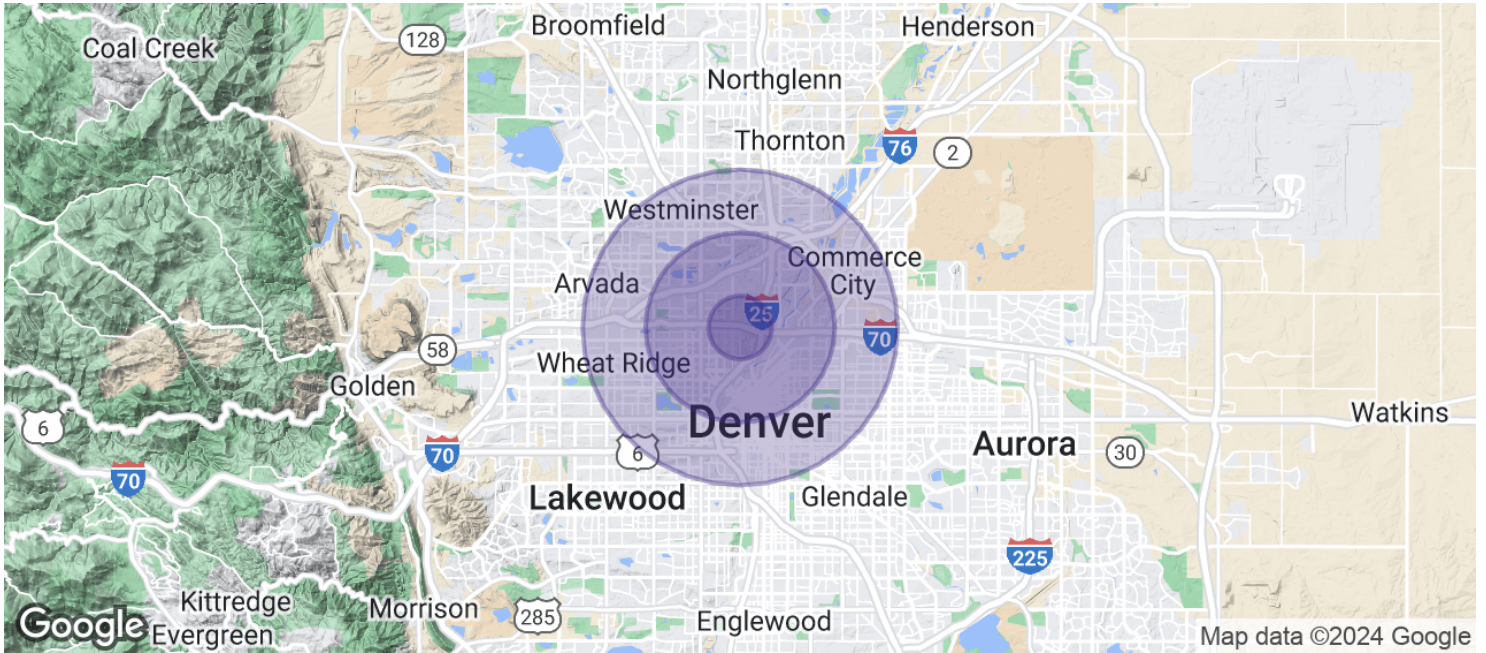

## POPULATION

|                      | 1 MILE | 3 MILES | 5 MILES |
|----------------------|--------|---------|---------|
| Total Population     | 13,120 | 152,219 | 429,801 |
| Average Age          | 37     | 37      | 38      |
| Average Age (Male)   | 36     | 37      | 38      |
| Average Age (Female) | 37     | 37      | 38      |

## HOUSEHOLDS & INCOME

|                     | 1 MILE    | 3 MILES   | 5 MILES   |
|---------------------|-----------|-----------|-----------|
| Total Households    | 5,058     | 74,005    | 201,197   |
| # of Persons per HH | 2.6       | 2.1       | 2.1       |
| Average HH Income   | \$116,373 | \$132,712 | \$115,895 |
| Average House Value | \$700,213 | \$779,487 | \$717,326 |

Demographics data derived from AlphaMap



### BRANDI SPENCER

Senior Broker  
720.880.6977  
brandi@algcommercial.com

### ALG COMMERCIAL

7354 South Alton Way, Suite 101  
algcommercial.com

The information above has been obtained from sources believed reliable. While we do not doubt its accuracy we have not verified it and make no guarantee, warranty or representation about it. It is your responsibility to independently confirm its accuracy and completeness. Any projections, opinions, assumptions, or estimates used are for example only and do not represent the current or future performance of the property. The value of this transaction to you depends on tax and other factors which should be evaluated by your tax, financial, and legal advisors. You and your advisors should conduct a careful, independent investigation of the property to determine to your satisfaction the suitability of the property for your needs.