

2640 CORPORATE PARKWAY | ALGONQUIN

FOR LEASE

professionally managed & owned by



HIGHLIGHTS

- › Located in Algonquin Corporate Park
- › Shopping & dining at the Algonquin Commons
- › Fully sprinkled
- › Internet service provided by Comcast & AT&T
- › Convenient access to interstate 90 via Randall Road
- › 35 minutes to O'Hare

AVAILABLE

- › Unit 2650 6,355 SF (total)
 1,465 SF (office)
- › Unit 2652 5,420 SF (total)
 1,285 SF (office)

BUILDING SPECIFICATIONS

- › Total Building: **40,375 SF**
- › Ceiling Height: **21' - Stacking 18'**
- › Parking: **80 free surface**
- › Sprinkler: **Class III**

PRICING

- › Lease Price: **\$6.95 Net PSF**
- › Taxes: **\$1.52 PSF**
 (2019 payable in 2020)
- › CAM: **\$0.95 PSF**
 (2019 payable in 2020)

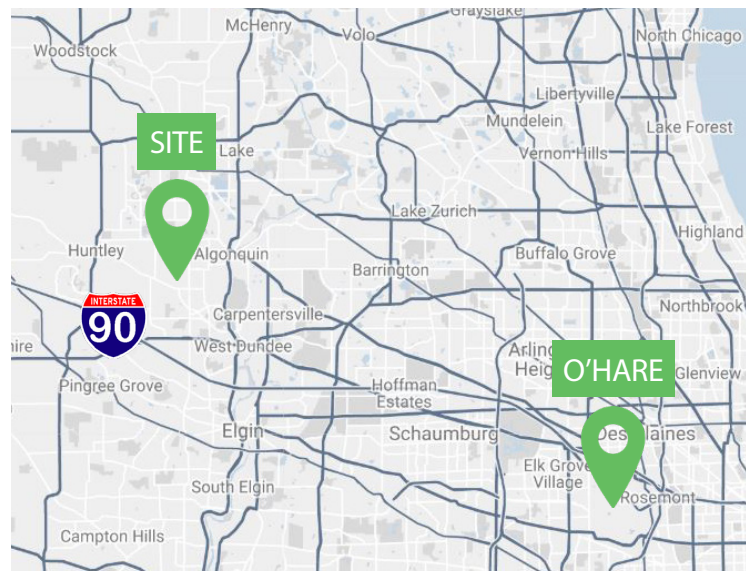

MATT GARLAND
630.729.7945
mgarland@cawleychicago.com

RAWLY LANTZ
630.729.7944
rlantz@cawleychicago.com



2640 CORPORATE PARKWAY | ALGONQUIN

UNIT 2650 | 6,355 SF

professionally managed & owned by

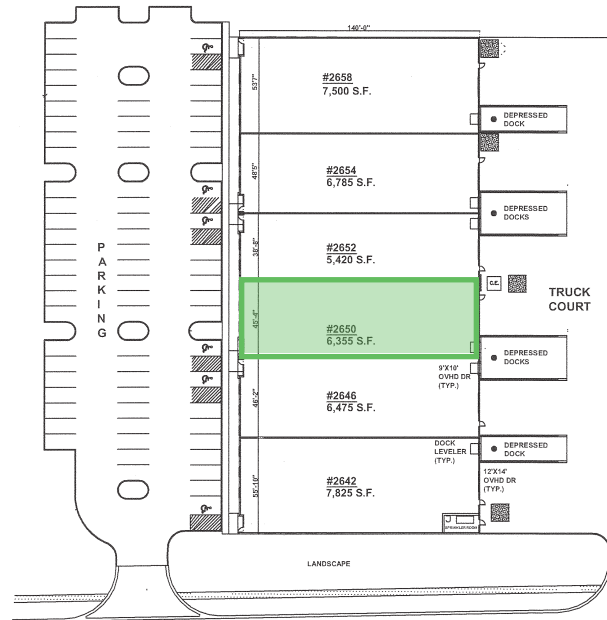
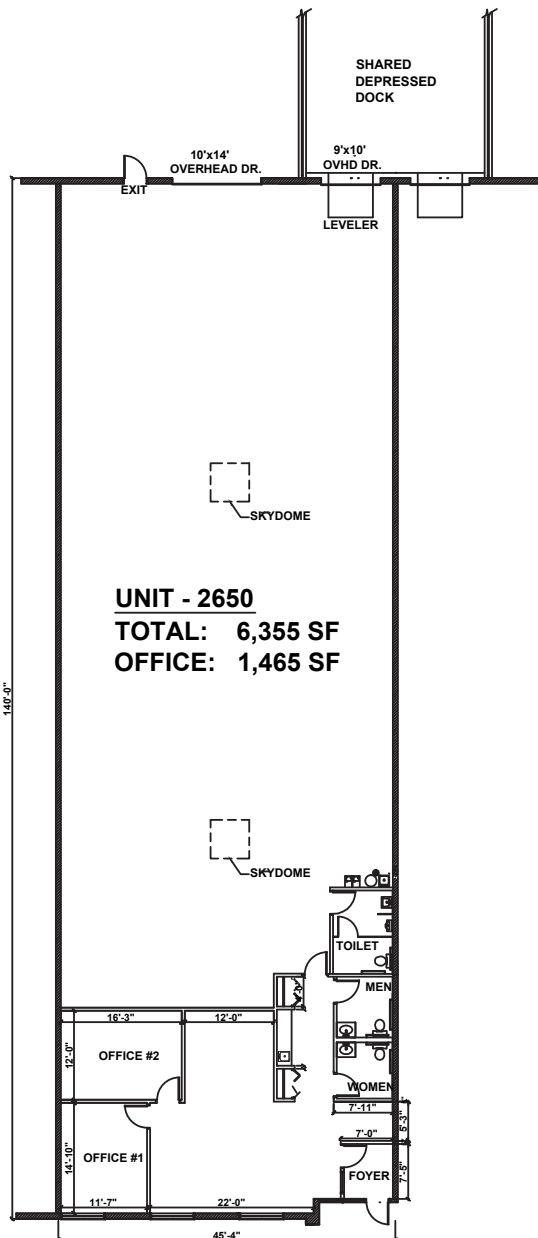

MATT GARLAND
630.729.7945
mgarland@cawleychicago.com

RAWLY LANTZ
630.729.7944
rlantz@cawleychicago.com





2640 CORPORATE PARKWAY | ALGONQUIN

UNIT 2652 | 5,420 SF

professionally managed & owned by

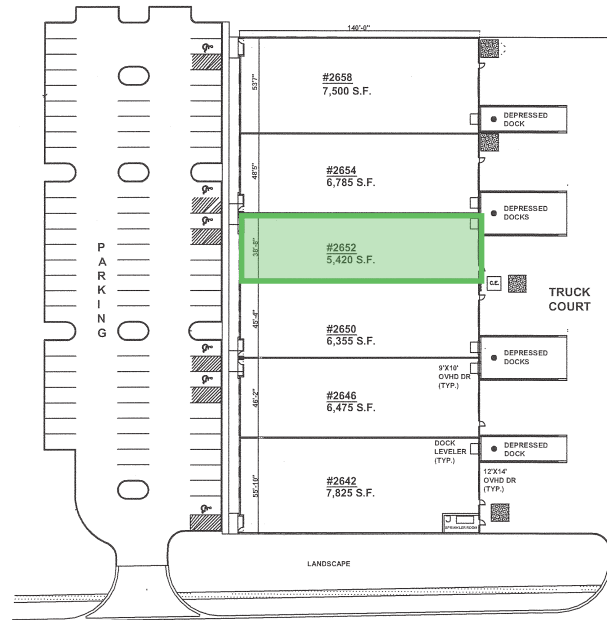
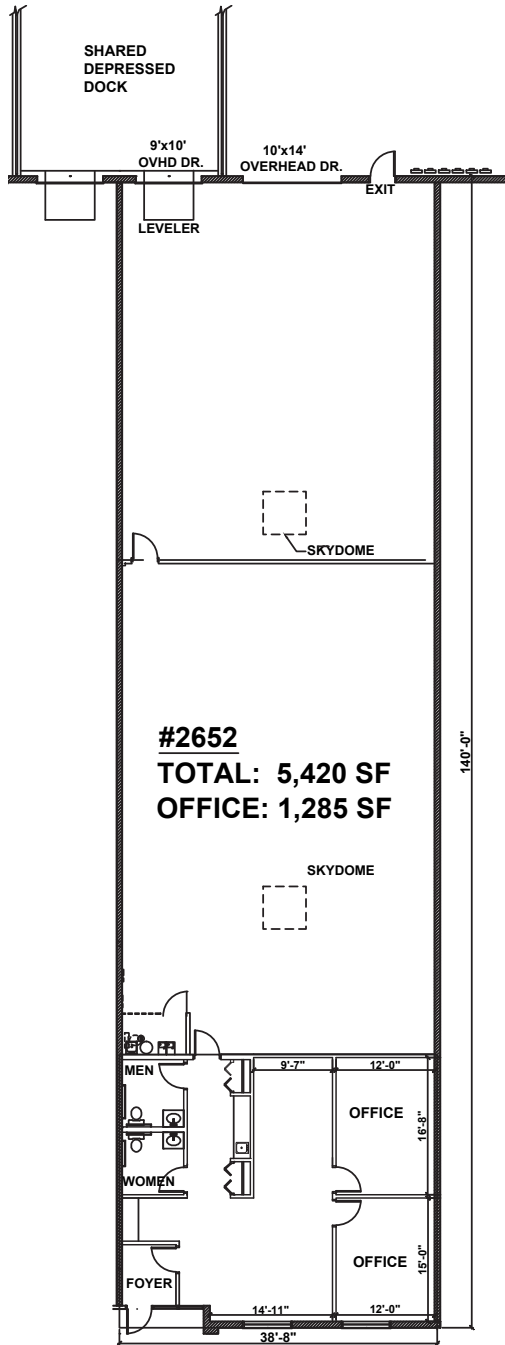

MATT GARLAND
630.729.7945
mgarland@cawleychicago.com

RAWLY LANTZ
630.729.7944
rlantz@cawleychicago.com

