

# SKY HARBOR Business Park

1809 W. 4th St | Tempe, AZ



## Property Features

- ± 9,754 SF Freestanding Industrial Building
- Office Area: ± 2,439 SF
- NNN Expenses estimated at \$0.20
- Includes: Reception Area, 7 Offices, Conference Room, Bull Pen, Break Room and 2 Restrooms
- Two 12' Overhead Doors, 16' Clear Height
- Grade Level and Truckwell Loading
- Zoned GID, City of Tempe
- Minutes from Sky Harbor International Airport, ASU & Multiple Retail Amenities
- Less Than 1 mile from Loop 202 & SR-143

John G. Soldo, SIOR  
480.966.1304 (D)  
602.989.4584 (M)  
jsoldo@cpiaz.com

Darin Edwards  
480.214.1117 (D)  
480.628.8661 (M)  
dedwards@cpiaz.com

Leroy Breinholt  
480.966.6593 (D)  
602.377.4687 (M)  
lbreinholt@cpiaz.com



TEMPE: 2323 W. University Drive, Tempe, AZ 85281 | 480.966.2301  
SCOTTSDALE: 8777 N. Gainey Center Dr., Suite 245, Scottsdale, AZ 85258 | www.cpiaz.com

# SKY HARBOR Business Park

1809 W. 4th St | Tempe, AZ

*Freestanding Industrial Building for Lease*  
*Small Fenced Yard*

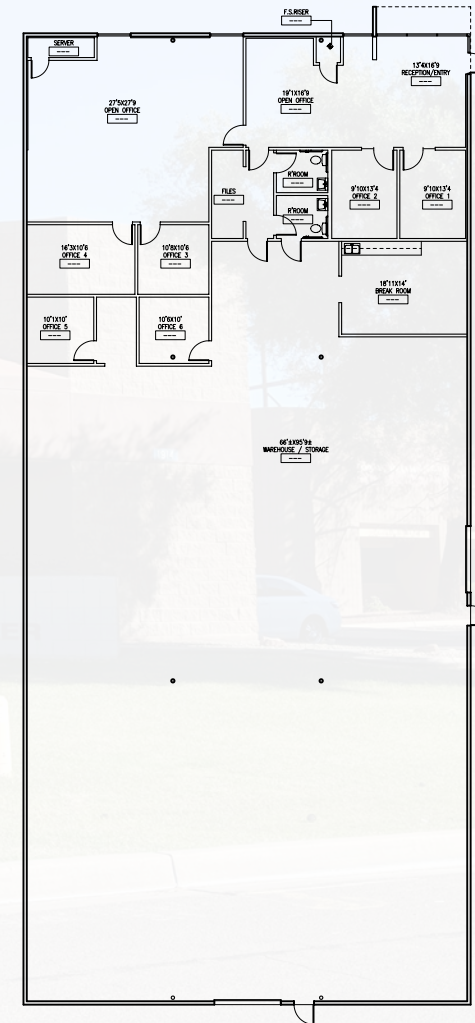
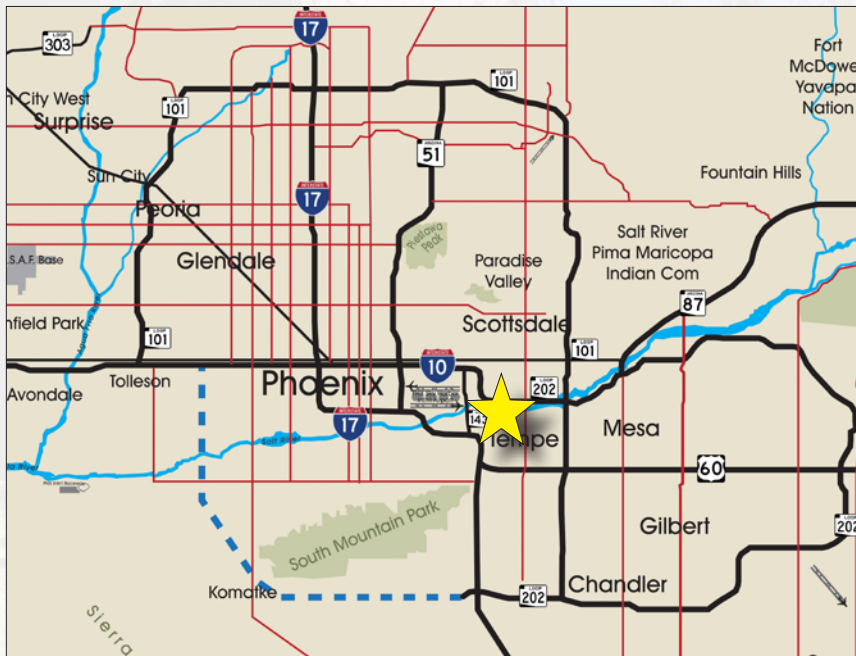

John G. Soldo, SIOR  
480.966.1304 (D)  
602.989.4584 (M)  
jsoldo@cpiaz.com

Darin Edwards  
480.214.1117 (D)  
480.628.8661 (M)  
dedwards@cpiaz.com

Leroy Breinholt  
480.966.6593 (D)  
602.377.4687 (M)  
lbreinholt@cpiaz.com



TEMPE: 2323 W. University Drive, Tempe, AZ 85281 | 480.966.2301  
SCOTTSDALE: 8777 N. Gainey Center Dr., Suite 245, Scottsdale, AZ 85258 | www.cpiac.com

The information contained herein has been obtained from various sources. We have no reason to doubt its accuracy; however, J & J Commercial Properties, Inc. has not verified such information and makes no guarantee, warranty or representation about such information. The prospective buyer or lessee should independently verify all dimensions, specifications, floor plans, and all information prior to the lease or purchase of the property. All offerings are subject to prior sale, lease, or withdrawal from the market without prior notice. Effective 10/25/18