

SPACE AVAILABLE



## 640 Rice Boulevard

12,000+/- sq ft Available | [Competitive Terms](#)

Eagleview<sup>SM</sup> is an exceptional place to do business. Located only 3/4 mile from the PA Turnpike, 640 Rice Boulevard is a 24,000 square foot building, designed for office, professional or retail uses.

640 Rice Boulevard is conveniently located near Eagleview Town Center's numerous amenities. Eagleview Town Center, home of Restaurant Row, features amenities such as al fresco dining, an award-winning bookstore, fitness centers, a daycare, walking trails, a farmers market & more! Ample parking welcomes employees and visitors, and nearby shops and services create a work environment that is both efficient and enjoyable.

### EAGLEVIEW<sup>SM</sup>

#### BUILDING FEATURES

- Contemporary brick & glass exterior
- 100 parking spaces (4/1,000 sq ft)
- 16' clear height
- Excellent visibility from Rice Blvd & Stockton Drive at the corner of Eagleview Town Center
- 24/7 property management
- Monument signage available



610.458.1900  
[HankinGroup.com](http://HankinGroup.com)

**SPACE AVAILABLE**

# 640 Rice Boulevard

**EAGLEVIEW<sup>SM</sup>**

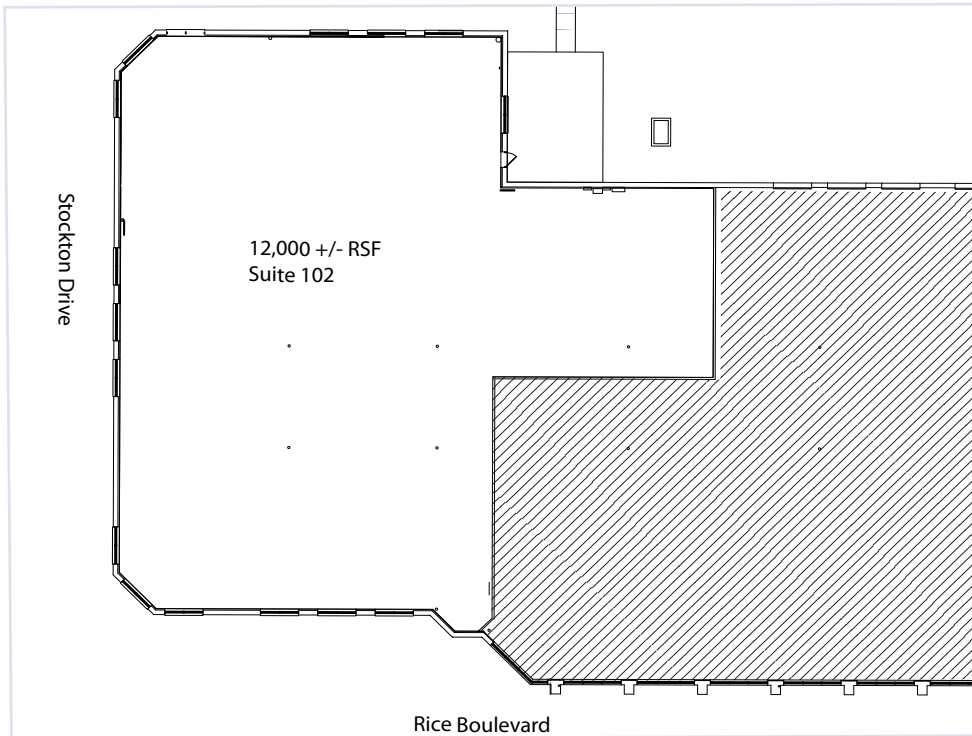

To schedule a tour or for more information, please contact:

**STACY MARTIN**  
stacy.martin@hankingroup.com

**SAM SHERRILL**  
sam.sherrill@hankingroup.com

**Hankin Group**  
707 Eagleview Blvd  
Exton, PA 19341  
HankinGroup.com

P 610.458.1900  
F 610.458.0764



## FROM PHILADELPHIA

Take Rt. 76 West to the PA Turnpike. Take the PA Turnpike West to exit 312. Follow Rt. 100 North to the first traffic light. Stay to the right and follow the jughandle to cross over Rt. 100 onto Eagleview Blvd. Make a turn at the second left and come to 505 Eagleview Blvd.

## FROM WILMINGTON

Take Rt. 202 North to Rt. 100 North. When you have passed the PA Turnpike entrance you will come to a traffic light. Stay to your right and follow the jughandle to cross over Rt. 100 onto Eagleview Blvd. Make a turn at the second left and come to 505 Eagleview Blvd.



610.458.1900  
HankinGroup.com

**DISTINCTIVE COMMERCIAL PROPERTIES**

4.2.2019