

2238 West Lone Cactus Drive

Phoenix, AZ



FOR SALE

An ±8,000 SF Freestanding Building with Heavy Power, 3:1,000 Parking

Mike Ciosek, SIOR
602.513.5135
mciosek@kiddermathews.com

Eric Bell, SIOR
602.513.5151
ebell@kiddermathews.com

Dylan Scott
602.513.5104
dscott@kiddermathews.com

kiddermathews.com



2238 West Lone Cactus Drive

Phoenix, AZ

Features

AVAILABLE ±8,000 total building SF; ±32,757 SF lot

PARKING ±24 parking spaces; Lot resealed in 2017

CLEAR HEIGHT 16'

LOADING Two (2) 10'x12' grade level doors

POWER 800 amps, 120/208 volt, 3-phase

AC Five (5) new AC units in 2016

ROOF New foam roof in 2016

ZONING Industrial Park, City of Phoenix

YEAR BUILT 1997

ASKING PRICE \$990,000



Mike Ciosek, SIOR
602.513.5135
mciosek@kiddermathews.com

Eric Bell, SIOR
602.513.5151
ebell@kiddermathews.com

Dylan Scott
602.513.5104
dscott@kiddermathews.com

kiddermathews.com

km Kidder Mathews

This information supplied herein is from sources we deem reliable. It is provided without any representation, warranty or guarantee, expressed or implied as to its accuracy. Prospective Buyer or Tenant should conduct an independent investigation and verification of all matters deemed to be material, including, but not limited to, statements of income and expenses. Consult your attorney, accountant, or other professional advisor.

2238 West Lone Cactus Drive

Phoenix, AZ

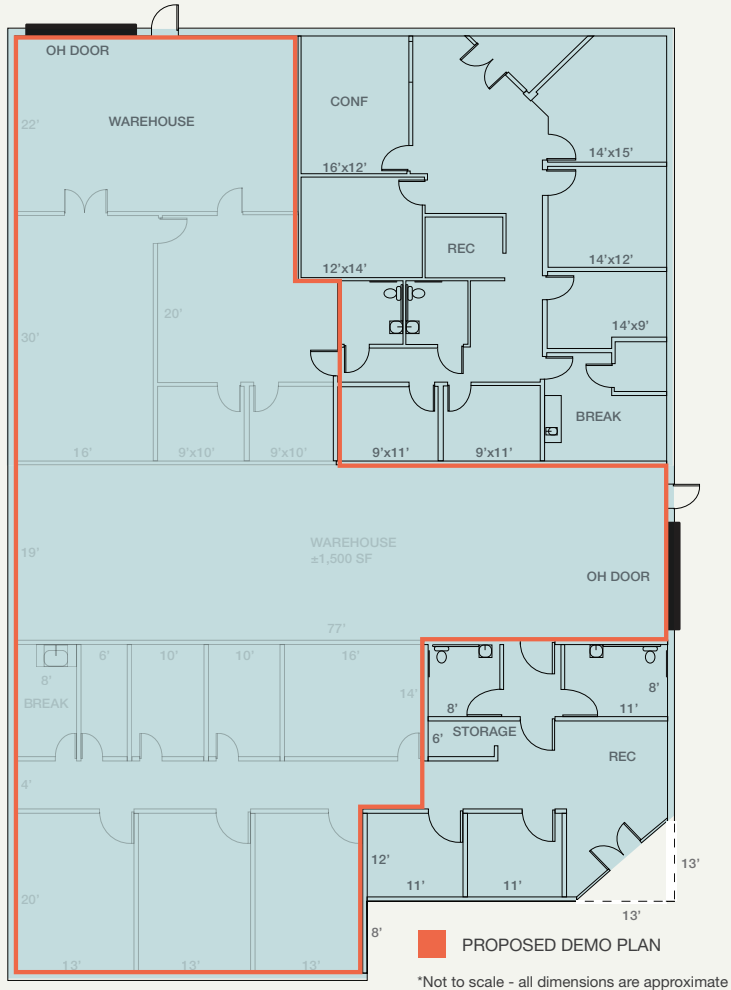

Mike Ciosek, SIOR
602.513.5135
mciosek@kiddermathews.com

Eric Bell, SIOR
602.513.5151
ebell@kiddermathews.com

Dylan Scott
602.513.5104
dscott@kiddermathews.com

kiddermathews.com

km Kidder Mathews

This information supplied herein is from sources we deem reliable. It is provided without any representation, warranty or guarantee, expressed or implied as to its accuracy. Prospective Buyer or Tenant should conduct an independent investigation and verification of all matters deemed to be material, including, but not limited to, statements of income and expenses. Consult your attorney, accountant, or other professional advisor.