

**LEGEND**

- COMMON AREA
- RENTAL SPACE
- AMTRAK PREMISES
- COMMON AREA THAT MAY SWITCH TO RENTAL SPACE

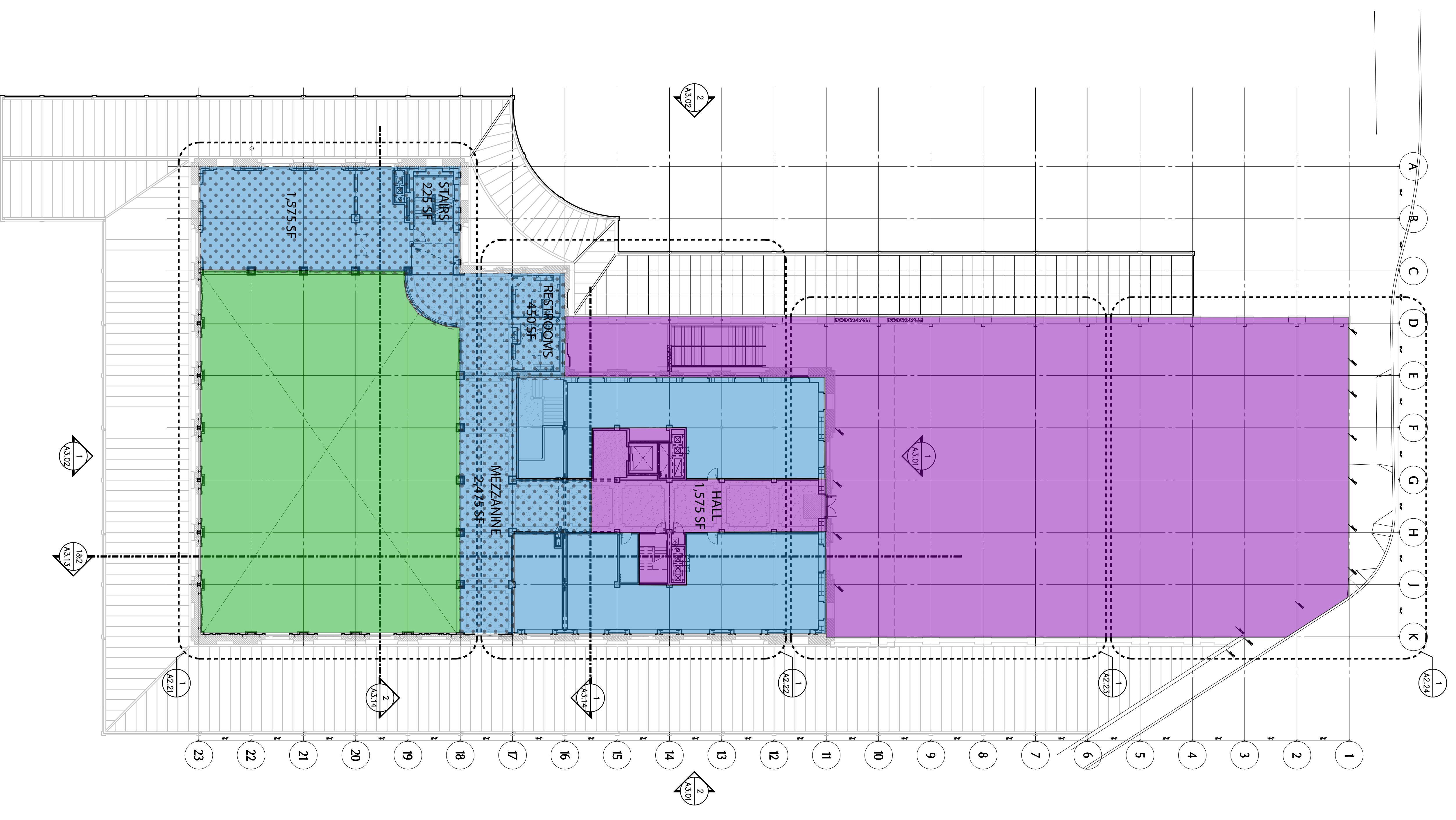

**1** OVERALL FLOOR PLAN - LEVEL 2  
 A2.20 SCALE: 1/8" = 1'-0"

**ZGF**  
 ZAHNER GINSBURG ARCHITECTS LP  
 PORTLAND  
 SEATTLE  
 LOS ANGELES  
 NEW YORK  
 925 Fourth Ave., Suite 2400  
 Seattle, Washington 98104  
 (206) 266-6234  
 (206) 266-6234

**Consultants**

- STRUCTURAL ENGINEER  
 ARUP  
 403 COLUMBIA STREET, SUITE 220  
 SEATTLE, WA 98104
- MECHANICAL ENGINEER  
 ARUP  
 403 COLUMBIA STREET, SUITE 220  
 SEATTLE, WA 98104
- ELECTRICAL ENGINEER  
 ARUP  
 403 COLUMBIA STREET, SUITE 220  
 SEATTLE, WA 98104
- CIVIL ENGINEER  
 KFF  
 601 FIFTH AVENUE, SUITE 1600  
 SEATTLE, WA 98101
- LIGHTING CONSULTANT  
 PIVOYAL CONSULTING, INC  
 1401 FIFTH AVENUE, SUITE 1400  
 SEATTLE, WA 98101

**Revision**

01/27/10	PERMIT ISSUE
----------	--------------

**KING STREET  
 STATION  
 REHABILITATION  
 PHASE - 2**

City of Seattle  
 SEATTLE DEPARTMENT  
 OF TRANSPORTATION

Drawing Title  
**OVERALL FLOOR  
 PLAN - LEVEL 2**

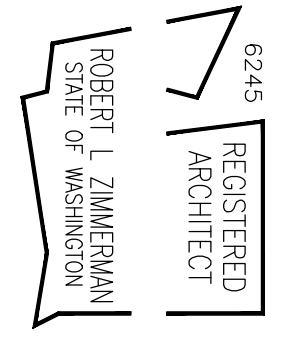

Date: **JANUARY 27, 2010**  
 Job No: **990700.01**  
 Drawn By:  
 Checked By:  
 Drawing No:

**A2.20**  
**PERMIT ISSUE**