

MEDICAL / PROFESSIONAL OFFICE FOR LEASE

901 Hampton Boulevard, Norfolk, VA
GHENT



- ± 2,155 SF available for lease on 2nd floor
- Zoned C2 - "Corridor Commercial" (office, retail, medical office, restaurant - no alcohol)
- Short Walk to Regional Medical:
 - ◆ Sentara Norfolk General
 - ◆ Eastern VA Medical School (EVMS)
 - ◆ Children's Hospital of the King's Daughters (CHKD)
- Short Walk to emerging Chelsea area:
 - ◆ Smartmouth Brewing Co.
 - ◆ Torch Bistro
 - ◆ Tortilla West
 - ◆ The Bakehouse
- 37,315 VPD traffic count
- Lease Price: \$15.75 psf (full service, net of janitorial)
- 42 on-site parking spaces with 2 elevators
- Lease Term: Negotiable

Same side of thoroughfare as Chelsea & two breweries

CONTACT:

TRICIA KING

(757) 640-8229

triciaking@harveylindsay.com

KIMBERLY DEAL

(757) 640-8242

kimberlydeal@harveylindsay.com

HARVEY LINDSAY

COMMERCIAL REAL ESTATE

A Tradition of Forward Thinking

999 Waterside Drive ■ Suite 1400 ■ Norfolk, Virginia 23510 ■ 757.640.8700 ■ www.harveylindsay.com

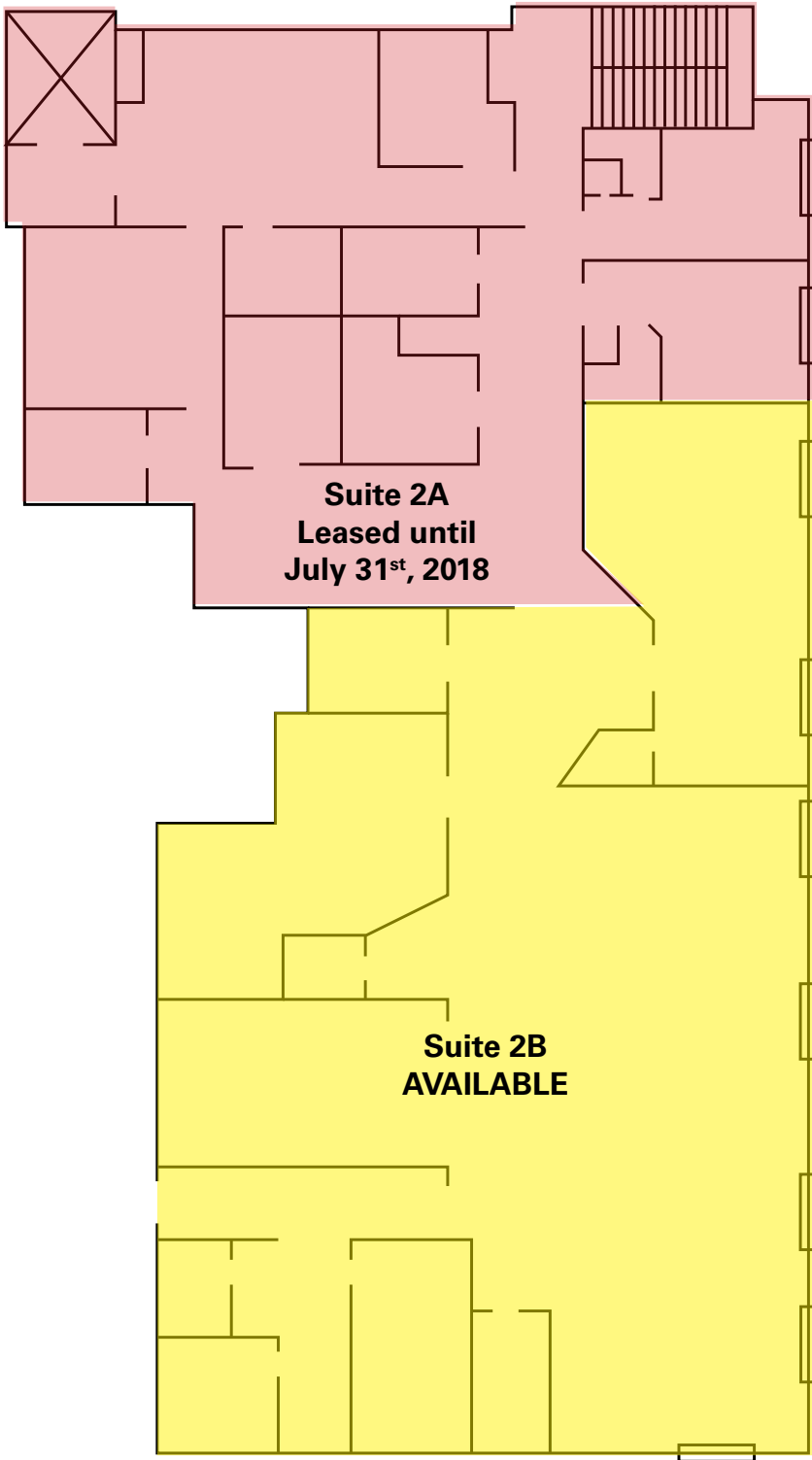

**Second Floor
Floor Plan**

**Available For
Lease
± 2,155 SF**

CONTACT:

TRICIA KING

(757) 640-8229

triciaking@harveylindsay.com

KIMBERLY DEAL

(757) 640-8242

kimberlydeal@harveylindsay.com

HARVEY LINDSAY

COMMERCIAL REAL ESTATE

A Tradition of Forward Thinking

The information contained herein has been obtained from sources believed to be reliable but is not warranted.

We cannot be responsible for errors, omissions, withdrawal, or prior lease or sale.

MEDICAL / PROFESSIONAL OFFICE FOR LEASE - 901 Hampton Boulevard, Norfolk, VA



CONTACT:
TRICIA KING
(757) 640-8229
triciaking@harveylindsay.com

KIMBERLY DEAL
(757) 640-8242
kimberlydeal@harveylindsay.com

HARVEY LINDSAY
COMMERCIAL REAL ESTATE
A Tradition of Forward Thinking

The information contained herein has been obtained from sources believed to be reliable but is not warranted.
We cannot be responsible for errors, omissions, withdrawal, or prior lease or sale.