

SOUTHPOINTE PROFESSIONAL PARK - BUILDING 2

8920 Southpointe Drive, Indianapolis IN 46227



FOR LEASE

Office/Medical Space on Indianapolis' South Side

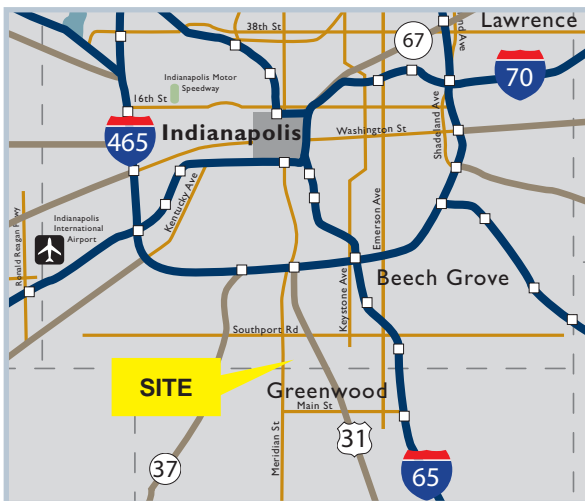

Property Highlights:

- Three (3) suites for lease (*6,448 SF contiguous):
 - Suite E-2: 2,636 SF
 - Suite D-2: 2,927 SF*
 - Suite D-1: 3,521 SF*
- Adjacent to Community Hospital South
- Easy access from I-65 & I-465
- Abundant parking

For more information, please contact:

Jeffrey E. Merritt
jmerritt@SummitRealtyGroup.com
317.713.2122

Timothy W. Norton, SIOR
tnorton@SummitRealtyGroup.com
317.713.2136

FLOOR PLAN

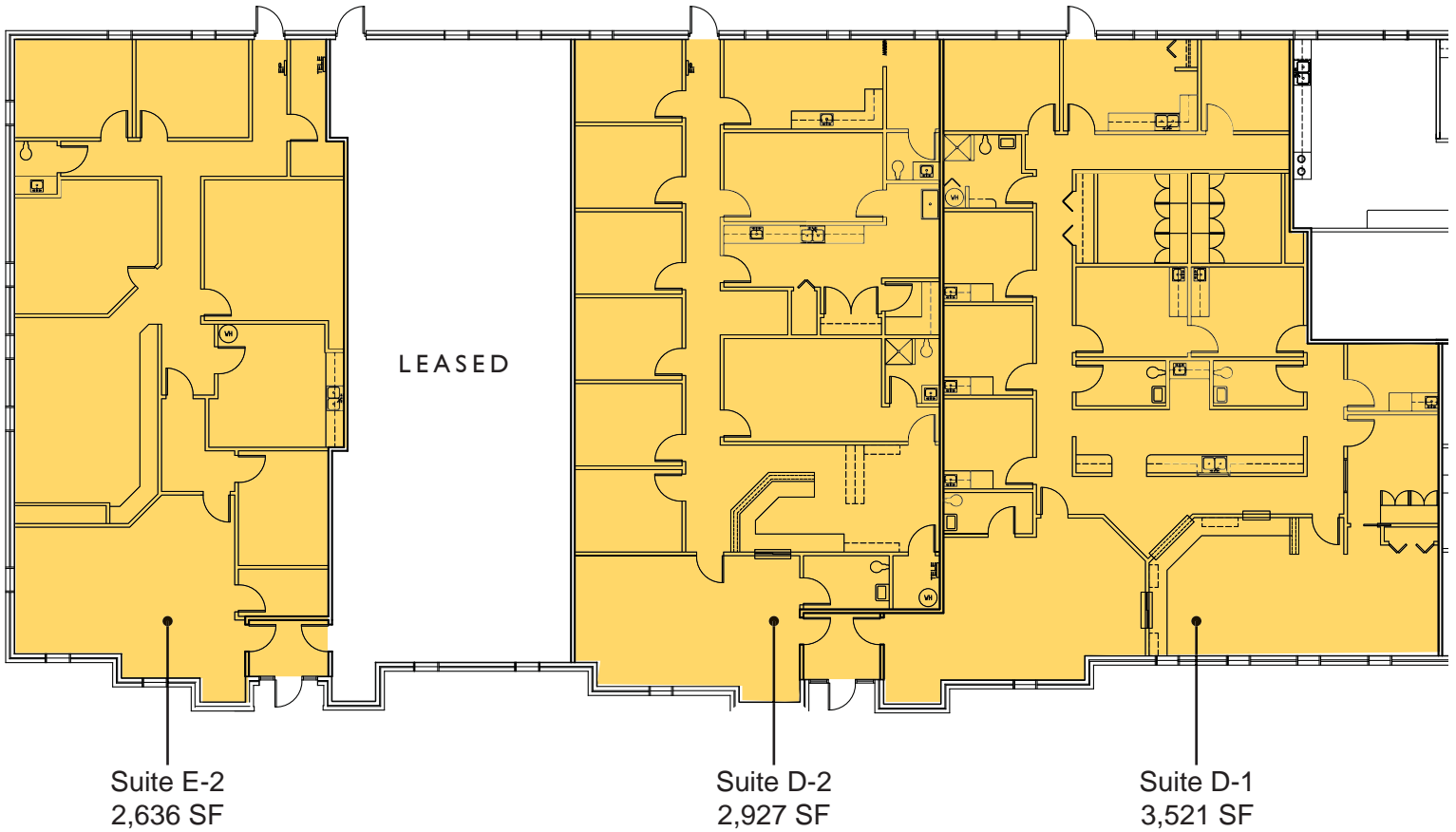

SUITE	TOTAL SF	COMMENTS
E-2	2,636	6 offices, lounge area, 2 restrooms and reception area
D-2*	2,927	Built-out medical space with 6 exam rooms, 2 procedure rooms, 3 restrooms, storage room and large reception area
D-1*	3,521	Built-out medical space, 4 offices, 5 exam rooms, 2 procedure rooms, 2 consultation rooms, lab area, lounge area, reception area, and 4 restrooms

*Contiguous Suites: 6,448 SF

Jeffrey E. Merritt

317.713.2122

Timothy W. Norton, SIOR

317.713.2136

No warranty or representation, express or implied, is made as to the accuracy of the information contained herein, and same is submitted subject to errors omissions, change of price, rental or other conditions, withdrawal without notice, and to any specific listing conditions, imposed by our principals.