

Tukwila Commerce Park

12610 Interurban Ave S
Building D
Seattle, WA

12,000 SF total

1,685 SF office

24' clear height

4 DH / 1 drive-in

Excellent access to I-5
and SR-599

Lease rate:

\$0.75 shell

\$0.95 office add-on

\$0.243, NNN

Available August 1, 2017



Location



Contact

Matt Wood, SIOR

206.248.7306

mwood@kiddermathews.com

Jim Kidder, SIOR

206.248.7328

jkidder@kiddermathews.com

Tukwila Commerce Park, Building D

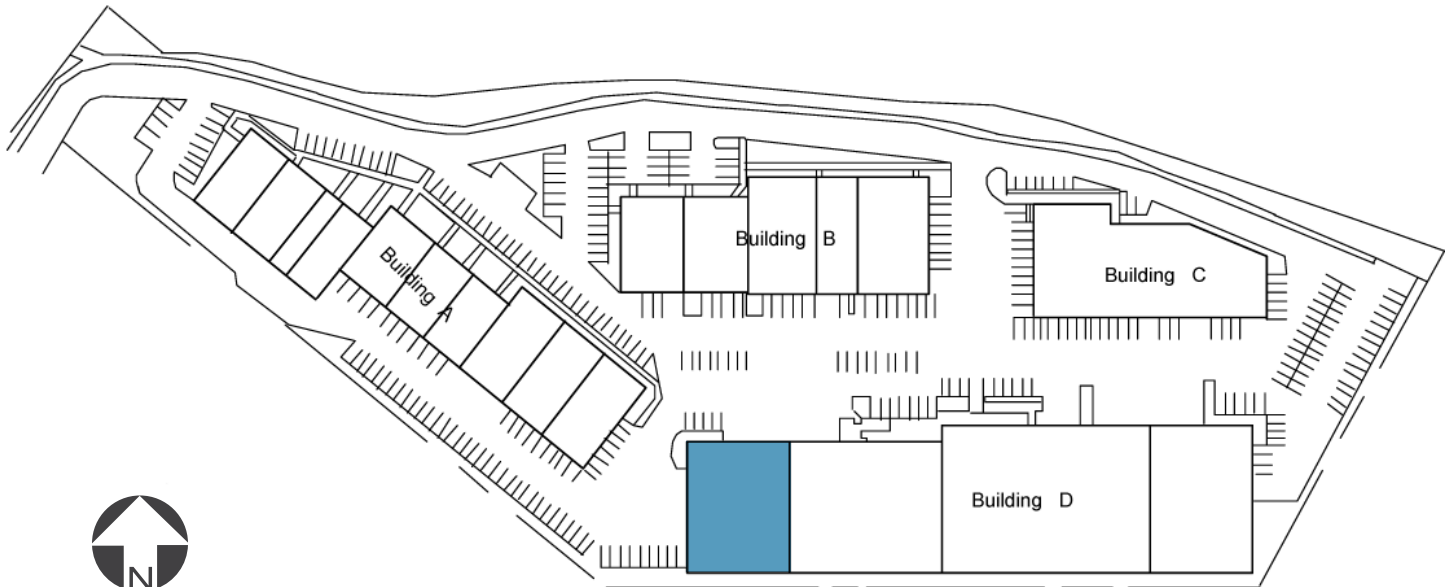

Contact

Matt Wood, SIOR

206.248.7306

mwood@kiddermathews.com

Jim Kidder, SIOR

206.248.7328

jkidder@kiddermathews.com

Tukwila Commerce Park, Building D

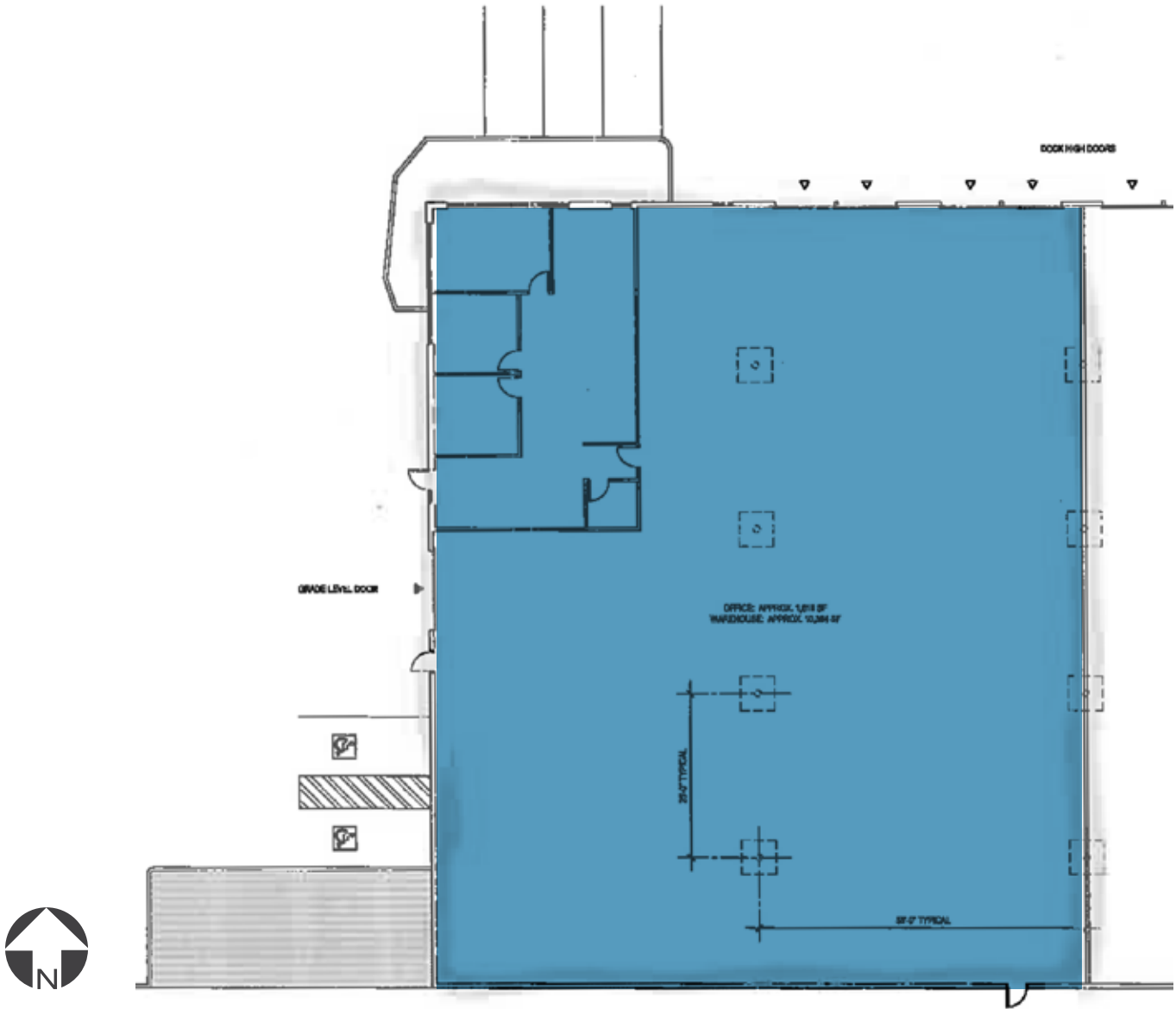

Contact

Matt Wood, SIOR
206.248.7306
mwood@kiddermathews.com

Jim Kidder, SIOR
206.248.7328
jkidder@kiddermathews.com