

FOR LEASE



PROPERTY DETAILS

General Use: Retail / Office

Available: Suite 2300 | 4,068 SF

Lease Rate: Contact Agent

Est. 2020 Operating Expenses: \$7.84 PSF

PROPERTY FEATURES

- Easily accessible neighborhood center located in the heart of south Des Moines' retail trade area
- Visibility on SE 14th Street, which has traffic of nearly 30,000 VPD
- Strong, professional co-tenants

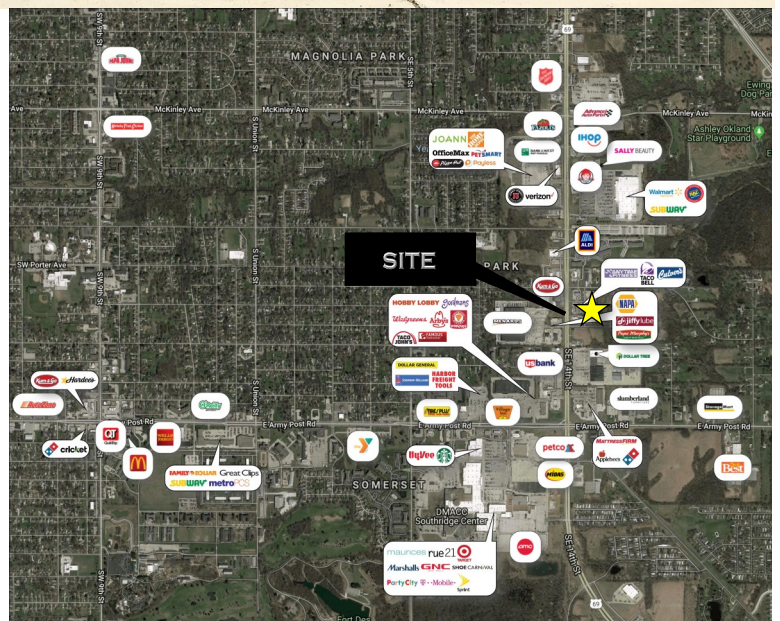

For more information please contact:

Ben Brackett | 515.556.4596
ben@fergusoncres.com

Michael Shindler | 515.720.3492
michael@fergusoncres.com

Mitch Phillips | 515.975.8225
mitch@fergusoncres.com

Brokerage

Property Management

Consulting

Development

Address | 1840 NW 118th St, Suite 100, Clive, IA 50325 Office | 515.440.0400 Website | www.fergusoncres.com

The above information has been obtained from the property owner or other sources that we deem reliable. Although we have no reason to doubt its accuracy or completeness, no representation or warranty is made regarding the property. This property is offered "as is". This submission may be modified or withdrawn at any time by the property owner or listing agent.

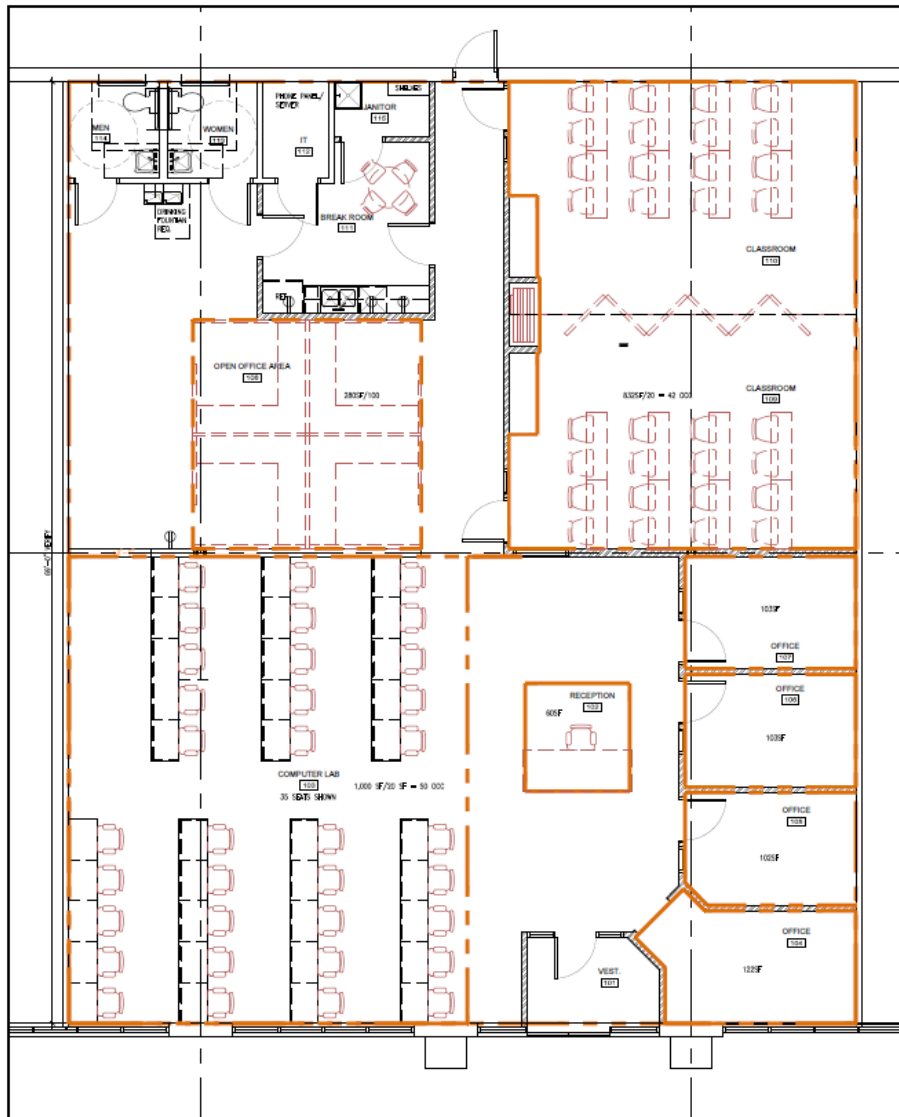

Sexton Chiropractic	Armed Forces Career Center	Anytime Fitness	TSA	Southside Dental	B 2 B Salon	Physiotherapy Associates	Suite 2300 4,068 SF Available	Radiant Complexions
---------------------	----------------------------	-----------------	-----	------------------	-------------	--------------------------	----------------------------------	---------------------

For more information please contact:

Ben Brackett | 515.556.4596
ben@fergusoncres.com

Michael Shindler | 515.720.3492
michael@fergusoncres.com

Mitch Phillips | 515.975.8225
mitch@fergusoncres.com

Brokerage

Property Management

Consulting

Development

Address | 1840 NW 118th St, Suite 100, Clive, IA 50325 **Office** | 515.440.0400 **Website** | www.fergusoncres.com

The above information has been obtained from the property owner or other sources that we deem reliable. Although we have no reason to doubt its accuracy or completeness, no representation or warranty is made regarding the property. This property is offered "as is". This submission may be modified or withdrawn at any time by the property owner or listing agent.



Demographics	<u>1 Mile</u>	<u>3 Miles</u>	<u>5 Miles</u>
Population	8,294	63,244	106,493
Average HH Income	\$63,488	\$66,815	\$67,722
Businesses/Employees	283 / 3,708	1,146 / 14,195	4,466 / 116,625
Traffic Count: SE 14th St	28,300 VPD		

For more information please contact:

Ben Brackett | 515.556.4596
ben@fergusoncres.com

Michael Shindler | 515.720.3492
michael@fergusoncres.com

Mitch Phillips | 515.975.8225
mitch@fergusoncres.com

Brokerage

Property Management

Consulting

Development

Address | 1840 NW 118th St, Suite 100, Clive, IA 50325 **Office** | 515.440.0400 **Website** | www.fergusoncres.com

The above information has been obtained from the property owner or other sources that we deem reliable. Although we have no reason to doubt its accuracy or completeness, no representation or warranty is made regarding the property. This property is offered "as is". This submission may be modified or withdrawn at any time by the property owner or listing agent.

Easily Accessible and Well Located

- Access to I-80, Hwy 5, and I-235 via SE 14th / Hwy 69
- Located on the DART Bus Route
- Parking ratio: 5 / 1,000 on a well lit, concrete lot with excellent rear loading

Great Exposure and Visibility

- Over 28,000 VPD along SE 14th Street
- Over 4,000 businesses located within 5 miles
- Monument and building signage

Strong Retail Corridor

- Excellent retail draw near Southridge Mall (Target, Marshall's, Sear's, Younkers, etc.)
- Nearby retailers including Walmart, Gordmans, Home Depot, and HyVee
- Over 63,000 residents within 3 miles



For more information please contact:

Ben Brackett | 515.556.4596
ben@fergusoncres.com

Michael Shindler | 515.720.3492
michael@fergusoncres.com

Mitch Phillips | 515.975.8225
mitch@fergusoncres.com

Brokerage

Property Management

Consulting

Development

Address | 1840 NW 118th St, Suite 100, Clive, IA 50325 **Office** | 515.440.0400 **Website** | www.fergusoncres.com

This form is required by the real estate laws of the State of Iowa.
DISCLOSURE OF AGENCY RELATIONSHIP

The undersigned acknowledge that Ben Brackett, Mitch Phillips, and Michael Shindler, as Appointed Agent(s) of Ferguson Commercial Real Estate Services, represent Stoney Pointe Baceline LLC named below (hereinafter the "Client") with respect to the sale or lease of the following property: Stoney Pointe Plaza, 5921 SE 14th Street, Des Moines, IA 50320

If the Appointed Agent[s] represents both the Seller/Landlord and Buyer/Tenant, the duties of the Appointed Agent[s] are set forth in the Dual Agency Consent Forms executed by each client and those forms are incorporated herein as if fully set forth.

If the Appointed Agent[s] represents either the Seller/Landlord or Buyer/Tenant, but not both, the Appointed Agent has the following duties to its client:

- a) Place the client's interests ahead of the interests of any other party unless loyalty to a client violates a duty as a disclosed dual agent or other applicable law.
- b) Disclose the information known that is material to the transaction that is not known by the client or could not be discovered by the client through a reasonably diligent inspection.
- c) Fulfill any obligations within the scope of the brokerage agreement, except those obligations which are inconsistent with other duties the Appointed Agent[s] has under law.
- d) Disclose any financial interests Appointed Agent[s] has in any business entity to which the client has been referred for any service or product related to this transaction.

The following duties apply to all parties:

- a) To provide brokerage services to all parties in the transaction honestly and in good faith.
- b) To diligently exercise reasonable skill and care in providing brokerage services to all parties.
- c) To disclose to each party all material adverse facts that we know, except for the following:
 - [1] Material adverse facts known by that party.
 - [2] Material adverse facts a party could discover through a reasonably diligent inspection and which would be discovered by a reasonably prudent person under like or similar circumstances.
 - [3] Material adverse facts the disclosure of which is prohibited by law.
 - [4] Material adverse facts that are known to a person who conducts an inspection on behalf of a party.
- d) To account for all property coming into the possession of the Broker or the Appointed Agent[s] that belongs to any party within a reasonable time after receiving the property.

Ferguson Commercial Real Estate Services and its licensees may provide brokerage services simultaneously to more than one party in different transactions.

Each party by signing this form acknowledges that this disclosure was made prior to providing specific assistance or prior to any offer being made or accepted by a party to a transaction, whichever is sooner.

SELLER/LANDLORD: Stoney Pointe Baceline LLC

BUYER/TENANT:

By _____

By _____

Title _____

Title _____

Date _____

Date _____