

OFFICE SPACE FOR LEASE | SEATTLE, WASHINGTON

1201 THIRD



WHY FIT IN
WHEN YOU WERE
BORN TO STAND OUT.

— Theodor Seuss Geisel



A SKYLINE ICON

Occupying a full block in the heart of the waterfront CBD and a prominent place in defining Seattle's skyline.

1201 Third is an award-winning trophy asset that's home to a deep bench of industry-leading tenants. A massive renovation by globally acclaimed NBBJ has infused the classic asset with new life, appealing to professional and creative powerhouses alike.

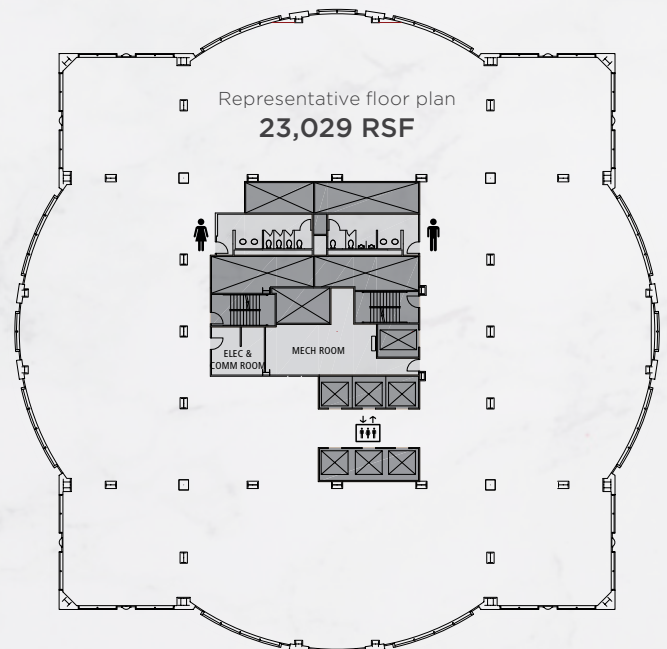



IMPRESSIVE.
INDELIBLE.
ICONIC.



DISTINCTIVE AMENITIES

Lobby
concierge



Bike
storage



Fitness
facility

State-of-the-art modular
conferencing room*



Car
detailing



Electric
car charging

* Accommodates 127 people



1,128,575 SF
building



55
stories



23,000 SF
average floor
plate size



1 / 1,500 SF
secured on-site
parking ratio



1201Third.com



LOCATION

1201 Third stands in the heart of the action.

You're only steps away from all the city has to offer — including hundreds of options for off-site dining and happy hours, prime shopping, and Seattle's evolving waterfront.

LEAVE THE CAR BEHIND

100
Transit score

Light rail
Downstairs

Zipcar
On-site



1201

ELLIOTT BAY

192 dining options within 1/4 mile

- SB ingress
- SB egress
- - - NB ingress
- - - NB egress



LLOYD LOW
+1 206 607 1796
lloyd.low@am.jll.com

JOE GOWAN
+1 206 607 1738
joe.gowan@am.jll.com

KATHRYN POPE
+1 206 607 1720
kathryn.pope@am.jll.com

© 2020 Jones Lang LaSalle IP, Inc. All rights reserved. All information contained herein is from sources deemed reliable; however, no representation or warranty is made to the accuracy thereof. Jones Lang LaSalle Brokerage, Inc.