

# CENTER AT SAXONY

13400 Tegler Drive Noblesville, IN 46060



MIDLAND ATLANTIC  
PROPERTIES



## PROPERTY OVERVIEW

Newly constructed retail center located in the Hamilton Town Center / Saxony trade area.

## PROPERTY HIGHLIGHTS

- Last Remaining Space: 1,320 Square Feet
- Newly Constructed Multi-tenant Building
- Site Located in Rapidly Growing Hamilton Town Center Area with AHHI Exceeding \$100,000
- Located in a High-Income Area with Ongoing Development

## DEMOGRAPHICS

	3 MILE	5 MILES
Total Population	41,623	98,685
Average HH Income	\$120,144	\$131,948
Businesses	743	2,669
Employees	8,039	26,922

## TRAFFIC COUNTS

Campus Parkway	22,558
----------------	--------



## MIDLAND ATLANTIC PROPERTIES

Indianapolis Office  
3801 East 82nd Street, Suite B  
Indianapolis, IN 46240

MIDLANDATLANTIC.COM

## TRACEY HOLTZMAN

Direct: 317.597.1717  
Cell: 317.410.6727  
tholtzman@midlandatlantic.us

## JEFF HUBLEY

Direct: 317.597.1713  
Cell: 317.590.7588  
jhublej@midlandatlantic.us

DEVELOPMENT • BROKERAGE • ACQUISITIONS • MANAGEMENT

Information contained herein has been obtained from sources deemed reliable but is not guaranteed and is subject to change without notice.

# CENTER AT SAXONY

13400 Tegler Drive Noblesville, IN 46060



MIDLAND ATLANTIC  
PROPERTIES

## CENTER AT SAXONY FLOORPLAN

**AVAILABLE**

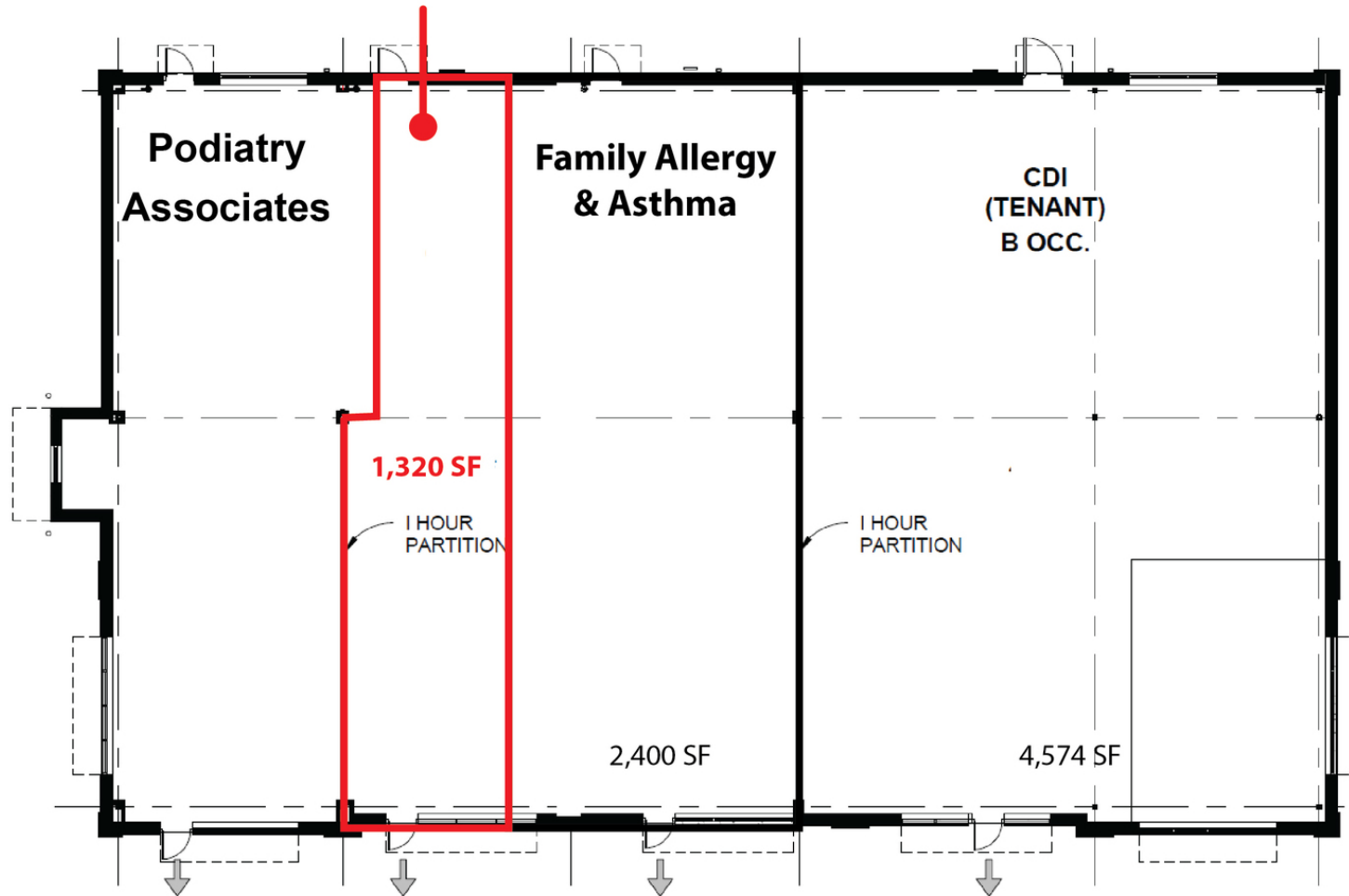



# CENTER AT SAXONY

13400 Tegler Drive Noblesville, IN 46060



MIDLAND ATLANTIC  
PROPERTIES





# CENTER AT SAXONY

13400 Tegler Drive Noblesville, IN 46060



MIDLAND ATLANTIC  
PROPERTIES

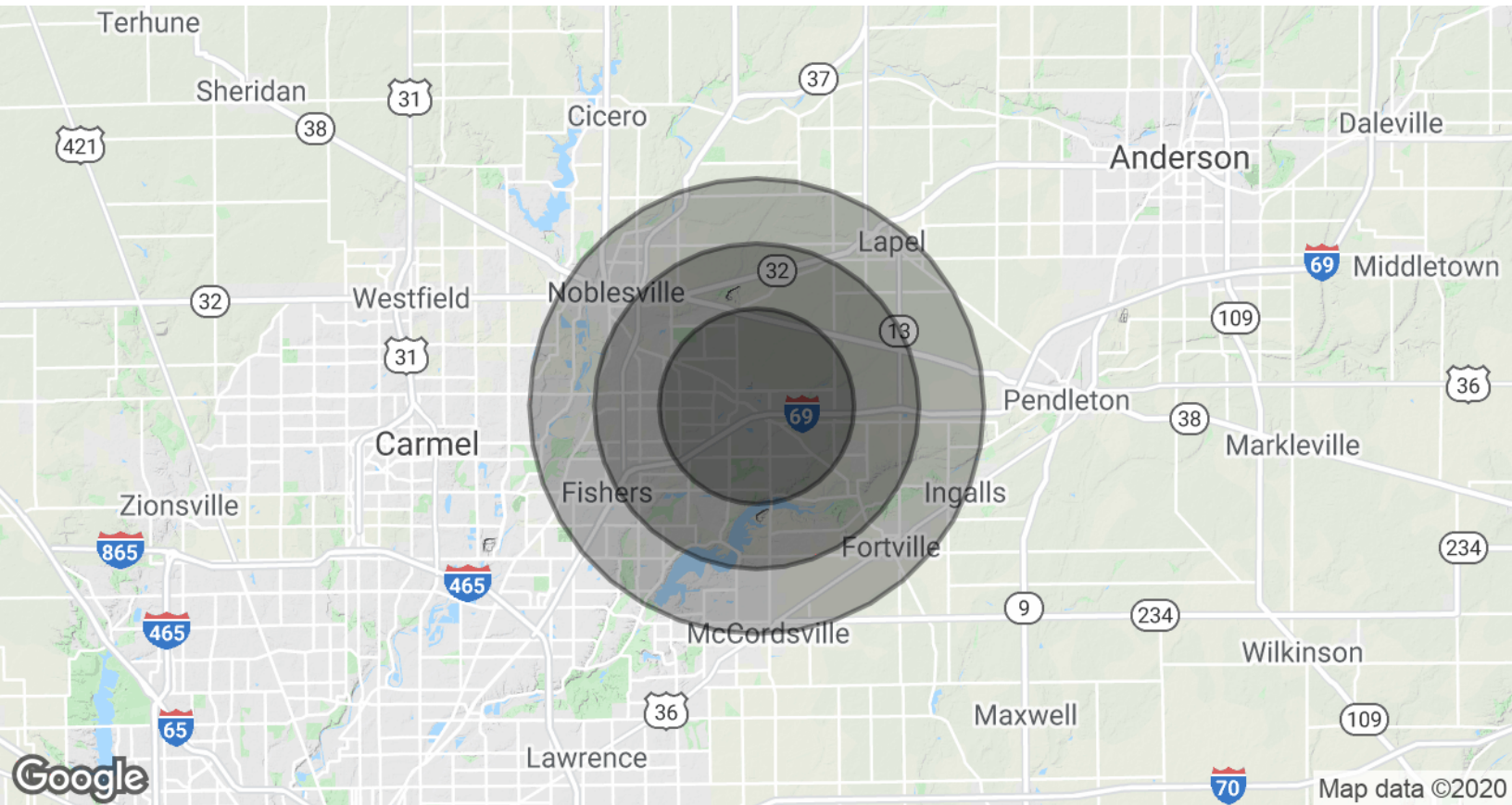

## POPULATION & HOUSING

	3 MILE	5 MILES	7 MILES
Total Population	41,623	98,685	174,710
Projected Annual Growth (2019-2024)	2.1%	2.0%	1.9%
Total Households	14,968	35,457	65,401
Median Home Value	\$266,395	\$276,154	\$252,116

## INCOME & BUSINESS

	3 MILE	5 MILES	7 MILES
Average HH income	\$120,144	\$131,948	\$121,468
Daytime Population (16+ years)	15,995	45,499	95,174
Total Businesses	743	2,669	5,862
Total Employees	8,039	26,922	59,403

### MIDLAND ATLANTIC PROPERTIES

Indianapolis Office  
3801 East 82nd Street, Suite B  
Indianapolis, IN 46240

### TRACEY HOLTZMAN

Direct: 317.597.1717  
Cell: 317.410.6727  
tholtzman@midlandatlantic.us

### JEFF HUBLEY

Direct: 317.597.1713  
Cell: 317.590.7588  
jhublej@midlandatlantic.us

MIDLANDATLANTIC.COM

DEVELOPMENT • BROKERAGE • ACQUISITIONS • MANAGEMENT

Information contained herein has been obtained from sources deemed reliable but is not guaranteed and is subject to change without notice.