

2,026 SF OFFICE SUITE FOR LEASE



CONTACT:

Pete Harper
(843) 329-0108
PHarper@Lee-Associates.com

9221 University Boulevard | North Charleston, SC 29406

SIZE: 2,026 SF PRICE: \$15.00/SF NNN

CONNECTING PEOPLE WITH PROPERTIES

PROPERTY DESCRIPTION:

Great 2nd floor suite with easy access via elevator or stairway. Suite is in a building that fronts University Blvd. and offers a waiting room, large reception and work area, 2 good sized offices, large conference/office, 2 exam rooms, lab space, 3 misc. rooms, break area, and 2 restrooms. Suite also has an additional entrance at rear of suite for Dr.'s and Staff entrance. Custom counters and cabinets in multiple rooms. Very versatile suite arrangement. Ample parking at front and back of building. Direct curb cut onto University Blvd. and direct access to Trident Hospital.

DIRECTIONS:

From Charleston, head north on Meeting Street toward Court House Square. Use the left 2 lanes to turn left to merge onto I-26 W. Keep left to stay on I-26 W. Take exit 205B to merge onto US-78 E toward US-52E. Destination will be on the right.

Disclaimer: This is subject prior to sale, change in price, or removal from the market without notice. The information included in this transmittal, while based upon data supplied by the owners and other sources deemed to be reliable, is not in any way warranted by Lee & Associates.

MAP

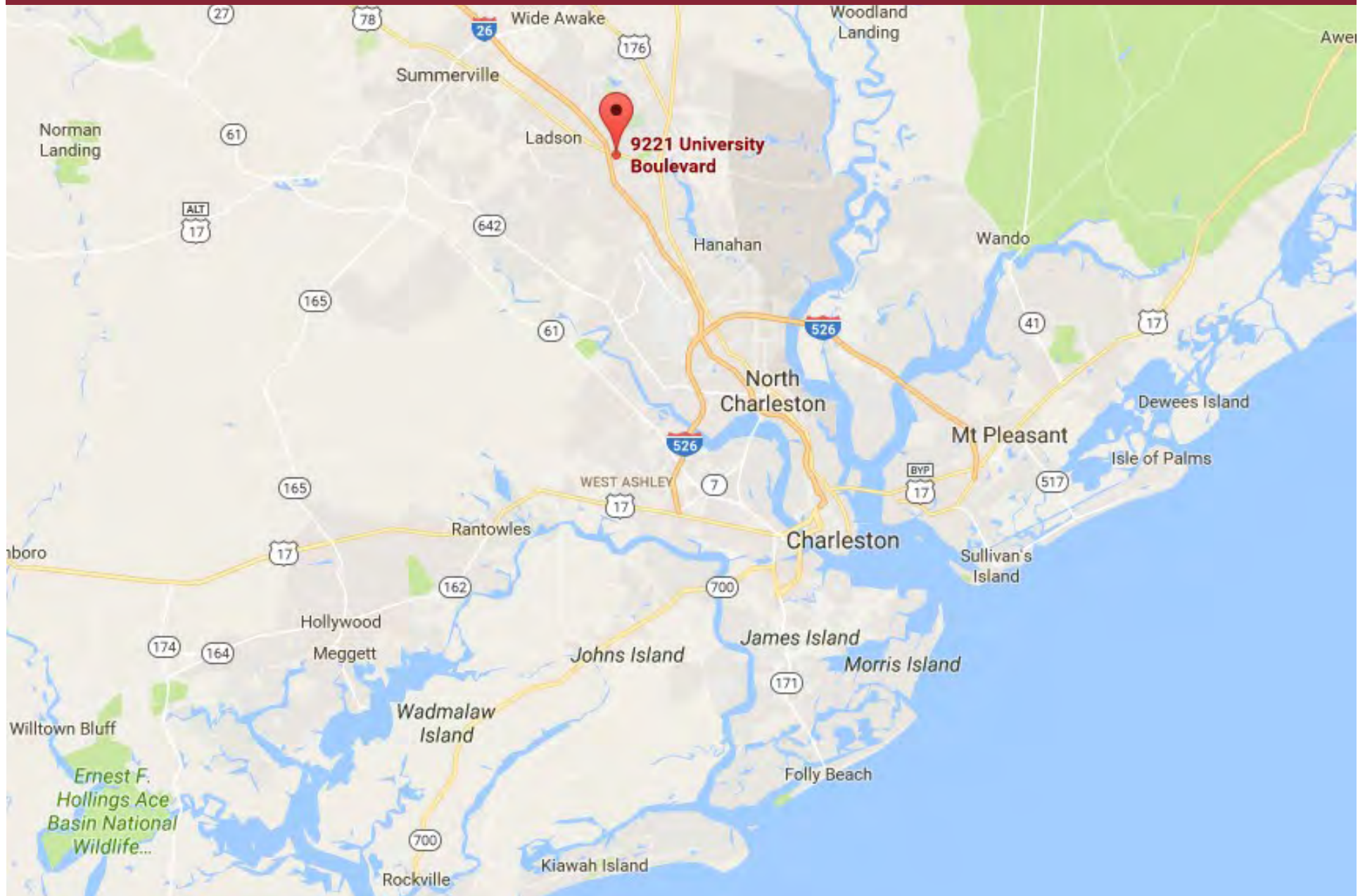

AERIAL



CONNECTING PEOPLE WITH PROPERTIES

FLOORPLAN

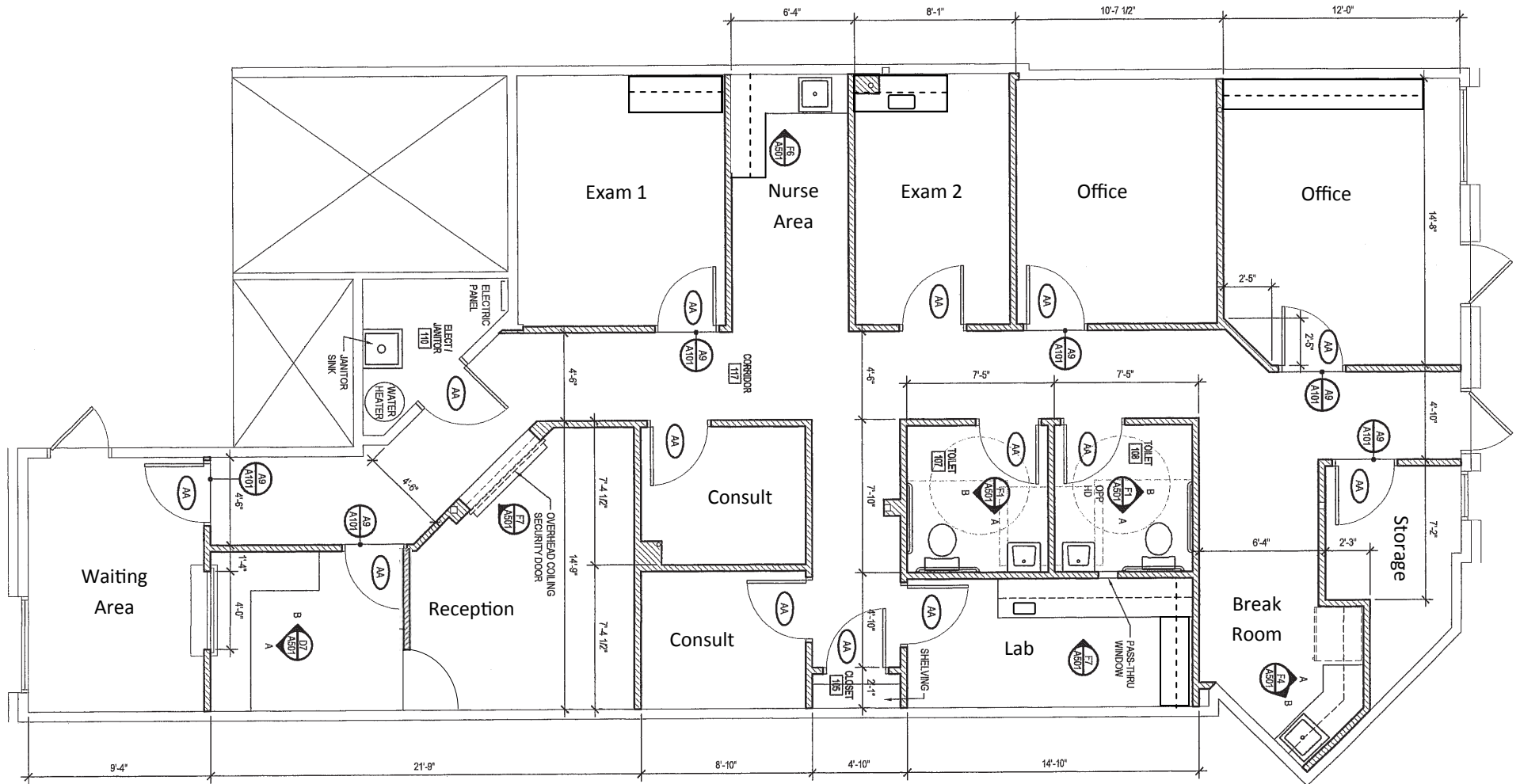

PROPERTY PHOTOS



PROPERTY PHOTOS

