



BUILDING #5

33,999 SF

AVAILABLE FOR LEASE



3559 N. Himalaya Road, Suite 400 Aurora, Colorado

Building Features

- Land Size:** 8.34 acres
- Building Size:** 159,047 SF
- Construction:** Concrete tilt-up
- Sprinkler System:** ESFR; designed to FM specifications
- Office:** To Suit
- Power:** To Suit
- Roof:** Single-ply TPO 60 mil with R-30 rigid insulation board
- Floor:** 6" concrete with sealer
- Skylights:** 1% of roof area
- Walls:** Insulated with R-11 from 8'
- Clearance:** 32' minimum at first column
- Trailer Parking:** Up to 10 spaces
- Car Parking:** Approximately 40 spaces
- Loading:** 6 dock high doors, 1 (14' x 16') ground level ramp
- Bay Spacing:** 50' x 52' bay spacing, 60' speed bay
- Other Amenities:** Single side loading

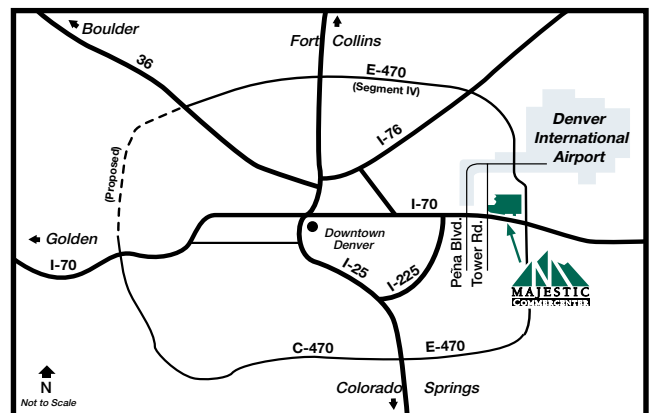
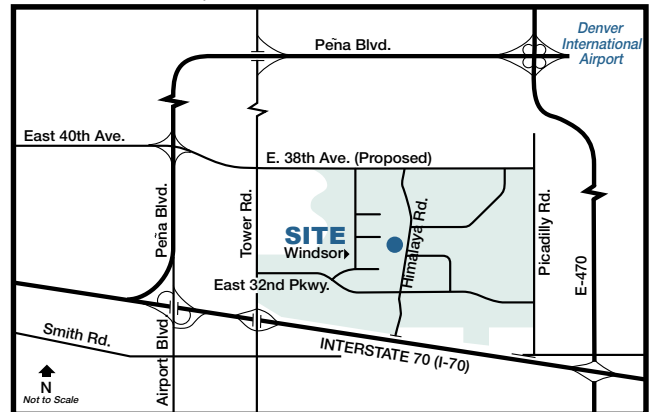

Contact Information:

Randall C. Hertel
303-371-1400
rhertel@majesticrealty.com

Michael V. Kapoor
303-574-8903
mkapoor@majesticrealty.com



20100 E. 32nd Parkway, Suite 150, Aurora, CO 80011
Main: 303-371-1400
<http://www.majesticrealty.com>

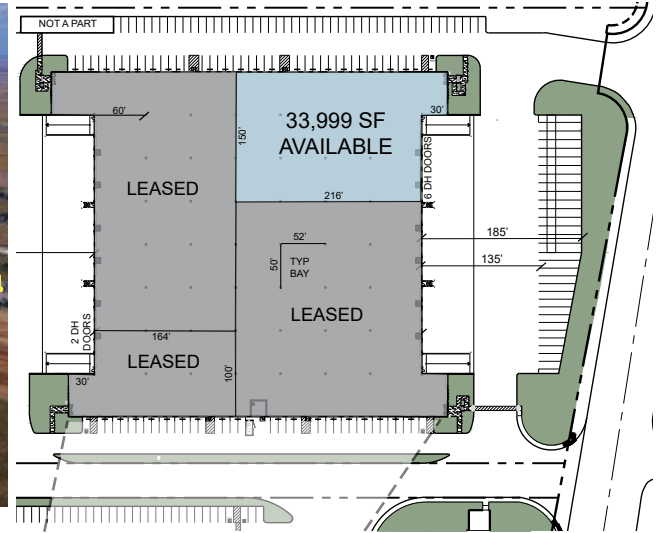

Majestic Commercenter Features

- 1,500 Acre Master Planned Business Park
- 7.5 Million Square Feet Developed
- 20,000 to 1,000,000+ Square Feet Available
- Spec Product and Build-to-Suit
- Immediate access to I-70 at Tower Road
- I-70 and E-470 Frontage
- 5 miles South of Denver International Airport
- Adams County Enterprise Zone
- Foreign Trade Zone 293
- Xcel Energy Certified Site

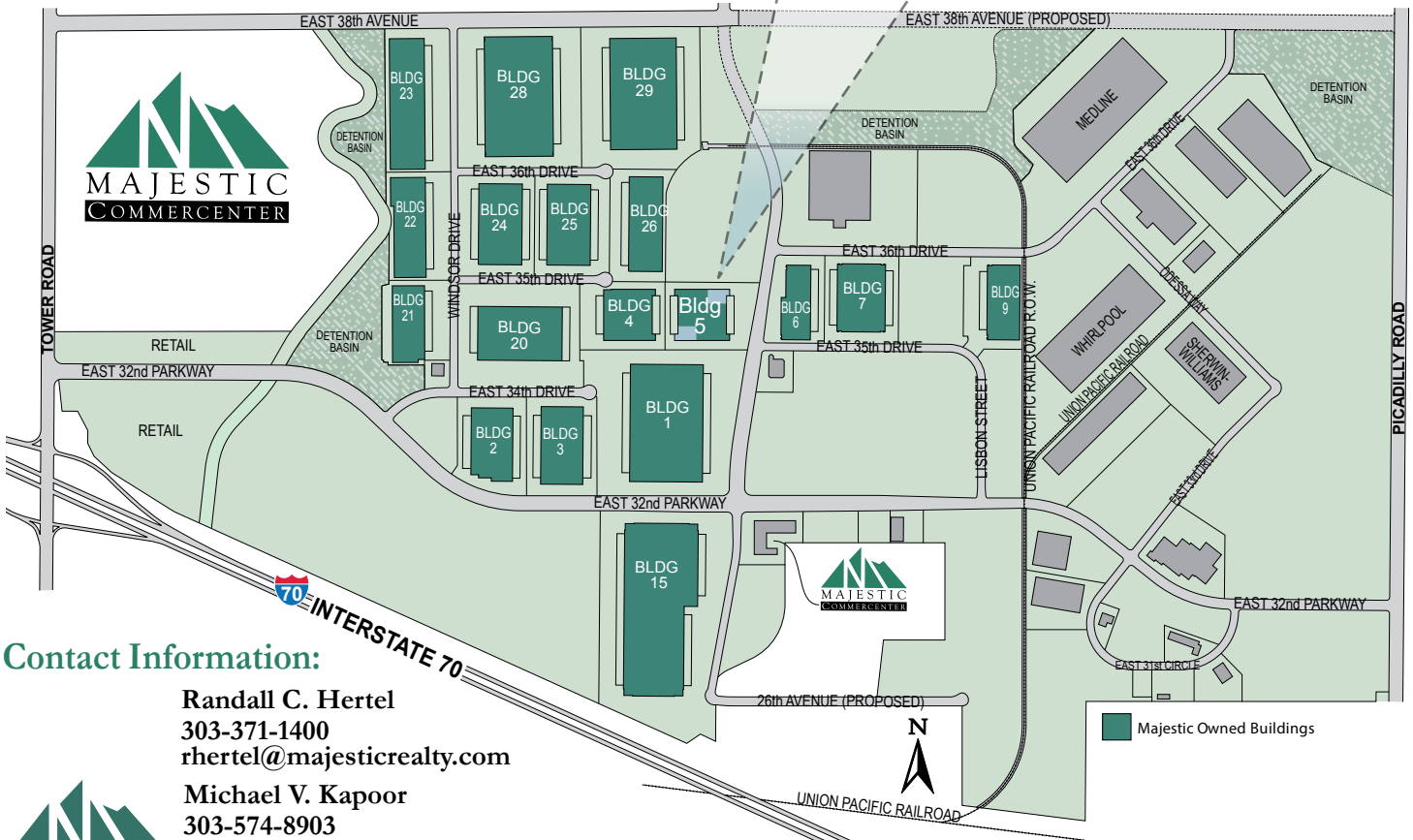

Contact Information:

Randall C. Hertel
 303-371-1400
 rhertel@majesticrealty.com

Michael V. Kapoor
 303-574-8903
 mkapoor@majesticrealty.com
 www.MCCaurora.com



This statement is based upon information which we believe to be correct and is obtained from sources we regard as reliable but we assume no liability for errors or omissions therein.