

For Lease

## Georgetown Retail/Flex 7,178 SF



## Michigan Street Building

515 S Michigan Street, Seattle, WA 98108

- 7,178 total SF
- Possibly divisible to 5,300 SF
- End cap
- Onsite parking
- 18 community parking stalls, plus street parking
- 2 loading docks
- Traffic Count = 30,000+ per day
- \$16.00 PSF/Year, NNN = \$3.164/PSF/Year

For more information:

**Bob Swain, CCIM**

+1 206 332 1482 • bswain@nai-psp.com



BELLEVUE | SEATTLE | TACOMA

1700 Seventh Avenue, Suite 2050  
Seattle, WA 98101  
+1 206 332 1466  
[nai-psp.com](http://nai-psp.com)

THE INFORMATION CONTAINED HEREIN HAS BEEN GIVEN TO US BY THE OWNER OF THE PROPERTY OR OTHER SOURCES WE DEEM RELIABLE, WE HAVE NO REASON TO DOUBT ITS ACCURACY, BUT WE DO NOT GUARANTEE IT. ALL INFORMATION SHOULD BE VERIFIED PRIOR TO PURCHASE OR LEASE.

Retail for Lease

# Michigan Street Building

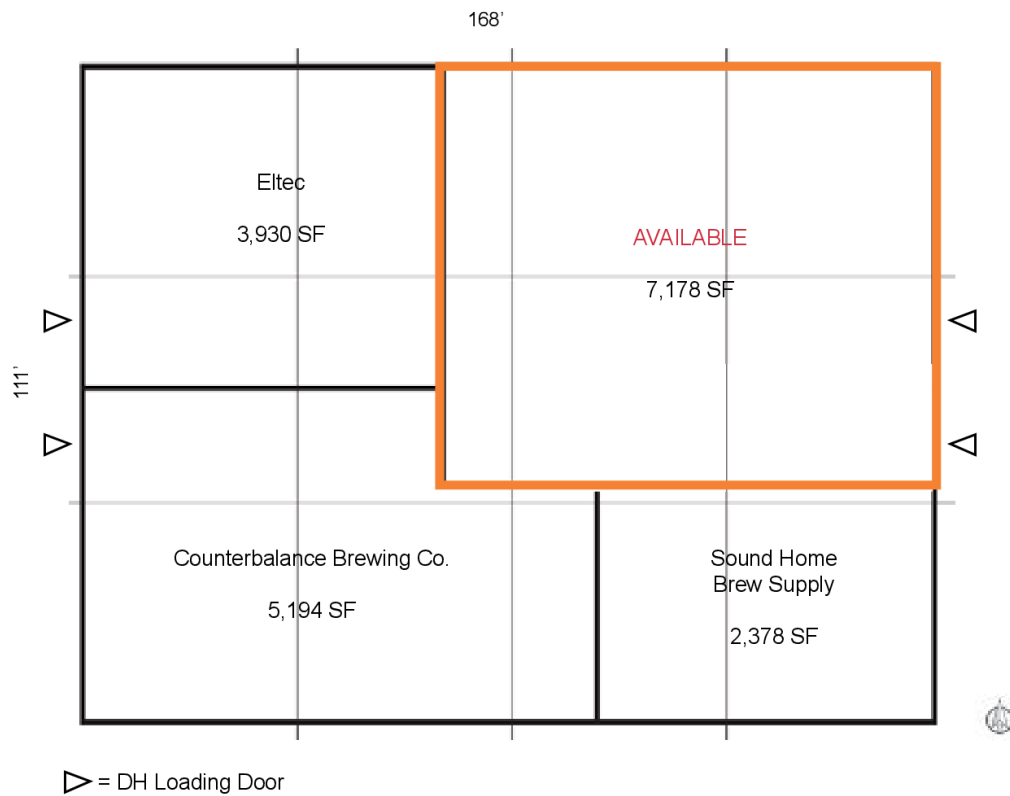
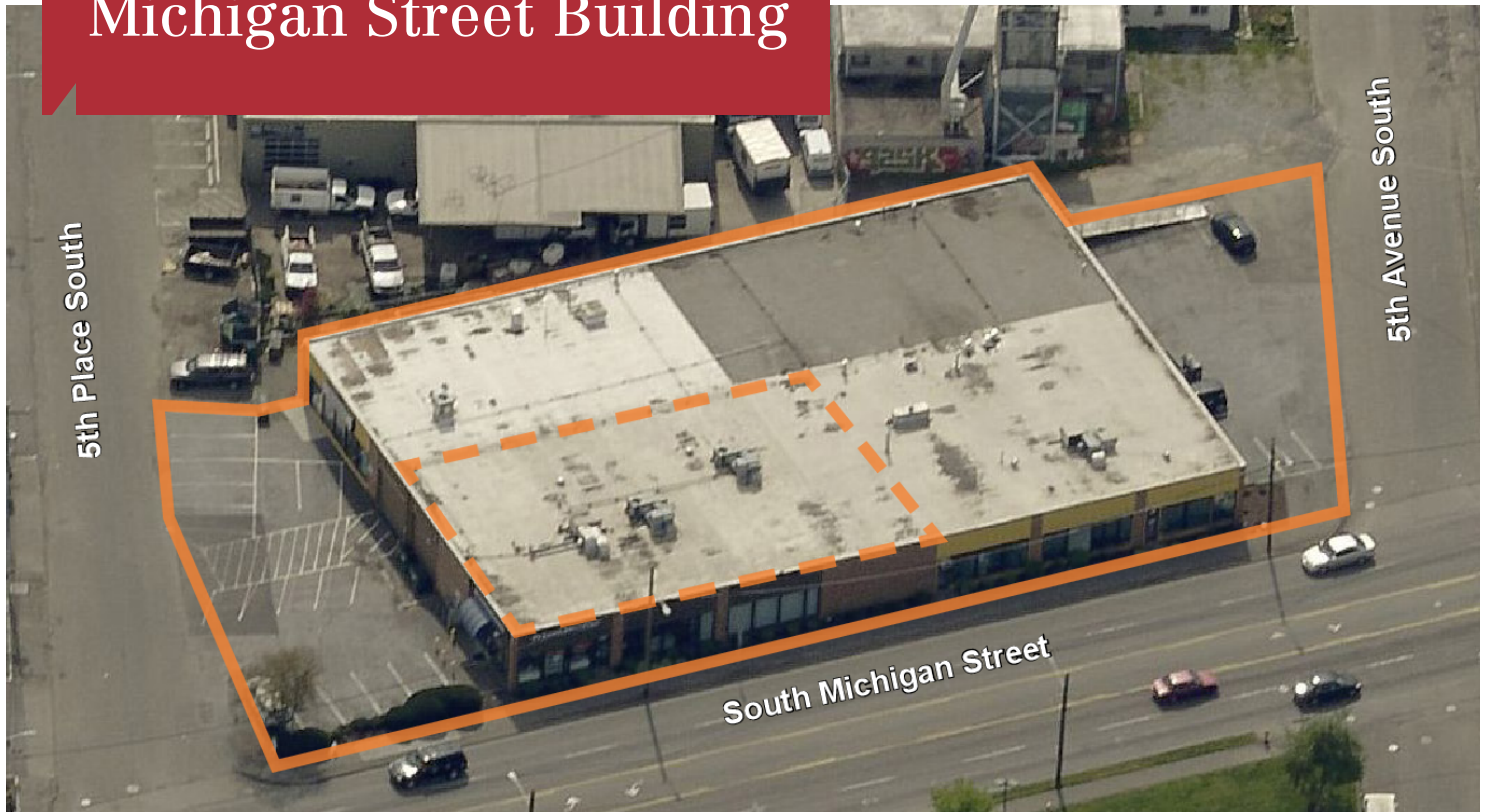

BELLEVUE | SEATTLE | TACOMA

1700 Seventh Avenue, Suite 2050  
Seattle, WA 98101  
+1 206 332 1466  
[nai-psp.com](http://nai-psp.com)

THE INFORMATION CONTAINED HEREIN HAS BEEN GIVEN TO US BY THE OWNER OF THE PROPERTY OR OTHER SOURCES WE DEEM RELIABLE, WE HAVE NO REASON TO DOUBT ITS ACCURACY, BUT WE DO NOT GUARANTEE IT. ALL INFORMATION SHOULD BE VERIFIED PRIOR TO PURCHASE OR LEASE.