

# PRIME RETAIL AVAILABLE FOR LEASE | PARK PLACE

**RESTAURANT PAD  
NOW AVAILABLE**



**Location:** Palm & Nees SWC  
Fresno, California

**Availability:** ±1,320 - 2,640 Sq. Ft.  
±1,450 - 2,800 Sq. Ft.  
±5,080 Sq. Ft.  
±6,881 Sq. Ft.

**Demographics:**

	1 Mile	3 Mile	5 Mile
<b>Population</b>	9,608	77,492	251,097
<b>Avg HH Income</b>	\$73,650	\$86,980	\$78,889

**Traffic Counts:**

Palm Ave.	±33,000 ADT
Nees Ave.	±21,000 ADT

**Property Highlights:**

- Anchored by GB3
- Excellent Tenant mix of Restaurants & Upscale Tenants
- Surrounded by Class A Office Space



COMMERCIAL RETAIL ASSOCIATES

For further information, please contact:

**Jon Cox**  
Direct Line: 559/650.1202  
jcox@retailassociates.com  
DRE License #01233044

**Sam Bogdanovich**  
Direct Line: 559/650.1308  
sbogdanovich@retailassociates.com  
DRE License #01185453

**Nathan Negri**  
Direct Line: 559/650.1317  
nnegri@retailassociates.com  
DRE License #01905421

PHONE **559/650.1300** FAX **559/650.1311**

680 West Shaw Avenue, Suite 202 | Fresno, California 93704  
www.RetailAssociates.com

All projections, opinions, assumptions or estimates are supplied for example only, and may not represent current or future performance of the property. Any and all information pertaining to location, demographics and the site plan is supplied by sources believed to be reliable. We do not guarantee the accuracy of information and make no warranty or representation thereto. All information is presented here with the possibility of errors, omissions, change of price, rental or other conditions, prior sale, lease or financing, or withdrawal without notice. Commercial Retail Associates operates under the corporate Department of Real Estate License 01121565.



# PRIME RETAIL AVAILABLE FOR LEASE | PARK PLACE



For further information, please contact:

**Jon Cox**  
 Direct Line: 559/650.1202  
[jcox@retailassociates.com](mailto:jcox@retailassociates.com)  
 DRE License #01233044

**Sam Bogdanovich**  
 Direct Line: 559/650.1308  
[sbogdanovich@retailassociates.com](mailto:sbogdanovich@retailassociates.com)  
 DRE License #01185453

**Nathan Negri**  
 Direct Line: 559/650.1317  
[nnegri@retailassociates.com](mailto:nnegri@retailassociates.com)  
 DRE License #01905421

680 West Shaw Avenue, Suite 202 | Fresno, California 93704  
[www.RetailAssociates.com](http://www.RetailAssociates.com)

All projections, opinions, assumptions or estimates are supplied for example only, and may not represent current or future performance of the property. Any and all information pertaining to location, demographics and the site plan is supplied by sources believed to be reliable. We do not guarantee the accuracy of information and make no warranty or representation thereto. All information is presented here with the possibility of errors, omissions, change of price, rental or other conditions, prior sale, lease or financing, or withdrawal without notice. Commercial Retail Associates operates under the corporate Department of Real Estate License 01121565.



# PRIME RETAIL AVAILABLE FOR LEASE | PARK PLACE



For further information, please contact:

**Jon Cox**  
 Direct Line: 559/650.1202  
 jcox@retailassociates.com  
 DRE License #01233044

**Sam Bogdanovich**  
 Direct Line: 559/650.1308  
 sbogdanovich@retailassociates.com  
 DRE License #01185453

**Nathan Negri**  
 Direct Line: 559/650.1317  
 nnegri@retailassociates.com  
 DRE License #01905421



680 West Shaw Avenue, Suite 202 | Fresno, California 93704  
[www.RetailAssociates.com](http://www.RetailAssociates.com)

All projections, opinions, assumptions or estimates are supplied for example only, and may not represent current or future performance of the property. Any and all information pertaining to location, demographics and the site plan is supplied by sources believed to be reliable. We do not guarantee the accuracy of information and make no warranty or representation thereto. All information is presented here with the possibility of errors, omissions, change of price, rental or other conditions, prior sale, lease or financing, or withdrawal without notice. Commercial Retail Associates operates under the corporate Department of Real Estate License 01121565.



# PRIME RETAIL AVAILABLE FOR LEASE | PARK PLACE

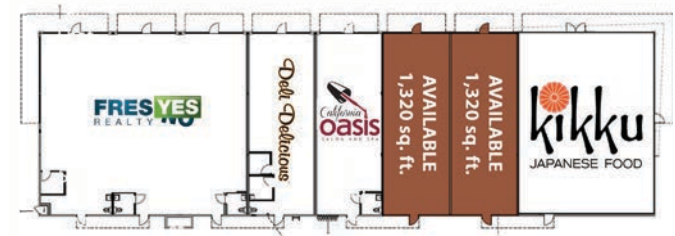
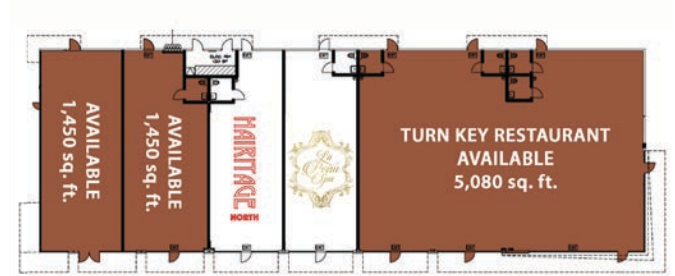
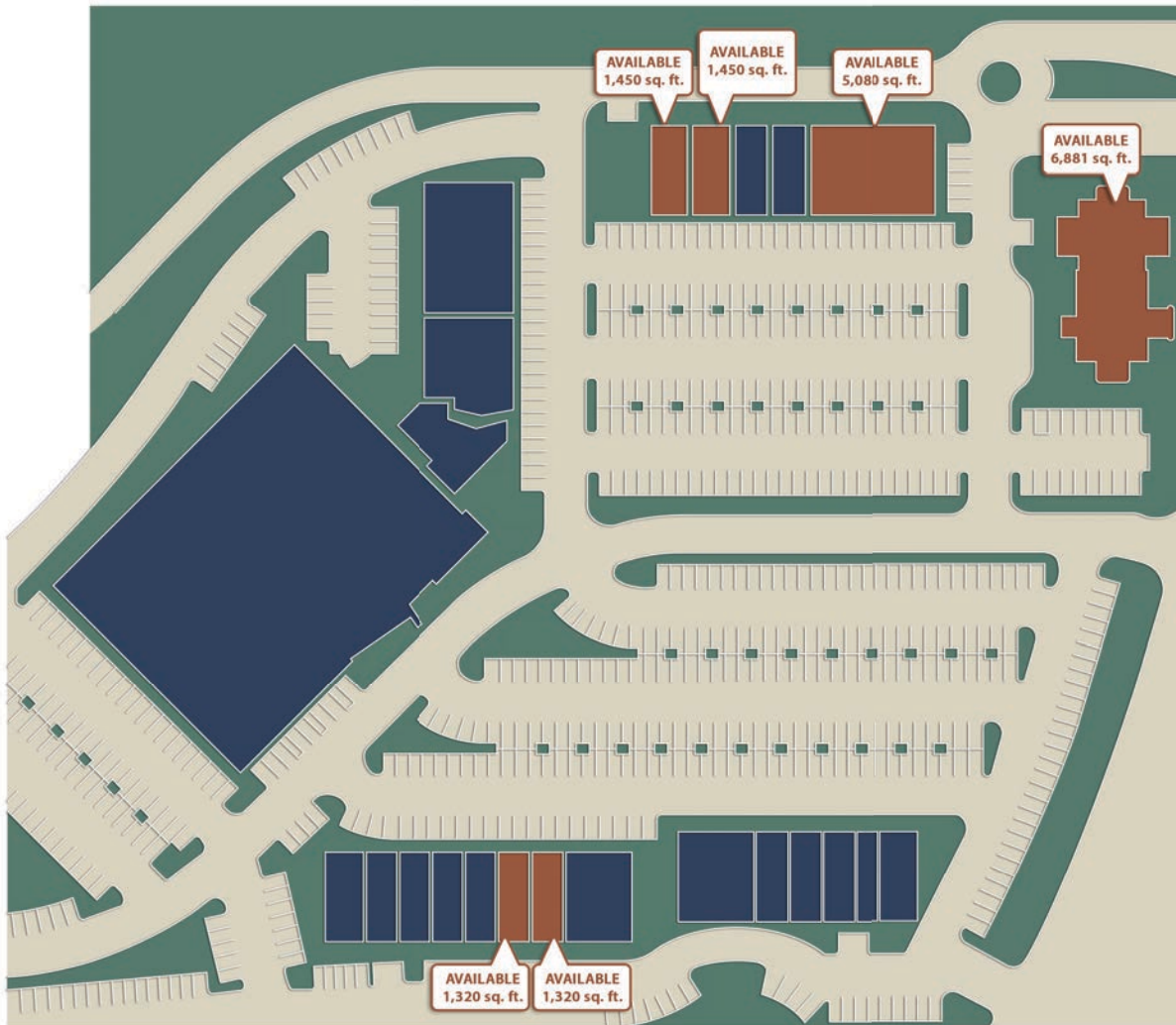

For further information, please contact:

**Jon Cox**  
 Direct Line: 559/650.1202  
[jcox@retailassociates.com](mailto:jcox@retailassociates.com)  
 DRE License #01233044

**Sam Bogdanovich**  
 Direct Line: 559/650.1308  
[sbogdanovich@retailassociates.com](mailto:sbogdanovich@retailassociates.com)  
 DRE License #01185453

**Nathan Negri**  
 Direct Line: 559/650.1317  
[nnegri@retailassociates.com](mailto:nnegri@retailassociates.com)  
 DRE License #01905421



680 West Shaw Avenue, Suite 202 | Fresno, California 93704  
[www.RetailAssociates.com](http://www.RetailAssociates.com)

All projections, opinions, assumptions or estimates are supplied for example only, and may not represent current or future performance of the property. Any and all information pertaining to location, demographics and the site plan is supplied by sources believed to be reliable. We do not guarantee the accuracy of information and make no warranty or representation thereto. All information is presented here with the possibility of errors, omissions, change of price, rental or other conditions, prior sale, lease or financing, or withdrawal without notice. Commercial Retail Associates operates under the corporate Department of Real Estate License 01121565.

