

2228 Wadsworth Road, Waukegan

10.02 ACRES FOR SALE OR LEASE



SPECIFICATIONS

PROPERTY SIZE: 10.02 Acres

EXISTING WAREHOUSE: 3,000 SF

ZONING: I-1

LOADING: 2 Drive in Doors

RE TAXES: \$7,253 (2018)

SALE PRICE: \$1,499,000

LEASE: Subject to Offer

- Currently Occupied by Landscaping and Nursery Company
- Brand New 3,000 SF Building plus Existing House Currently Used for Office
- Great Contractors Yard
- Perfect for Landscapers or Nurseries
- Self Storage
- Outside Storage
- Car Count 15,900
- Highly Visible – 335 Feet of Frontage on Wadsworth Rd.
- Great Signage
- Directly Across from Waukegan Airport
- Nursery Stock is Available

www.entrecommercial.com

3550 Salt Creek Lane, Suite 104, Arlington Heights, IL. 60005

ENTRE
Commercial Realty LLC

2228 Wadsworth Road, Waukegan

10.02 ACRES FOR SALE OR LEASE



Contact:

Brian Bocci
 847-310-4296
 bbocci@entrecmercial.com

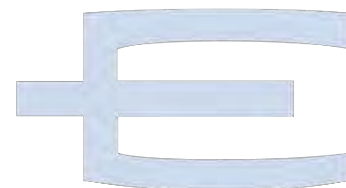

www.entrecmercial.com

3550 Salt Creek Lane, Suite 104, Arlington Heights, IL. 60005

ENTRE
 Commercial Realty LLC

2228 Wadsworth Road, Waukegan

10.02 ACRES FOR SALE OR LEASE

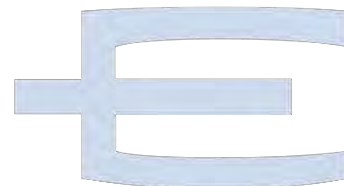
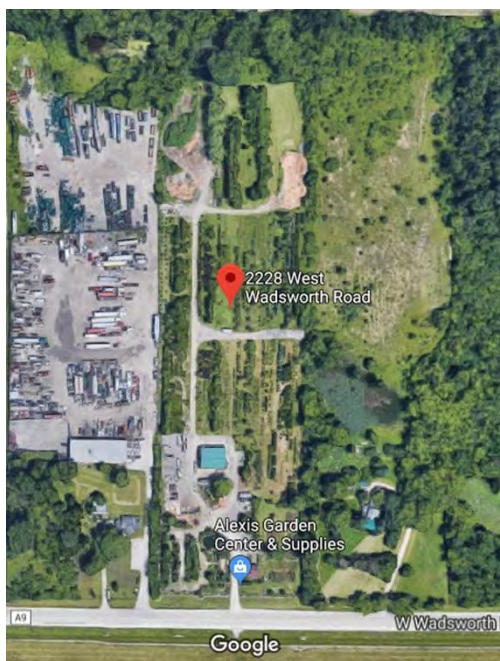
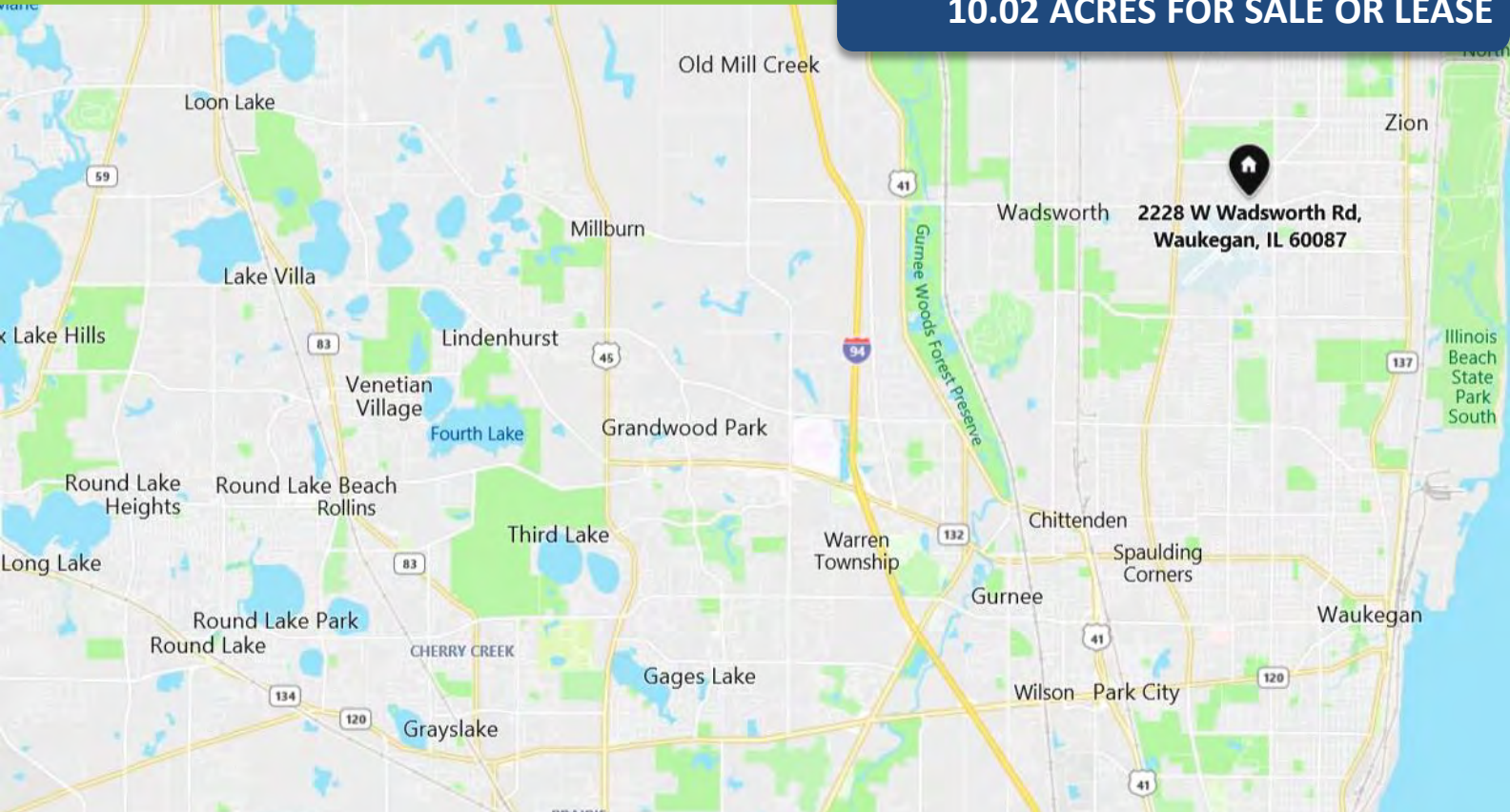

Contact:

Brian Bocci
 847-310-4296
 bbocci@entrecommercial.com

www.entrecommercial.com

3550 Salt Creek Lane, Suite 104, Arlington Heights, IL. 60005

