

±2,040 SF
AVAILABLE



SUNSET LAKE ROAD & LASSITER ROAD

HOLLY SPRINGS, NORTH CAROLINA 27540

RETAIL SPACE FOR LEASE
± 2,040 SF

SUNSET LAKE ROAD & LASSITER ROAD

RETAIL SPACE FOR LEASE

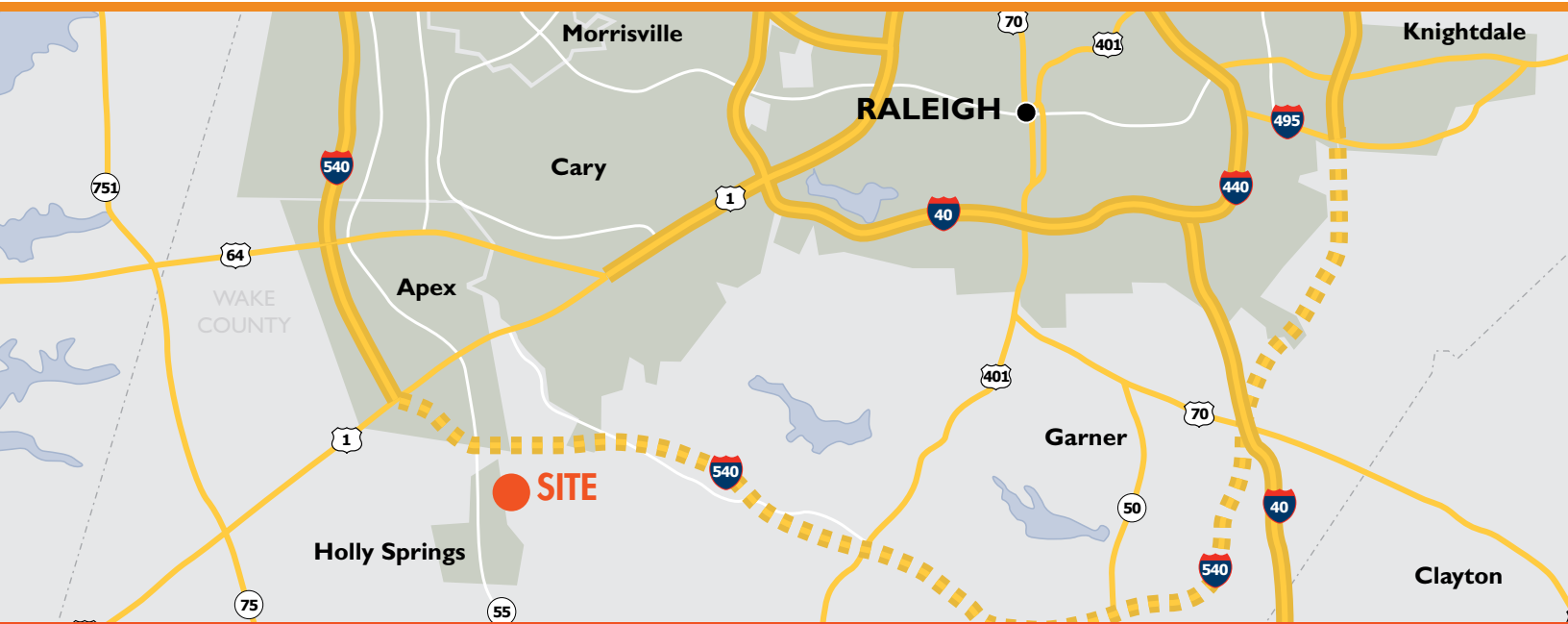

PROPERTY FEATURES

- Join Sherwin Williams and Dunkin' on one of Holly Springs strongest retail corridors
- 2,040 SF remaining
- Signalized intersection at the corner of Sunset Lake Road and Lassiter Road
- Ideally situated in between two prominent shopping centers anchored by Harris Teeter and Planet Fitness
- Strong residential growth surrounding the site with 1,700+ single family and multifamily units under construction within 1 mile
- Excellent visibility with easy access

AREA RETAILERS



BUILDING FEATURES

SPACE AVAILABLE	±2,040 SF
LOT SIZE	±1.14 AC
TIMING	Immediately

DEMOGRAPHICS

	1 MILE	3 MILES	5 MILES
2019 ESTIMATED POPULATION	5,588	54,602	108,402
2024 PROJECTED POPULATION	6,165	60,127	119,399
EST. HOUSEHOLD INCOME	\$130,089	\$118,880	\$116,440

TRAFFIC COUNTS

SUNSET LAKE ROAD	32,006 VPD
HOLLY SPRINGS ROAD	26,000 VPD

For more information, please contact:

JAMES MATTOX
 Managing Director
 (919) 576 2696
james.mattox@foundrycommercial.com

ROSS DIACHENKO
 Senior Associate
 (919) 576 2683
ross.diachenko@foundrycommercial.com

FOUNDRY
 COMMERCIAL

2301 Sugar Bush Road, Suite 220
 Raleigh, NC 27612

foundrycommercial.com

Although the information contained herein was provided by sources believed to be reliable, Foundry Commercial makes no representation, expressed or implied, as to its accuracy and said information is subject to errors, omissions or changes.

SUNSET LAKE ROAD & LASSITER ROAD

RETAIL SPACE FOR LEASE

SITE PLAN

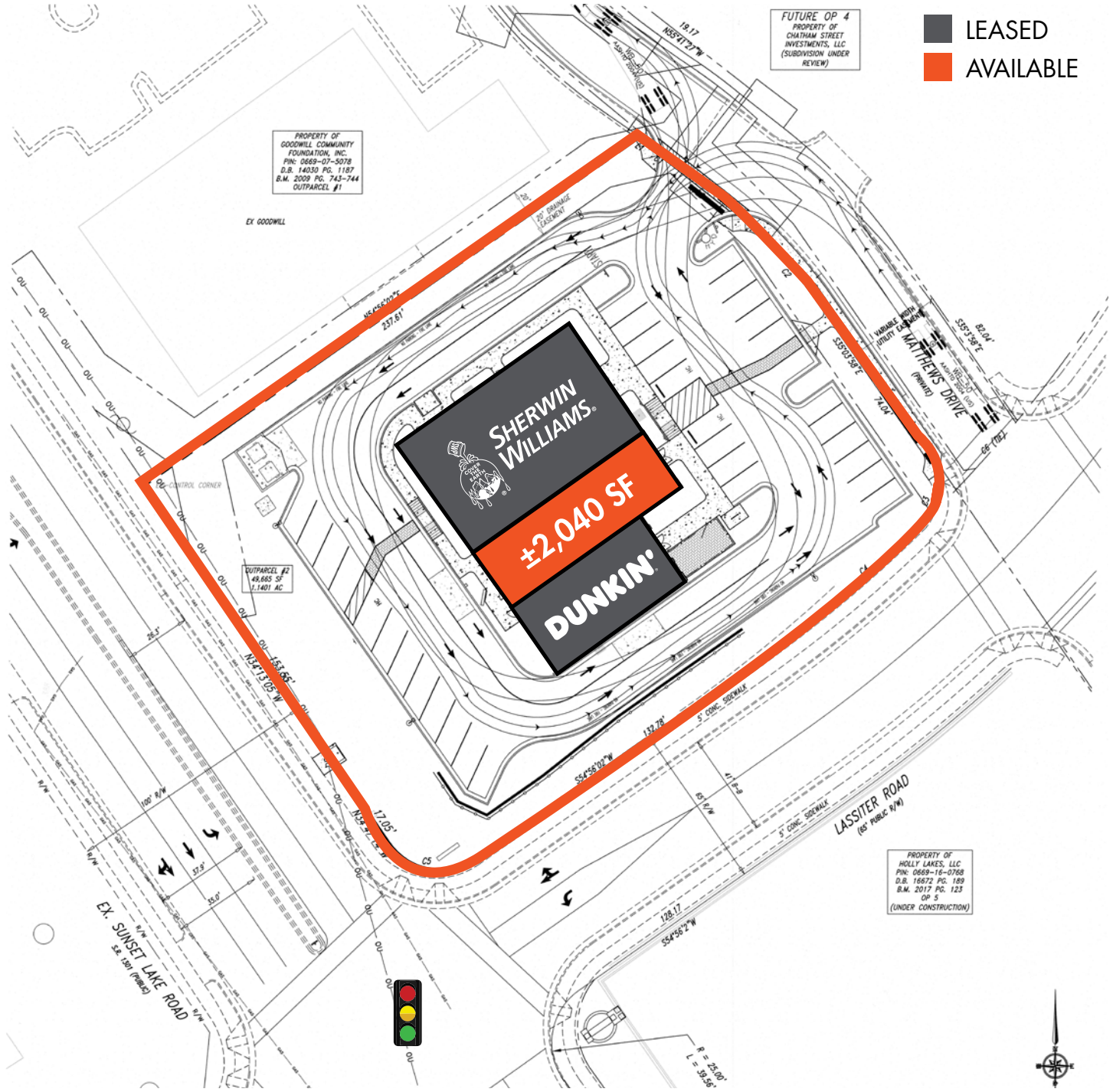

For more information, please contact:

ROSS DIACHENKO
Senior Associate
(919) 576 2683
ross.diachenko@foundrycommercial.com

JAMES MATTOX
Managing Director
(919) 576 2696
james.mattox@foundrycommercial.com

FOUNDRY
COMMERCIAL

2301 Sugar Bush Road, Suite 220
Raleigh, NC 27612

foundrycommercial.com

Although the information contained herein was provided by sources believed to be reliable, Foundry Commercial makes no representation, expressed or implied, as to its accuracy and said information is subject to errors, omissions or changes.

SUNSET LAKE ROAD & LASSITER ROAD

RETAIL SPACE FOR LEASE

LOCATION



For more information, please contact:

ROSS DIACHENKO
Senior Associate
(919) 576 2683
ross.diachenko@foundrycommercial.com

JAMES MATTOX
Managing Director
(919) 576 2696
james.matttox@foundrycommercial.com

FOUNDRY
COMMERCIAL

2301 Sugar Bush Road, Suite 220
Raleigh, NC 27612

foundrycommercial.com

Although the information contained herein was provided by sources believed to be reliable, Foundry Commercial makes no representation, expressed or implied, as to its accuracy and said information is subject to errors, omissions or changes.

SUNSET LAKE ROAD & LASSITER ROAD

RETAIL SPACE FOR LEASE

RESIDENTIAL GROWTH



1 Peterson Station at Sunset Lake
310 Multifamily Units
Approved

2 Woodcreek
871 Single Family Homes & Townhomes
Under Construction

3 344 Single Family Lots
Under Construction

4 Brook Manor
141 Single Family Lots
Under Construction

5 Creekside at Sunset Lake
46 Single Family Lots
Under Construction

6 Westcott Way
21 Single Family Lots
Under Construction

7 Holly Springs
Elementary School

8 Holly Ridge
Elementary School

9 Holly Ridge
Middle School

10 West Lake
Middle School

11 West Lake
Elementary School

12 Primrose School
at West Lake

13 Middle Creek
High School

14 Middle Creek
Elementary School

For more information, please contact:

ROSS DIACHENKO
Senior Associate
(919) 576 2683
ross.diachenko@foundrycommercial.com

JAMES MATTOX
Managing Director
(919) 576 2696
james.mattox@foundrycommercial.com

FOUNDRY
COMMERCIAL

2301 Sugar Bush Road, Suite 220
Raleigh, NC 27612

foundrycommercial.com

Although the information contained herein was provided by sources believed to be reliable, Foundry Commercial makes no representation, expressed or implied, as to its accuracy and said information is subject to errors, omissions or changes.