

**FOR LEASE**

# Lakewood-Tacoma Logistics Center

14801 Spring Street SW, Lakewood



**UNDER CONSTRUCTION**

**2017 DELIVERY**

 PANATTONI<sup>®</sup>  
lakewoodtacomagateway.com

**CONTACT** Thad Mallory, SIOR  
206.248.7338 | [tmallory@kiddermathews.com](mailto:tmallory@kiddermathews.com)  
Tyler Clarke  
253.722.1419 | [tyclarke@kiddermathews.com](mailto:tyclarke@kiddermathews.com)

Todd Clarke  
253.722.1422 | [tclarke@kiddermathews.com](mailto:tclarke@kiddermathews.com)

 **Kidder Mathews**

[kiddermathews.com](http://kiddermathews.com)

This information supplied herein is from sources we deem reliable. It is provided without any representation, warranty or guarantee, expressed or implied as to its accuracy. Prospective Buyer or Tenant should conduct an independent investigation and verification of all matters deemed to be material, including, but not limited to, statements of income and expenses. CONSULT YOUR ATTORNEY, ACCOUNTANT, OR OTHER PROFESSIONAL ADVISOR.

# Lakewood-Tacoma Logistics Center

14801 Spring Street SW, Lakewood

## Site Plan

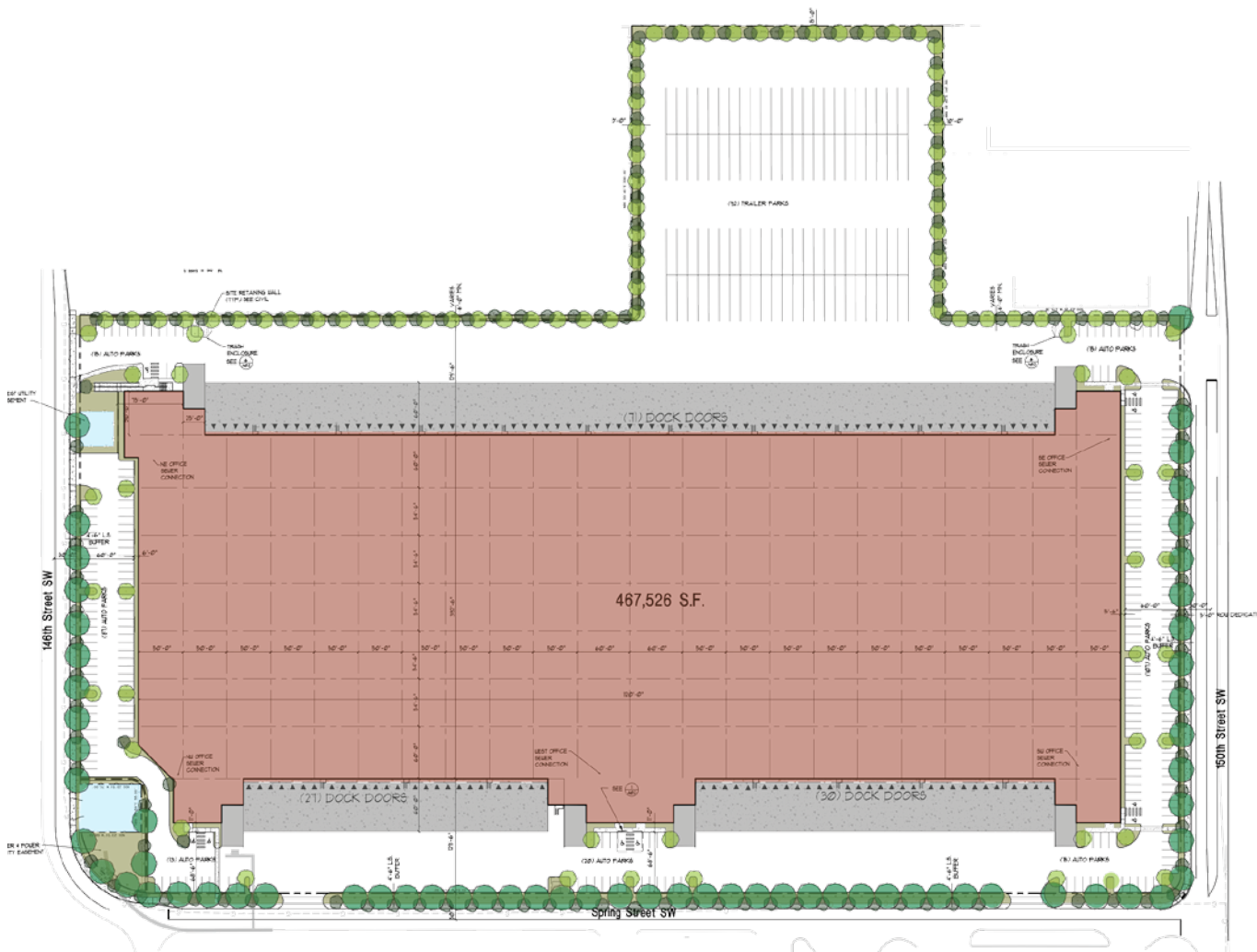

## Features

<b>BUILDING</b>	4th Qtr 2017
<b>DELIVERY</b>	
<b>AVAILABLE SF</b>	467,526 SF on 21.83 acres
<b>STATUS</b>	Under construction
<b>PROXIMITY TO</b>	Port of Tacoma - 12 miles/I-5 - 1/4 mile
<b>DOORS</b>	128 DH/ 6 GL
<b>POWER</b>	2,400 AMPS, Three Phase
<b>CLEAR HEIGHT</b>	36'
<b>TRUCK COURTS</b>	130'
<b>BUILDING DIMENSIONS</b>	393 x 1120
<b>COLUMN SPACING</b>	50' x 50' with 60' Speed Bay
<b>PARKING</b>	272 auto parking, 92 trailer parking stalls, 8 handicap stalls
<b>TAX BENEFITS</b>	Foreign trade zone #86 EB5 target employment area HUB zone New market tax credit eligible No city B&O tax
<b>THORNE LANE INTERCHANGE</b>	<a href="http://www.wsdot.wa.gov/Projects/15/MountsRdThorneLn/">http://www.wsdot.wa.gov/Projects/15/MountsRdThorneLn/</a>
<b>RATE</b>	Shell: \$0.43 Office: \$1.00

**Thad Mallory, SIOR**  
206.248.7338  
tmallory@kiddermathews.com

**Todd Clarke**  
253.722.1422  
tclarke@kiddermathews.com

**Tyler Clarke**  
253.722.1419  
tyclarke@kiddermathews.com [kiddermathews.com](http://www.kiddermathews.com)

 PANATTONI®

 **Kidder Mathews**

# Lakewood-Tacoma Logistics Center

14801 Spring Street SW, Lakewood



**Thad Mallory, SIOR**  
206.248.7338  
tmallory@kiddermathews.com

**Todd Clarke**  
253.722.1422  
tclarke@kiddermathews.com

**Tyler Clarke**  
253.722.1419  
tyclarke@kiddermathews.com [kiddermathews.com](http://kiddermathews.com)

 PANATTONI®

 **Kidder Mathews**

# Lakewood-Tacoma Logistics Center

14801 Spring Street SW, Lakewood

## New I-5 Interchange - 2017 Construction, 2019 Completion



**THORNE LANE INTERCHANGE** <http://www.wsdot.wa.gov/Projects/I5/MountsRdThorneLn/>

**Thad Mallory, SIOR**  
206.248.7338  
tmallory@kiddermathews.com

**Todd Clarke**  
253.722.1422  
tclarke@kiddermathews.com

**Tyler Clarke**  
253.722.1419  
tyclarke@kiddermathews.com [kiddermathews.com](http://kiddermathews.com)

 PANATTONI®

 **Kidder Mathews**