

LAND For Sale

Location: 42-62 Piquette Avenue
Side of Street: South
City: Detroit, MI
Cross Streets: Woodward Ave.
County: Wayne

Acreage: 0.67	Improvements: N/A
Zoning: M-2	Dimensions:

UTILITIES

Sanitary Sewer: Yes	Gas: Yes
Storm Sewer: Yes	Outside Storage: No
Water: Yes	Rail Siding: No

ADJACENT LAND

North: Retail	East: Storage
South: Retail	West: Retail

PRICING INFORMATION

Asking Price: \$1,750,000.00	Parcel #: 010017-86, 010017-85
Per Acre:	Assessor Number: N/A
Per SqFt :	Taxes: \$5,940.05 (2022)
Terms:	

TRAFFIC INFORMATION

Yr: 2022	Count: 22,674	Woodward Ave. N. of I-94 2-Way
Yr: 2022	Count: 21,333	Woodward Ave. S. of I-94 2-Way
Yr: 2022	Count: 142,433	I-94 E. of Woodward Ave. 2-Way
Yr: 2022	Count: 152,697	I-94 W. of Woodward Ave. 2-Way

DEMOGRAPHICS

	Population	Median HH Income
1 Mile Radius	16,488	\$31,917
3 Mile Radius	129,838	\$35,646
5 Mile Radius	297,714	\$35,699

Comments: Midtown development opportunity near Woodward Avenue. Strong demographics and centered between Wayne State University and New Center. Flexible zoning with excellent development potential.

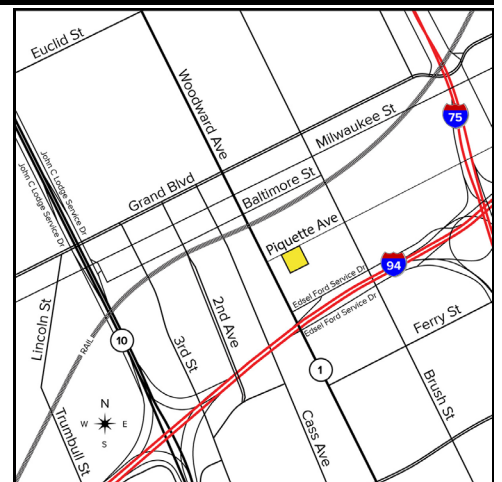

Broker: SIGNATURE ASSOCIATES

Agent(s):

Joe Stack, (248) 359-0615, jstack@signatureassociates.com
 Chris Monsour, (248) 948-0107, cmonsour@signatureassociates.com

Information is subject to verification and no liability for errors or omissions is assumed. Price and terms are subject to modification.