

Columbia
Bank

104TH ST E

Wilco
FARM STORES



76

CANYON RD E

106TH ST E

GROUND LEASE OR BUILD TO SUIT

10523 Canyon Rd E & 5415 106th St E
Puyallup, WA 98373



106TH & CANYON ROAD

Tim Weber | Don Whittles | Blake Weber

First Western Properties—Tacoma Inc. | 253.472.0404
6402 Tacoma Mall Blvd, Tacoma, WA 98409 | fwp-inc.com

GROUND LEASE OR BUILD TO SUIT

7980000160
FRONT PARCEL 0.41 ACRES/ 17,859 SF
 (FORMER CAR WASH)

7980000151
BACK PARCEL 0.48 ACRES/ 20,700 SF

5,760 SF BUILDING FOR LEASE
\$16.00 PSF PLUS NNN



- Located just off Highway 512
- Adjacent to Wilco Farm Stores which draws shoppers from all over Pierce County
- Nestled between Tacoma and Puyallup major shopping hubs



Regis - 2020
Population



Average HH Income



Daytime Population

Mile 1 6,378 \$85,949 4,641

Mile 3 54,342 \$95,154 32,605

Mile 5 236,825 \$84,317 135,877

NEARBY TENANTS

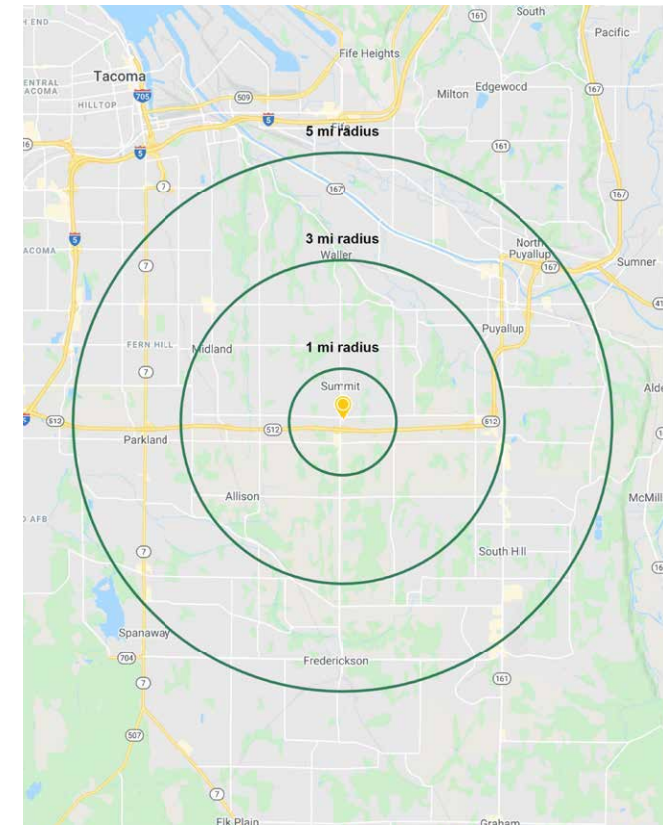

SUMMARY

SUMMARY

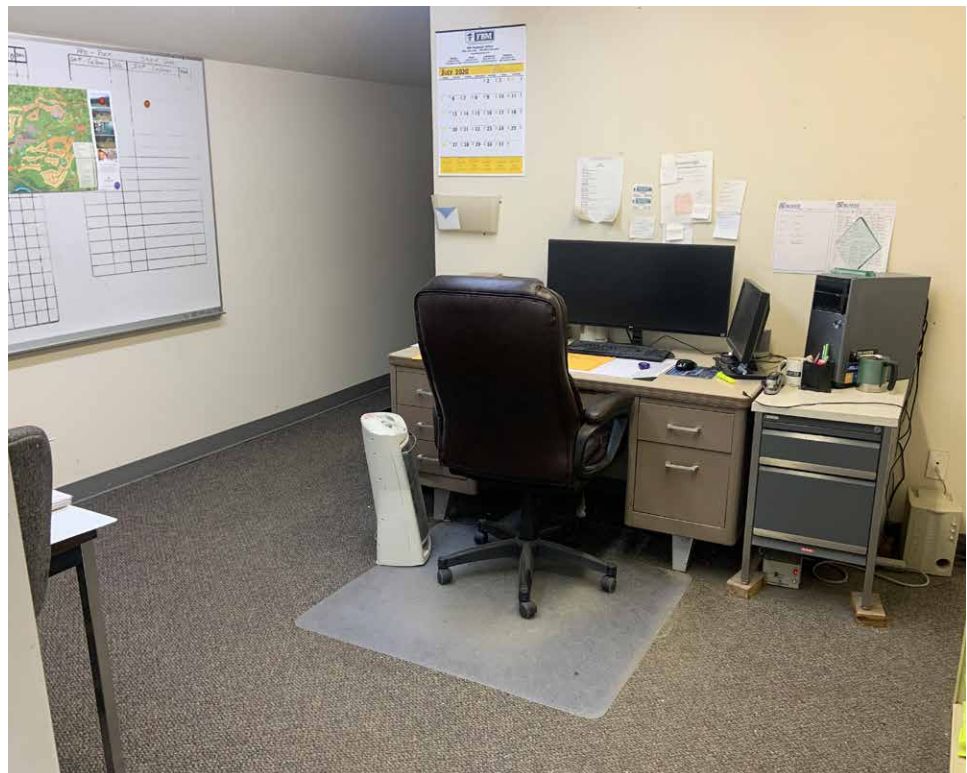

LOCATION AERIAL

Columbia Bank

Wilco FARM STORES

104TH STE - 6K CPD

ST VINCENT'S

7980000151

7980000160

CANYON RD E - 31K CPD

106TH STE

76

WA-512 OFFRAMP

WA-512 ONRAMP

WA-512 81K CPD

512

LOCATION AERIAL



PARCEL MAP

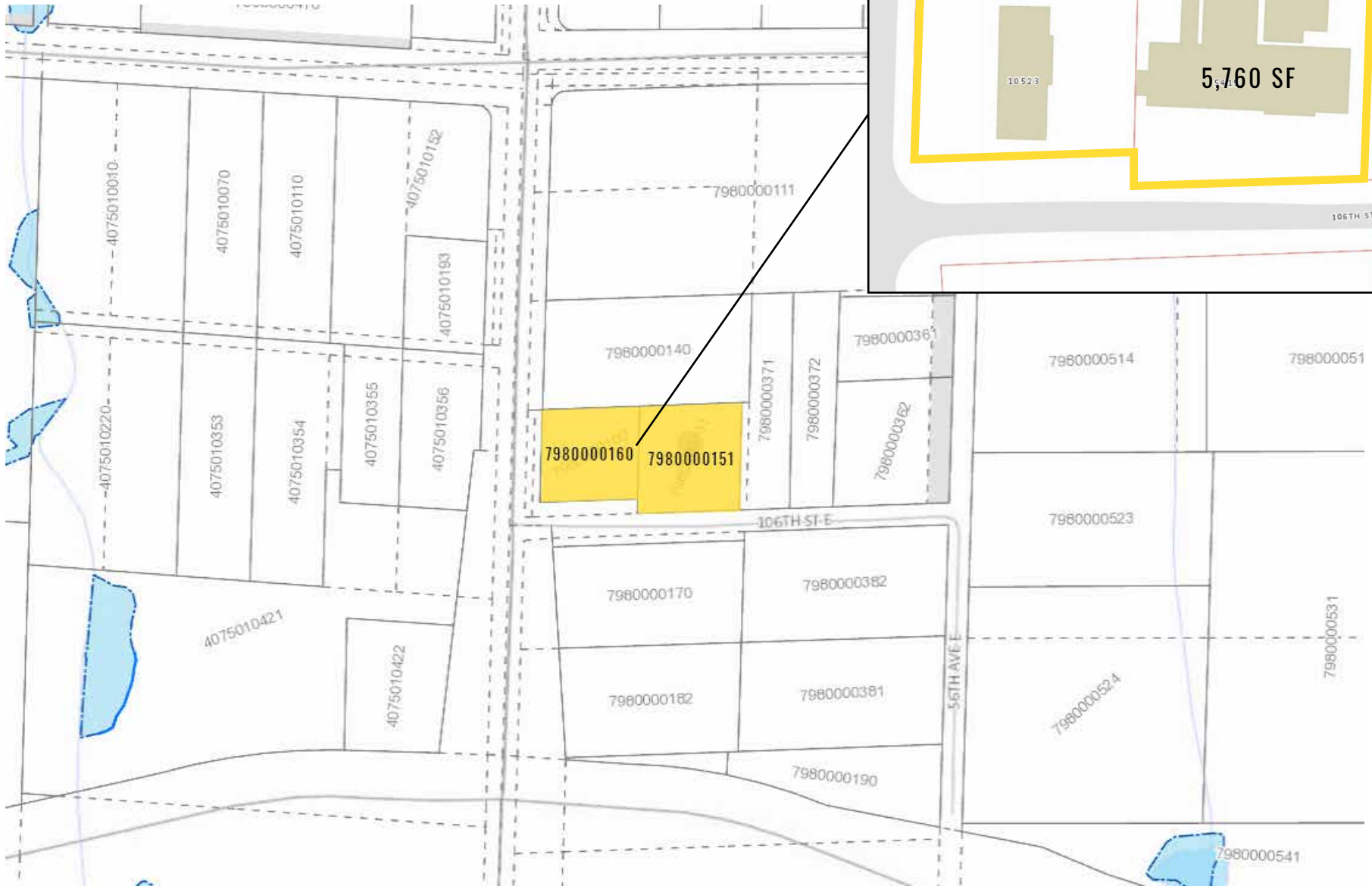

SITE PLAN

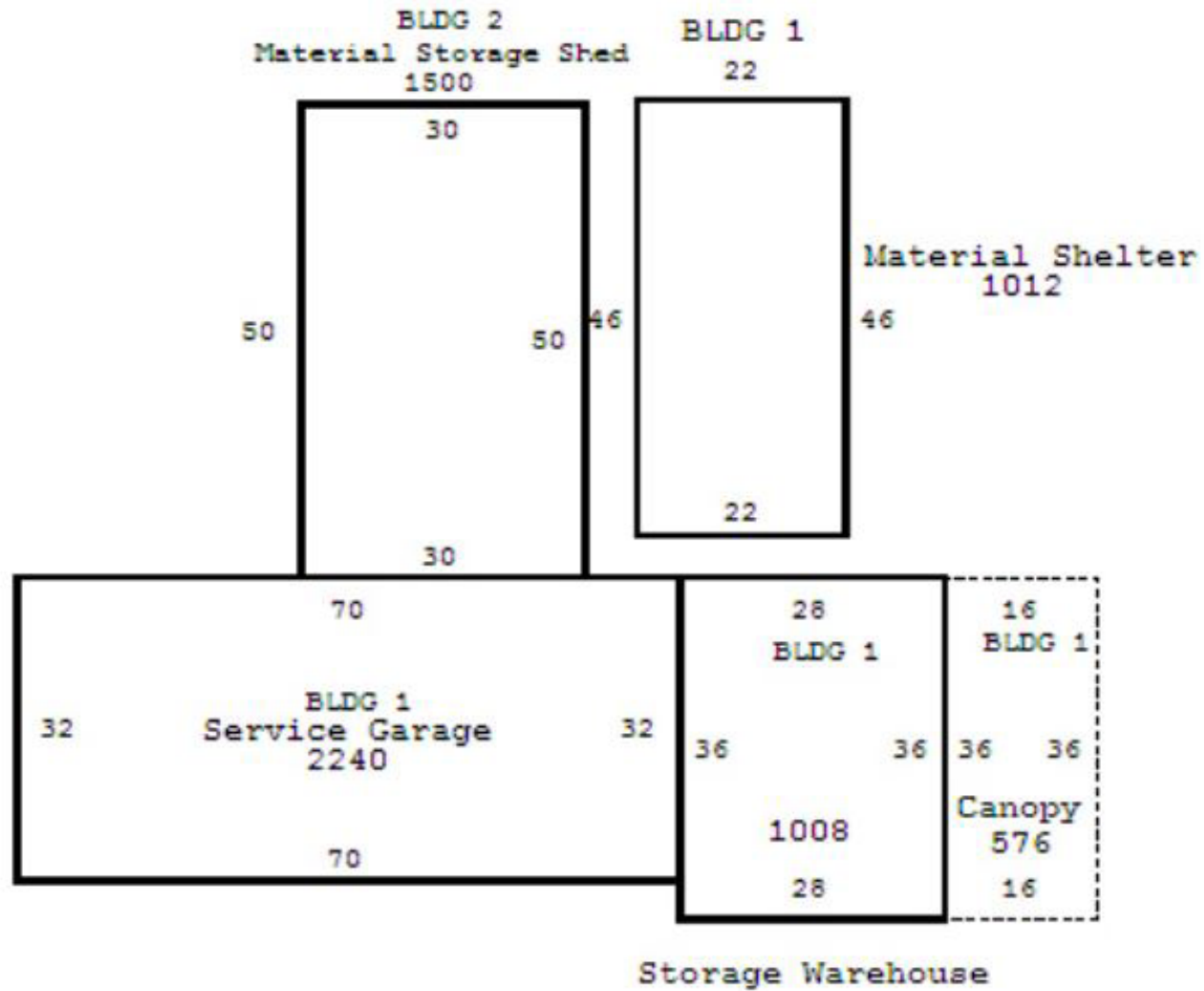

TACOMA | KIRKLAND | PORTLAND | SEATTLE



RELATIONSHIP FOCUSED. RESULTS DRIVEN.

TIM WEBER

253.471.5502
tweber@firstwesternproperties.com

DON WHITTLES

253.471.5509
dwhittles@firstwesternproperties.com

BLAKE WEBER

253.284.3646
bweber@firstwesternproperties.com



First Western Properties—Tacoma Inc. | 253.472.0404
6402 Tacoma Mall Blvd, Tacoma, WA 98409 | fwp-inc.com

© First Western Properties, Inc. DISCLAIMER: The above information has been secured from sources believed to be reliable, however, no representations are made to its accuracy. Prospective tenants or buyers should consult their professional advisors and conduct their own independent investigation. Properties are subject to change in price and/or availability without notice.