

Bridgeton Square

12109-12119 Bridgeton Square Drive

Bridgeton, MO 63044

**3,000-7,617 SF OFFICE / WAREHOUSE / SERVICE CENTER
AVAILABLE FOR LEASE**



- **4,617 SF Available**
- 12117 Bridgeton Square Drive
- 100% drop ceiling with 3,400 SF of production area
- Dock and drive-in

- **3,000 SF Available**
- 12119 Bridgeton Square Drive
- Endcap space with 100% office finish
- One grade level drive-in

- ***Spaces may be combined to achieve 7,617 SF***
- Located near the intersection of McKelvey Road and Bridgeland Drive (De Paul Drive)
- Within close proximity to SSM DePaul Health Center and other major medical and assisted living facilities
- Other area amenities include several dining, shopping and personal service establishments
- Convenient and easy access to I-270, I-70 and Lindbergh Blvd via St. Charles Rock Road
- **LEASE RATE: \$6.50-\$7.50 PSF MODIFIED GROSS**

HUTKIN DEVELOPMENT COMPANY

10829 Olive Boulevard
Suite 200
St. Louis, MO 63141

Telephone 314.872.9140
FAX 314.872.9001

Visit our website:
www.hutkin.com

CONTACT

Bo Keefer
bkeefer@hutkin.com
Cell 314.973.1242

Tony Giarratano
tony@hutkin.com
Cell 314.276.2352

Bridgeton Square

12109-12119 Bridgeton Square Drive

Bridgeton, MO 63044

**3,000-7,617 SF OFFICE / WAREHOUSE / SERVICE CENTER
AVAILABLE FOR LEASE**

12119 BRIDGETON SQUARE DR
3,000 SF

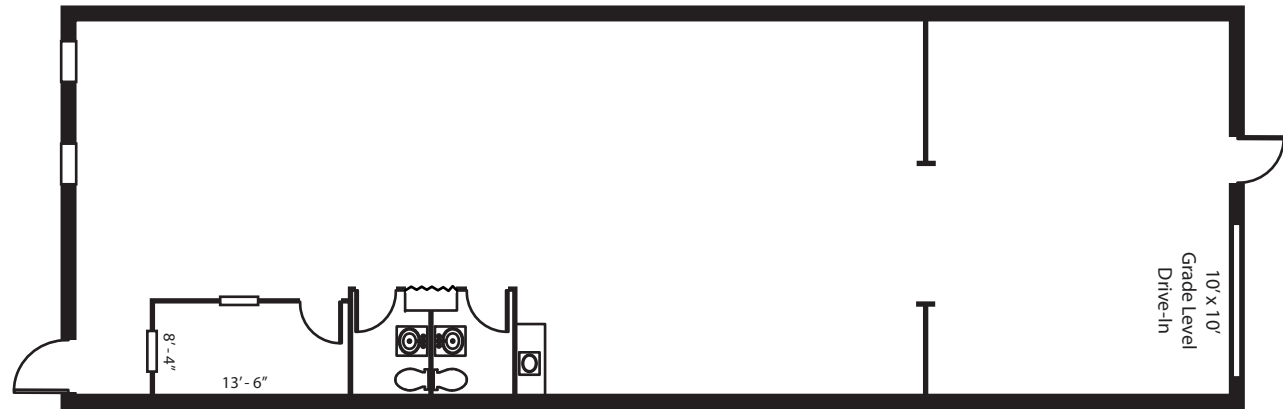

12117 BRIDGETON SQUARE DR
4,617 SF

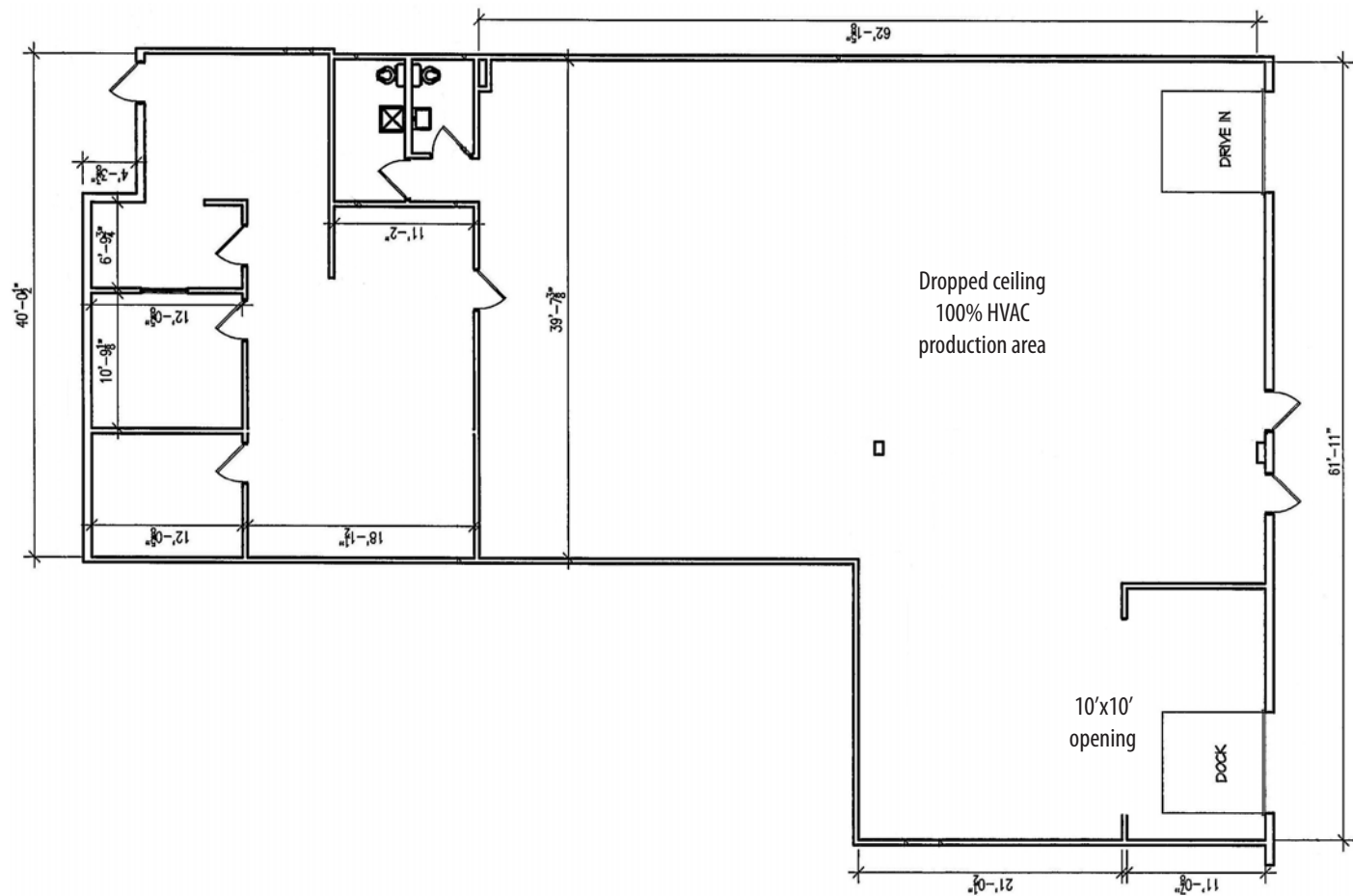

Bridgeton Square

12109-12119 Bridgeton Square Drive

Bridgeton, MO 63044

**3,000-7,617 SF OFFICE / WAREHOUSE / SERVICE CENTER
AVAILABLE FOR LEASE**

