



### BUILDING FEATURES

<b>Building Area</b>	573,899 SF
<b>Site Area</b>	32.33 AC
<b>Office Area</b>	4,000 SF
<b>DH Doors</b>	108 (9' x 10')
<b>GL Doors</b>	4 (12' x 14')
<b>Clear Height</b>	36' Minimum
<b>Bay Spacing</b>	56' X 60'
<b>Slab</b>	7" (@ 4,000 psi)
<b>Trailer Parking</b>	142
<b>Car Parking</b>	359
<b>Skylights</b>	3.0%
<b>Sprinklers</b>	ESFR (K-25)
<b>Truck Court</b>	185' & 185' (Crossdock Loading)
<b>Insulation</b>	White Scrim Foil
<b>Lighting</b>	LED 20' Candle @ 36" AFF
<b>Power</b>	2,000 Amp 277/480V (4,000A Exp.)

### PROJECT FEATURES

- MeredithInternationalCentre.com
- 3M Square Feet | 7 Buildings | 150 Acres
- THE Distribution Hub in the Inland Empire
- Located on I-10 Freeway
- Located at Ontario Int'l Airport
- 3.0 Miles to UPS and FedEx Hubs
- 3.5 Miles to I-15
- 50 Miles from the Ports of LA/Long Beach
- Built to LEED Certified Construction
- OntarioThinksBusiness.com

**SARES·REGIS** Group



Joseph L. McKay (DRE# 00976995)  
**Lee & Associates - Ontario**  
 Direct: 909.373.2914  
 Cell: 714.313.1452  
 Email: jmckay@lee-assoc.com

Chris G. Morrell (DRE# 01410974)  
**Lee & Associates - Ontario**  
 Direct: 909.373.2721  
 Cell: 949.278.9646  
 Email: cmorrell@lee-assoc.com

Michael Fine (DRE# 01735854)  
**Lee & Associates - Ontario**  
 Direct: 909.373.2917  
 Cell: 909.908.6069  
 Email: mfine@lee-assoc.com



**JAY STREET**

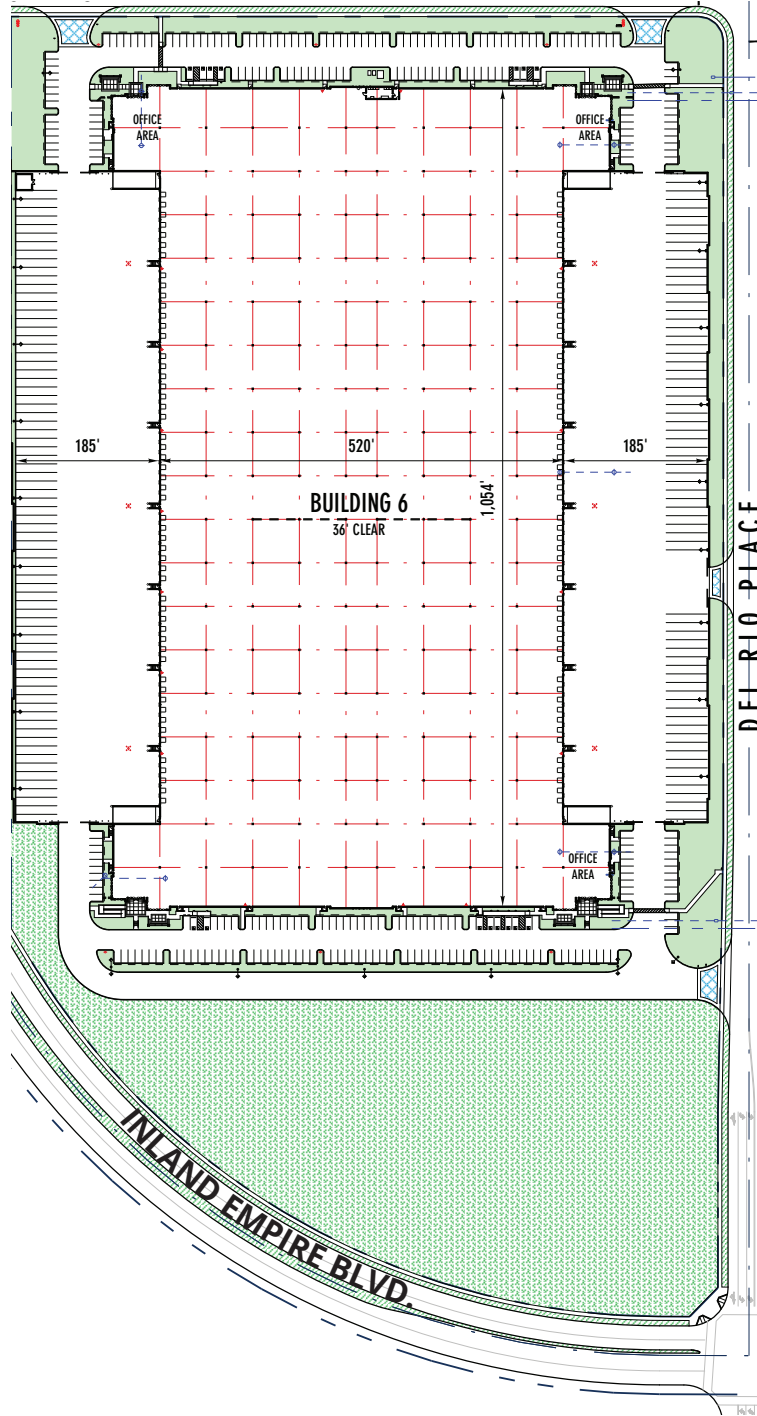

Joseph L. McKay (DRE# 00976995)  
**Lee & Associates - Ontario**  
 Direct: 909.373.2914  
 Cell: 714.313.1452  
 Email: jmckay@lee-assoc.com

Chris G. Morrell (DRE# 01410974)  
**Lee & Associates - Ontario**  
 Direct: 909.373.2721  
 Cell: 949.278.9646  
 Email: cmorrell@lee-assoc.com

Michael Fine (DRE# 01735854)  
**Lee & Associates - Ontario**  
 Direct: 909.373.2917  
 Cell: 909.908.6069  
 Email: mfine@lee-assoc.com