

For Lease

2,321-9,631 SF



## 2255 Stone Myers Parkway Grapevine, Texas 76051

### Property Features

- Flex/Showroom Space
- Convenient Access to DFW Airport, Highway 121 and Highway 360
- $\pm 18'$  Clear Height
- 1 Grade Level Door Per  $\pm 2,500$  SF Space
- 100% HVAC Capable
- 4.0/1000 Parking Ratio
- BTS Office

### Jeff Jackson

817 872 3910  
jjackson@robertlynn.com

### Colt Power, SIOR, CCIM

817 872 3905  
cpower@robertlynn.com

### Rob Kearney

817 872 3912  
rkearney@robertlynn.com



THE INFORMATION CONTAINED HEREIN HAS BEEN GIVEN TO US BY THE OWNER OF THE PROPERTY OR OTHER SOURCES WE DEEM RELIABLE. WE HAVE NO REASON TO DOUBT ITS ACCURACY, BUT WE DO NOT GUARANTEE IT. ALL INFORMATION SHOULD BE VERIFIED PRIOR TO PURCHASE OR LEASE.

1200 Summit Avenue Suite 800  
Fort Worth TX 76102  
817 885 8333

[nairl.com](http://nairl.com)

For Lease

2,321-9,631 SF

2255 Stone Myers Parkway

Grapevine, Texas 76051

Conceptual Floor Plan

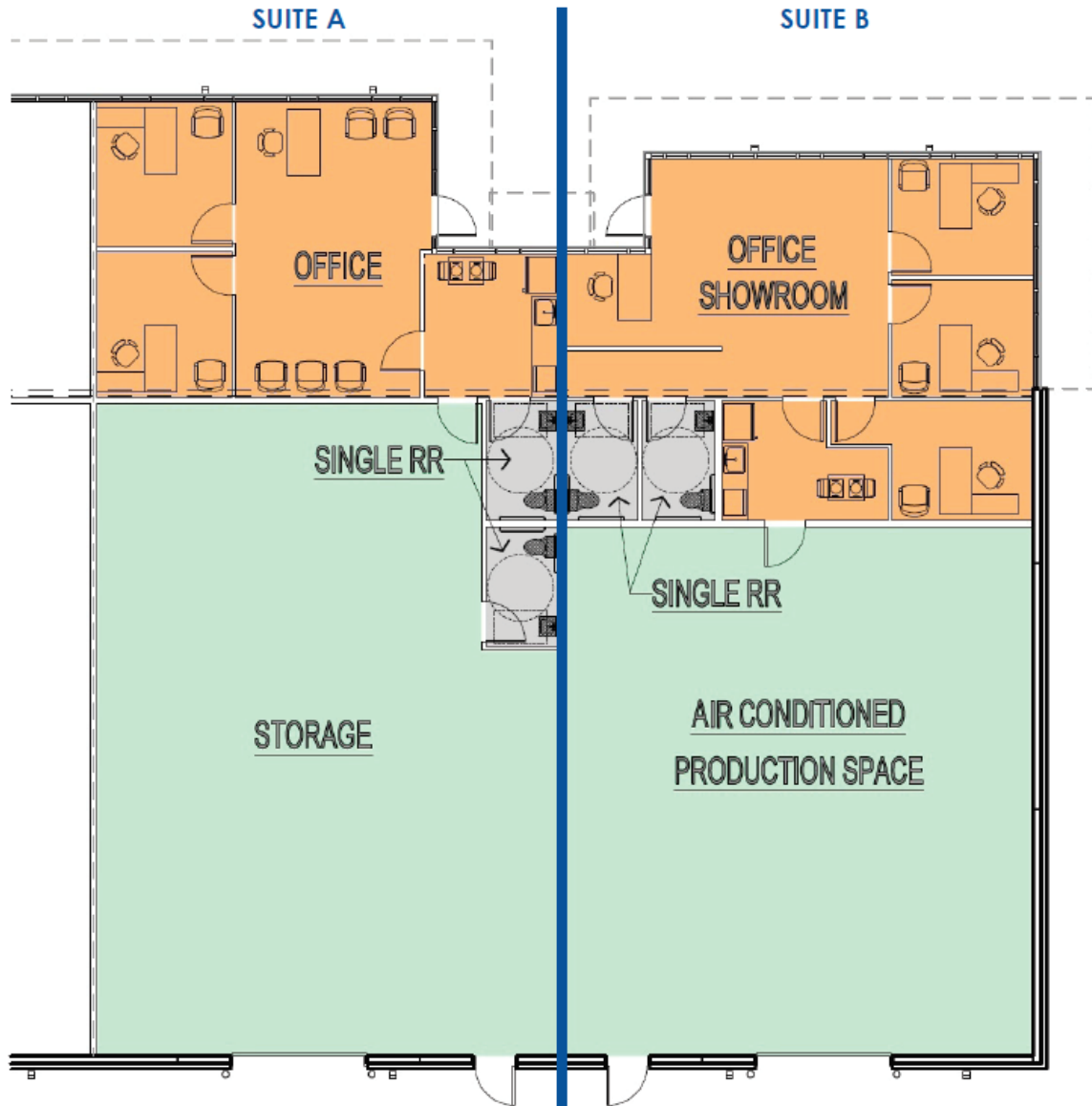

*All rental proceeds from the Plaza on Stone Myers development benefit the Gatehouse Project.*

**A Place & A Program**

The Gatehouse is a supportive living community where women - single or with children - in crisis receive safe refuge, ample time, practical resources and healthy relationships to discover new paths for permanent, positive change.

For Lease

2,321-9,631 SF

# 2255 Stone Myers Parkway

Grapevine, Texas 76051

## Site Plan

