

LAND For Sale

Location: 5174 Platt Road
Side of Street: West
City: Ann Arbor, MI
Cross Streets: SW of Platt Rd. & Morgan Rd.
County: Washtenaw

Acreage: 78.88 **Improvements:** N/A
Zoning: AG **Dimensions:**

UTILITIES

Sanitary Sewer: No **Gas:** No
Storm Sewer: No **Outside Storage:** No
Water: No **Rail Siding:** No

ADJACENT LAND

North: **East:**
South: **West:**

PRICING INFORMATION

Asking Price: \$5,514,000.00 **Parcel #:** L-12-22-100-001; 002
Per Acre: \$69,903.65 **Assessor Number:** N/A
Per SqFt : \$1.61 **Taxes:** \$12,514.60 (2022)

TRAFFIC INFORMATION

Yr: 2022 Count: 8,798 Platt Rd. N. of Michigan Ave.
Yr: 2022 Count: 5,031 Platt Rd. S. of Michigan Ave.
Yr: 2022 Count: 24,213 Michigan Ave. NE. of Platt Rd.
Yr: 2022 Count: 24,717 Michigan Ave. SW. of Platt Rd.

DEMOGRAPHICS

	Population	Median HH Income
1 Mile Radius	1,660	\$102,045
3 Mile Radius	42,920	\$92,239
5 Mile Radius	146,343	\$95,184

Comments: 78.88 acre two (2) parcels assemblage of 41.97 acres (L-12-22-100-001) and adjacent 36.91 acres (L-12-22-100-002). Zoned agricultural with potential to re-zone to residential. Easy expressway access. Located in Pittsfield Township with an Ann Arbor mailing address. Ann Arbor School District.

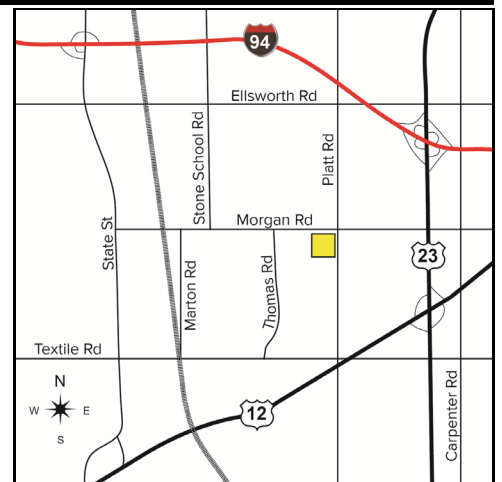

Broker: SIGNATURE ASSOCIATES

Agent(s):

Jay Chavey, (248) 948-4196, jchavey@signatureassociates.com