

Proposed
Remodel
Underway

MERIT PARK VILLAGE

NEC ALMA SCHOOL RD. & GUADALUPE RD.
MESA, AZ

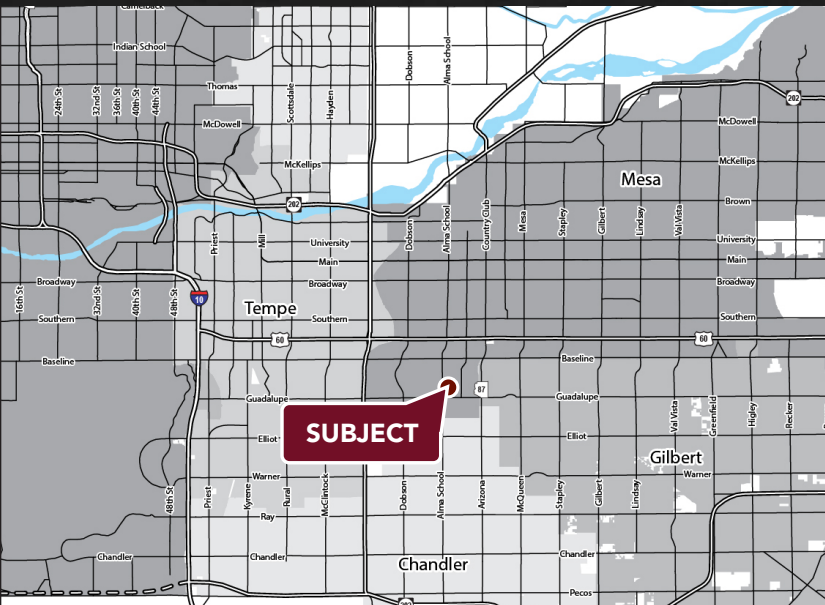
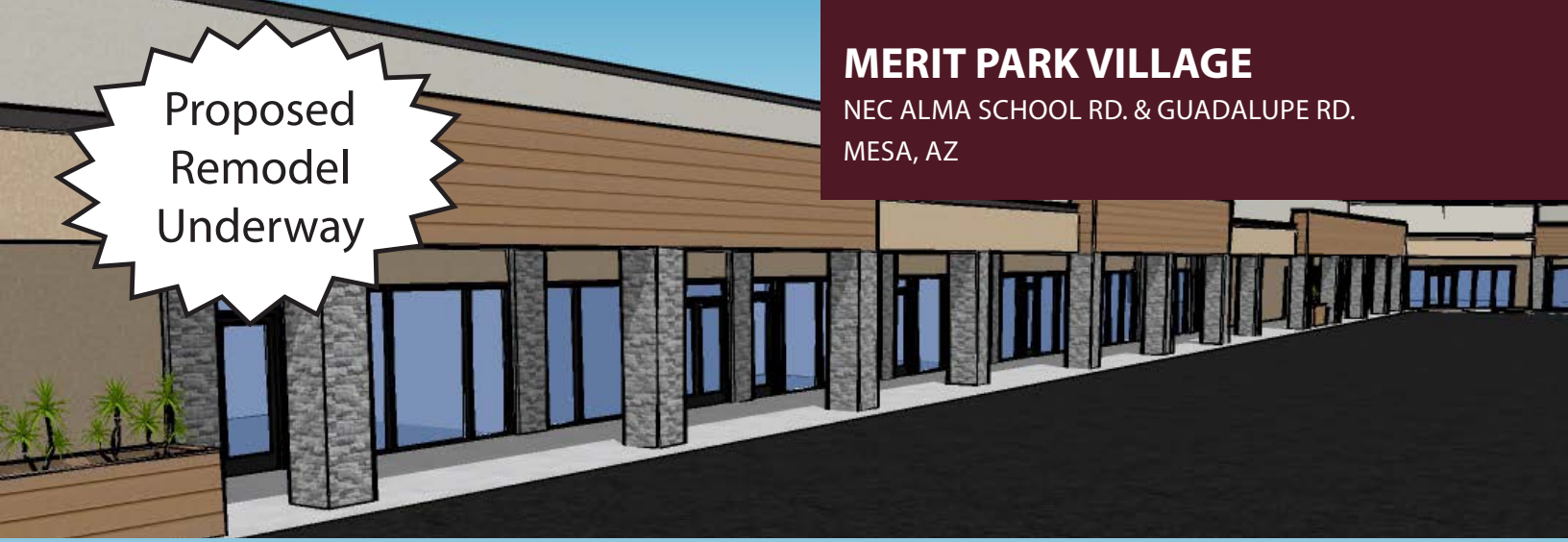

SHOP SPACE AVAILABLE

AVAILABILITY

COMBINED TOTAL OF 16,409 SF

- SUITE A3: 3,639 SF FORMER RESTAURANT
- SUITE A10: 1,013 SF FORMER DENTAL OFFICE

FEATURES

- Remodel Proposed Completion Mid 2019
- Below Market Rate
- Less than 2 miles from both the US 60 and Loop 101
- Available sign space on both existing monuments

NOTABLE TENANTS AT THE INTERSECTION



| 2018 Demographics | 1 MILE | 3 MILE | 5 MILE |
|----------------------|----------|----------|----------|
| Estimated Population | 16,601 | 142,394 | 426,839 |
| Ave Household Income | \$87,779 | \$75,719 | \$76,421 |
| Daytime Employment | 3,971 | 67,739 | 202,095 |



DAVID JARAND
602.778.3834
davidj@srgaz.com

MATT SCHRAUTH
602.778.3774
mschrauth@srgaz.com

SHOP SPACE AVAILABLE

MERIT PARK VILLAGE

NEC ALMA SCHOOL RD. & GUADALUPE RD.
MESA, AZ

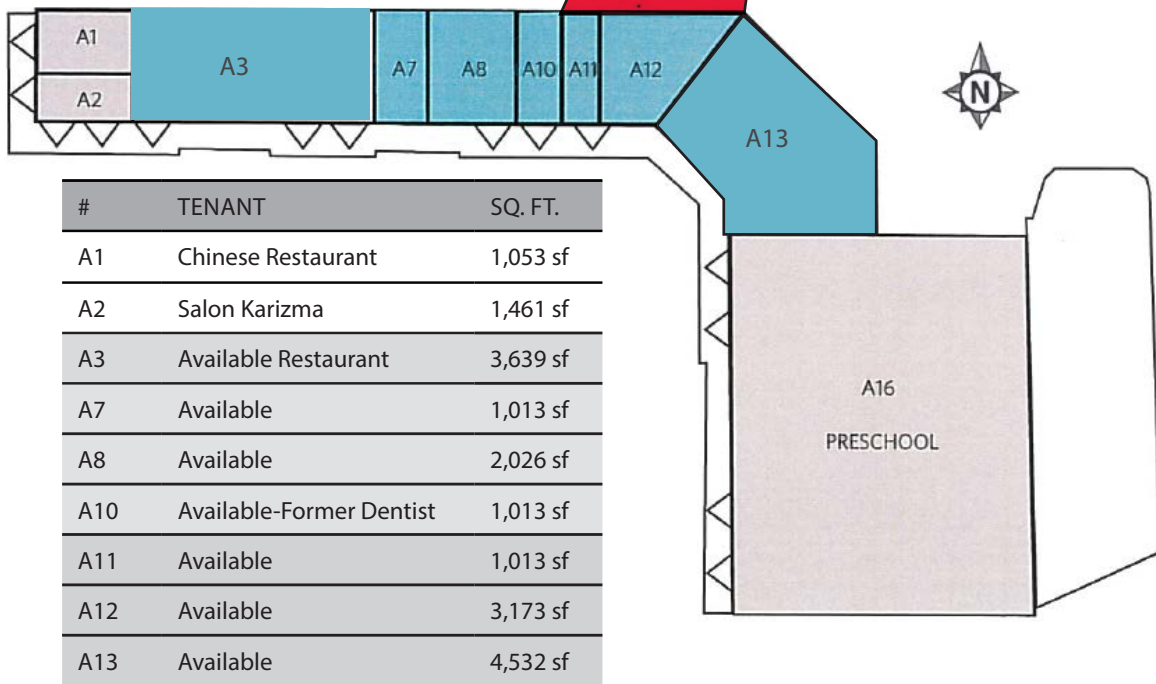

STRATEGIC

DAVID JARAND
602.778.3834
davidj@srgaz.com

MATT SCHRAUTH
602.778.3774
mschrauth@srgaz.com

EXPANDED PROFILE

2000-2010 Census, 2018 Estimates with 2023 Projections

Calculated using Weighted Block Centroid from Block Groups



Lat/Lon: 33.3642/-111.8591

RF5

S Alma School Rd & W Guadalupe Rd

Mesa, AZ 85210

1 mi radius

3 mi radius

5 mi radius

Population

| | | | |
|---|-------------------|--------------------|--------------------|
| Estimated Population (2018) | 16,601 | 142,394 | 426,839 |
| Projected Population (2023) | 18,026 | 155,245 | 466,440 |
| Census Population (2010) | 16,211 | 132,549 | 394,372 |
| Census Population (2000) | 18,402 | 137,189 | 409,943 |
| Projected Annual Growth (2018 to 2023) | 1,425 1.7% | 12,851 1.8% | 39,601 1.9% |
| Historical Annual Growth (2010 to 2018) | 390 0.3% | 9,845 0.9% | 32,467 1.0% |
| Historical Annual Growth (2000 to 2010) | -2,191 -1.2% | -4,640 -0.3% | -15,571 -0.4% |
| Estimated Population Density (2018) | 5,287 <i>psm</i> | 5,038 <i>psm</i> | 5,437 <i>psm</i> |
| Trade Area Size | 3.14 <i>sq mi</i> | 28.26 <i>sq mi</i> | 78.51 <i>sq mi</i> |

Households

| | | | |
|---|-------------|--------------|--------------|
| Estimated Households (2018) | 6,534 | 56,750 | 163,859 |
| Projected Households (2023) | 6,875 | 59,996 | 173,401 |
| Census Households (2010) | 6,304 | 52,446 | 149,996 |
| Census Households (2000) | 6,551 | 51,766 | 148,409 |
| Estimated Households with Children (2018) | 1,902 29.1% | 16,928 29.8% | 51,417 31.4% |
| Estimated Average Household Size (2018) | 2.53 | 2.49 | 2.59 |

Average Household Income

| | | | |
|---|-----------|----------|----------|
| Estimated Average Household Income (2018) | \$87,779 | \$75,719 | \$76,421 |
| Projected Average Household Income (2023) | \$99,392 | \$85,425 | \$86,816 |
| Estimated Average Family Income (2018) | \$101,345 | \$91,003 | \$91,483 |

Median Household Income

| | | | |
|--|----------|----------|----------|
| Estimated Median Household Income (2018) | \$71,452 | \$61,781 | \$61,476 |
| Projected Median Household Income (2023) | \$82,083 | \$70,729 | \$70,581 |
| Estimated Median Family Income (2018) | \$81,800 | \$75,970 | \$75,571 |

Per Capita Income

| | | | |
|--|--------------|--------------|---------------|
| Estimated Per Capita Income (2018) | \$34,604 | \$30,268 | \$29,400 |
| Projected Per Capita Income (2023) | \$37,957 | \$33,097 | \$32,332 |
| Estimated Per Capita Income 5 Year Growth | \$3,352 9.7% | \$2,828 9.3% | \$2,932 10.0% |
| Estimated Average Household Net Worth (2018) | \$738,942 | \$704,098 | \$735,214 |

Daytime Demos (2018)

| | | | |
|-------------------------------------|-------|------------|------------|
| Total Businesses | 509 | 6,839 | 19,559 |
| Total Employees | 3,971 | 67,739 | 202,095 |
| Company Headquarter Businesses | - | 35 0.5% | 84 0.4% |
| Company Headquarter Employees | - | 5,002 7.4% | 9,531 4.7% |
| Employee Population per Business | 7.8 | 9.9 | 10.3 |
| Residential Population per Business | 32.6 | 20.8 | 21.8 |

This report was produced using data from private and government sources deemed to be reliable. The information herein is provided without representation or warranty.

EXPANDED PROFILE

2000-2010 Census, 2018 Estimates with 2023 Projections

Calculated using Weighted Block Centroid from Block Groups



Lat/Lon: 33.3642/-111.8591

RF5

S Alma School Rd & W Guadalupe Rd

Mesa, AZ 85210

1 mi radius 3 mi radius 5 mi radius

Race & Ethnicity

| | | | | | | |
|---|--------|-------|---------|-------|---------|-------|
| White (2018) | 12,545 | 75.6% | 97,512 | 68.5% | 290,546 | 68.1% |
| Black or African American (2018) | 859 | 5.2% | 8,870 | 6.2% | 25,271 | 5.9% |
| American Indian or Alaska Native (2018) | 333 | 2.0% | 3,700 | 2.6% | 9,939 | 2.3% |
| Asian (2018) | 723 | 4.4% | 6,820 | 4.8% | 21,570 | 5.1% |
| Hawaiian or Pacific Islander (2018) | 92 | 0.6% | 603 | 0.4% | 1,558 | 0.4% |
| Other Race (2018) | 1,339 | 8.1% | 18,430 | 12.9% | 59,616 | 14.0% |
| Two or More Races (2018) | 710 | 4.3% | 6,459 | 4.5% | 18,337 | 4.3% |
| Not Hispanic or Latino Population (2018) | 13,062 | 78.7% | 100,878 | 70.8% | 291,187 | 68.2% |
| Hispanic or Latino Population (2018) | 3,539 | 21.3% | 41,516 | 29.2% | 135,652 | 31.8% |
| Not Hispanic or Latino Population (2023) | 13,872 | 77.0% | 107,588 | 69.3% | 311,216 | 66.7% |
| Hispanic or Latino Population (2023) | 4,154 | 23.0% | 47,657 | 30.7% | 155,224 | 33.3% |
| Not Hispanic or Latino Population (2010) | 13,248 | 81.7% | 96,638 | 72.9% | 272,937 | 69.2% |
| Hispanic or Latino Population (2010) | 2,963 | 18.3% | 35,911 | 27.1% | 121,434 | 30.8% |
| Not Hispanic or Latino Population (2000) | 15,940 | 86.6% | 109,970 | 80.2% | 310,314 | 75.7% |
| Hispanic or Latino Population (2000) | 2,462 | 13.4% | 27,219 | 19.8% | 99,629 | 24.3% |
| Projected Hispanic Annual Growth (2018 to 2023) | 615 | 3.5% | 6,141 | 3.0% | 19,572 | 2.9% |
| Historic Hispanic Annual Growth (2000 to 2018) | 1,077 | 2.4% | 14,297 | 2.9% | 36,022 | 2.0% |

Age Distribution (2018)

| | | | | | | |
|----------------------|-------|------|--------|------|--------|------|
| Age Under 5 | 907 | 5.5% | 9,336 | 6.6% | 28,635 | 6.7% |
| Age 5 to 9 Years | 953 | 5.7% | 8,678 | 6.1% | 27,420 | 6.4% |
| Age 10 to 14 Years | 1,082 | 6.5% | 8,950 | 6.3% | 28,001 | 6.6% |
| Age 15 to 19 Years | 1,092 | 6.6% | 9,357 | 6.6% | 29,109 | 6.8% |
| Age 20 to 24 Years | 1,062 | 6.4% | 11,232 | 7.9% | 37,060 | 8.7% |
| Age 25 to 29 Years | 1,310 | 7.9% | 12,825 | 9.0% | 38,737 | 9.1% |
| Age 30 to 34 Years | 1,184 | 7.1% | 10,958 | 7.7% | 32,075 | 7.5% |
| Age 35 to 39 Years | 1,127 | 6.8% | 9,572 | 6.7% | 28,435 | 6.7% |
| Age 40 to 44 Years | 1,063 | 6.4% | 8,837 | 6.2% | 26,070 | 6.1% |
| Age 45 to 49 Years | 1,219 | 7.3% | 9,468 | 6.6% | 28,041 | 6.6% |
| Age 50 to 54 Years | 1,199 | 7.2% | 9,333 | 6.6% | 27,170 | 6.4% |
| Age 55 to 59 Years | 1,370 | 8.3% | 9,300 | 6.5% | 25,906 | 6.1% |
| Age 60 to 64 Years | 1,093 | 6.6% | 7,695 | 5.4% | 21,220 | 5.0% |
| Age 65 to 74 Years | 1,264 | 7.6% | 10,008 | 7.0% | 28,780 | 6.7% |
| Age 75 to 84 Years | 495 | 3.0% | 4,632 | 3.3% | 13,944 | 3.3% |
| Age 85 Years or Over | 179 | 1.1% | 2,215 | 1.6% | 6,235 | 1.5% |
| Median Age | 37.4 | | 35.0 | | 33.8 | |

Gender Age Distribution (2018)

| | | | | | | |
|----------------------|-------|-------|--------|-------|---------|-------|
| Female Population | 8,421 | 50.7% | 71,559 | 50.3% | 213,126 | 49.9% |
| Age 0 to 19 Years | 1,997 | 23.7% | 17,803 | 24.9% | 55,369 | 26.0% |
| Age 20 to 64 Years | 5,365 | 63.7% | 44,265 | 61.9% | 130,283 | 61.1% |
| Age 65 Years or Over | 1,060 | 12.6% | 9,491 | 13.3% | 27,474 | 12.9% |
| Female Median Age | 38.2 | | 36.2 | | 34.9 | |
| Male Population | 8,180 | 49.3% | 70,835 | 49.7% | 213,713 | 50.1% |
| Age 0 to 19 Years | 2,039 | 24.9% | 18,518 | 26.1% | 57,797 | 27.0% |
| Age 20 to 64 Years | 5,263 | 64.3% | 44,955 | 63.5% | 134,431 | 62.9% |
| Age 65 Years or Over | 879 | 10.7% | 7,363 | 10.4% | 21,486 | 10.1% |
| Male Median Age | 36.7 | | 33.8 | | 32.7 | |

This report was produced using data from private and government sources deemed to be reliable. The information herein is provided without representation or warranty.

EXPANDED PROFILE

2000-2010 Census, 2018 Estimates with 2023 Projections

Calculated using Weighted Block Centroid from Block Groups



Lat/Lon: 33.3642/-111.8591

RF5

S Alma School Rd & W Guadalupe Rd

Mesa, AZ 85210

1 mi radius

3 mi radius

5 mi radius

Household Income Distribution (2018)

| | | | | | | |
|----------------------------------|-------|-------|--------|-------|---------|-------|
| HH Income \$200,000 or More | 214 | 3.3% | 2,296 | 4.0% | 8,296 | 5.1% |
| HH Income \$150,000 to \$199,999 | 401 | 6.1% | 3,213 | 5.7% | 9,176 | 5.6% |
| HH Income \$100,000 to \$149,999 | 1,181 | 18.1% | 7,728 | 13.6% | 22,051 | 13.5% |
| HH Income \$75,000 to \$99,999 | 1,252 | 19.2% | 7,879 | 13.9% | 21,216 | 12.9% |
| HH Income \$50,000 to \$74,999 | 1,370 | 21.0% | 11,554 | 20.4% | 31,414 | 19.2% |
| HH Income \$35,000 to \$49,999 | 880 | 13.5% | 8,769 | 15.5% | 23,126 | 14.1% |
| HH Income \$25,000 to \$34,999 | 523 | 8.0% | 5,672 | 10.0% | 15,861 | 9.7% |
| HH Income \$15,000 to \$24,999 | 298 | 4.6% | 4,481 | 7.9% | 14,450 | 8.8% |
| HH Income Under \$15,000 | 417 | 6.4% | 5,158 | 9.1% | 18,270 | 11.1% |
| HH Income \$35,000 or More | 5,297 | 81.1% | 41,439 | 73.0% | 115,279 | 70.4% |
| HH Income \$75,000 or More | 3,047 | 46.6% | 21,115 | 37.2% | 60,739 | 37.1% |

Housing (2018)

| | | | | | | |
|--------------------------------|-------|-------|--------|-------|---------|-------|
| Total Housing Units | 6,712 | | 58,761 | | 169,633 | |
| Housing Units Occupied | 6,534 | 97.4% | 56,750 | 96.6% | 163,859 | 96.6% |
| Housing Units Owner-Occupied | 4,641 | 71.0% | 30,717 | 54.1% | 83,754 | 51.1% |
| Housing Units, Renter-Occupied | 1,893 | 29.0% | 26,033 | 45.9% | 80,105 | 48.9% |
| Housing Units, Vacant | 178 | 2.6% | 2,011 | 3.4% | 5,774 | 3.4% |

Marital Status (2018)

| | | | | | | |
|-------------------|-------|-------|--------|-------|---------|-------|
| Never Married | 4,598 | 33.7% | 45,320 | 39.3% | 140,965 | 41.1% |
| Currently Married | 6,319 | 46.3% | 45,389 | 39.3% | 131,293 | 38.3% |
| Separated | 512 | 3.7% | 4,597 | 4.0% | 14,849 | 4.3% |
| Widowed | 410 | 3.0% | 4,671 | 4.0% | 13,379 | 3.9% |
| Divorced | 1,820 | 13.3% | 15,455 | 13.4% | 42,297 | 12.3% |

Household Type (2018)

| | | | | | | |
|-------------------------------|--------|-------|---------|-------|---------|-------|
| Population Family | 13,377 | 80.6% | 110,307 | 77.5% | 332,141 | 77.8% |
| Population Non-Family | 3,149 | 19.0% | 30,998 | 21.8% | 92,242 | 21.6% |
| Population Group Quarters | 75 | 0.5% | 1,089 | 0.8% | 2,456 | 0.6% |
| Family Households | 4,258 | 65.2% | 33,877 | 59.7% | 98,401 | 60.1% |
| Non-Family Households | 2,276 | 34.8% | 22,873 | 40.3% | 65,458 | 39.9% |
| Married Couple with Children | 1,152 | 18.2% | 9,472 | 20.9% | 29,664 | 22.6% |
| Average Family Household Size | 3.1 | | 3.3 | | 3.4 | |

Household Size (2018)

| | | | | | | |
|-----------------------------|-------|-------|--------|-------|--------|-------|
| 1 Person Households | 1,630 | 24.9% | 16,693 | 29.4% | 46,009 | 28.1% |
| 2 Person Households | 2,299 | 35.2% | 18,218 | 32.1% | 51,131 | 31.2% |
| 3 Person Households | 1,158 | 17.7% | 9,219 | 16.2% | 26,303 | 16.1% |
| 4 Person Households | 823 | 12.6% | 6,682 | 11.8% | 20,438 | 12.5% |
| 5 Person Households | 359 | 5.5% | 3,419 | 6.0% | 10,883 | 6.6% |
| 6 or More Person Households | 266 | 4.1% | 2,520 | 4.4% | 9,095 | 5.6% |

Household Vehicles (2018)

| | | | | | | |
|--|--------|-------|---------|-------|---------|-------|
| Households with 0 Vehicles Available | 176 | 2.7% | 2,845 | 5.0% | 11,437 | 7.0% |
| Households with 1 Vehicles Available | 2,336 | 35.8% | 21,518 | 37.9% | 61,018 | 37.2% |
| Households with 2 or More Vehicles Available | 4,022 | 61.6% | 32,387 | 57.1% | 91,405 | 55.8% |
| Total Vehicles Available | 12,221 | | 100,967 | | 287,170 | |
| Average Vehicles Per Household | 1.9 | | 1.8 | | 1.8 | |

This report was produced using data from private and government sources deemed to be reliable. The information herein is provided without representation or warranty.

EXPANDED PROFILE

2000-2010 Census, 2018 Estimates with 2023 Projections

Calculated using Weighted Block Centroid from Block Groups



Lat/Lon: 33.3642/-111.8591

RF5

| S Alma School Rd & W Guadalupe Rd Mesa, AZ 85210 | 1 mi radius | 3 mi radius | 5 mi radius |
|---|----------------|----------------|----------------|
| Labor Force (2018) | | | |
| Estimated Labor Population Age 16 Years or Over | 13,442 | 113,682 | 337,582 |
| Estimated Civilian Employed | 9,477 70.5% | 78,057 68.7% | 229,676 68.0% |
| Estimated Civilian Unemployed | 429 3.2% | 3,483 3.1% | 9,243 2.7% |
| Estimated in Armed Forces | 3 - | 93 0.1% | 220 0.1% |
| Estimated Not in Labor Force | 3,533 26.3% | 32,048 28.2% | 98,443 29.2% |
| Unemployment Rate | 3.2% | 3.1% | 2.7% |
| Occupation (2015) | | | |
| Occupation: Population Age 16 Years or Over | 9,774 | 78,028 | 230,016 |
| Management, Business, Financial Operations | 1,563 16.0% | 11,307 14.5% | 33,475 14.6% |
| Professional, Related | 2,553 26.1% | 17,813 22.8% | 53,054 23.1% |
| Service | 1,515 15.5% | 14,376 18.4% | 44,491 19.3% |
| Sales, Office | 2,673 27.3% | 21,070 27.0% | 59,952 26.1% |
| Farming, Fishing, Forestry | 18 0.2% | 148 0.2% | 444 0.2% |
| Construct, Extraction, Maintenance | 684 7.0% | 6,232 8.0% | 17,663 7.7% |
| Production, Transport Material Moving | 767 7.9% | 7,082 9.1% | 20,937 9.1% |
| White Collar Workers | 6,790 69.5% | 50,191 64.3% | 146,481 63.7% |
| Blue Collar Workers | 2,984 30.5% | 27,837 35.7% | 83,534 36.3% |
| Consumer Expenditure (2018) | | | |
| Total Household Expenditure | \$422 M | \$3.28 B | \$9.48 B |
| Total Non-Retail Expenditure | \$218 M 51.6% | \$1.70 B 51.8% | \$4.93 B 51.9% |
| Total Retail Expenditure | \$204 M 48.4% | \$1.58 B 48.2% | \$4.56 B 48.1% |
| Apparel | \$14.7 M 3.5% | \$115 M 3.5% | \$333 M 3.5% |
| Contributions | \$18.0 M 4.3% | \$140 M 4.3% | \$413 M 4.4% |
| Education | \$15.4 M 3.6% | \$119 M 3.6% | \$354 M 3.7% |
| Entertainment | \$23.8 M 5.6% | \$184 M 5.6% | \$532 M 5.6% |
| Food and Beverages | \$61.9 M 14.7% | \$483 M 14.7% | \$1.39 B 14.7% |
| Furnishings and Equipment | \$14.8 M 3.5% | \$113 M 3.4% | \$326 M 3.4% |
| Gifts | \$10.4 M 2.5% | \$80.4 M 2.5% | \$235 M 2.5% |
| Health Care | \$33.5 M 7.9% | \$263 M 8.0% | \$754 M 8.0% |
| Household Operations | \$12.1 M 2.9% | \$92.8 M 2.8% | \$272 M 2.9% |
| Miscellaneous Expenses | \$6.22 M 1.5% | \$48.5 M 1.5% | \$140 M 1.5% |
| Personal Care | \$5.50 M 1.3% | \$42.6 M 1.3% | \$123 M 1.3% |
| Personal Insurance | \$3.12 M 0.7% | \$24.1 M 0.7% | \$70.6 M 0.7% |
| Reading | \$940 K 0.2% | \$7.28 M 0.2% | \$21.0 M 0.2% |
| Shelter | \$86.4 M 20.5% | \$672 M 20.5% | \$1.95 B 20.5% |
| Tobacco | \$2.54 M 0.6% | \$20.3 M 0.6% | \$57.8 M 0.6% |
| Transportation | \$81.2 M 19.2% | \$626 M 19.1% | \$1.80 B 18.9% |
| Utilities | \$31.5 M 7.5% | \$248 M 7.6% | \$714 M 7.5% |
| Educational Attainment (2018) | | | |
| Adult Population Age 25 Years or Over | 11,503 | 94,842 | 276,614 |
| Elementary (Grade Level 0 to 8) | 358 3.1% | 5,036 5.3% | 16,227 5.9% |
| Some High School (Grade Level 9 to 11) | 627 5.4% | 6,126 6.5% | 18,761 6.8% |
| High School Graduate | 2,241 19.5% | 20,380 21.5% | 57,577 20.8% |
| Some College | 3,120 27.1% | 24,939 26.3% | 69,697 25.2% |
| Associate Degree Only | 1,194 10.4% | 8,674 9.1% | 24,635 8.9% |
| Bachelor Degree Only | 2,705 23.5% | 19,522 20.6% | 57,248 20.7% |
| Graduate Degree | 1,259 10.9% | 10,166 10.7% | 32,468 11.7% |

This report was produced using data from private and government sources deemed to be reliable. The information herein is provided without representation or warranty.

EXPANDED PROFILE

2000-2010 Census, 2018 Estimates with 2023 Projections

Calculated using Weighted Block Centroid from Block Groups



Lat/Lon: 33.3642/-111.8591

RF5

S Alma School Rd & W Guadalupe Rd

Mesa, AZ 85210

1 mi radius

3 mi radius

5 mi radius

Units In Structure (2015)

| | | | | | | |
|------------------------|-------|-------|--------|-------|--------|-------|
| 1 Detached Unit | 5,020 | 79.6% | 33,158 | 63.2% | 94,435 | 63.0% |
| 1 Attached Unit | 268 | 4.2% | 3,333 | 6.4% | 9,681 | 6.5% |
| 2 to 4 Units | 278 | 4.4% | 3,541 | 6.8% | 11,463 | 7.6% |
| 5 to 9 Units | 278 | 4.4% | 4,282 | 8.2% | 12,582 | 8.4% |
| 10 to 19 Units | 480 | 7.6% | 5,457 | 10.4% | 15,396 | 10.3% |
| 20 to 49 Units | 81 | 1.3% | 1,810 | 3.5% | 5,703 | 3.8% |
| 50 or More Units | 253 | 4.0% | 3,573 | 6.8% | 10,789 | 7.2% |
| Mobile Home or Trailer | 73 | 1.2% | 1,532 | 2.9% | 3,976 | 2.7% |
| Other Structure | 2 | - | 57 | 0.1% | 111 | 0.1% |

Homes Built By Year (2015)

| | | | | | | |
|---------------------------|-------|-------|--------|-------|--------|-------|
| Homes Built 2010 or later | 79 | 1.3% | 736 | 1.4% | 2,234 | 1.5% |
| Homes Built 2000 to 2009 | 327 | 5.2% | 4,969 | 9.5% | 15,781 | 10.5% |
| Homes Built 1990 to 1999 | 749 | 11.9% | 9,267 | 17.7% | 33,286 | 22.2% |
| Homes Built 1980 to 1989 | 2,570 | 40.8% | 17,936 | 34.2% | 43,379 | 28.9% |
| Homes Built 1970 to 1979 | 2,728 | 43.3% | 18,484 | 35.2% | 42,179 | 28.1% |
| Homes Built 1960 to 1969 | 133 | 2.1% | 3,019 | 5.8% | 14,469 | 9.6% |
| Homes Built 1950 to 1959 | 53 | 0.8% | 981 | 1.9% | 6,697 | 4.5% |
| Homes Built Before 1949 | 34 | 0.5% | 595 | 1.1% | 3,092 | 2.1% |

Home Values (2015)

| | | | | | | |
|------------------------------------|-----------|-------|-----------|-------|-----------|-------|
| Home Values \$1,000,000 or More | 27 | 0.6% | 170 | 0.6% | 538 | 0.7% |
| Home Values \$500,000 to \$999,999 | 188 | 4.1% | 1,439 | 4.8% | 4,902 | 6.1% |
| Home Values \$400,000 to \$499,999 | 195 | 4.2% | 1,511 | 5.1% | 4,914 | 6.1% |
| Home Values \$300,000 to \$399,999 | 479 | 10.4% | 3,663 | 12.3% | 11,640 | 14.4% |
| Home Values \$200,000 to \$299,999 | 1,791 | 38.9% | 10,533 | 35.4% | 27,340 | 33.9% |
| Home Values \$150,000 to \$199,999 | 1,128 | 24.5% | 6,418 | 21.5% | 16,917 | 21.0% |
| Home Values \$100,000 to \$149,999 | 544 | 11.8% | 3,656 | 12.3% | 9,319 | 11.6% |
| Home Values \$70,000 to \$99,999 | 162 | 3.5% | 1,243 | 4.2% | 3,240 | 4.0% |
| Home Values \$50,000 to \$69,999 | 75 | 1.6% | 465 | 1.6% | 1,275 | 1.6% |
| Home Values \$25,000 to \$49,999 | 48 | 1.0% | 371 | 1.2% | 853 | 1.1% |
| Home Values Under \$25,000 | 77 | 1.7% | 1,064 | 3.6% | 2,449 | 3.0% |
| Owner-Occupied Median Home Value | \$215,887 | | \$215,798 | | \$229,133 | |
| Renter-Occupied Median Rent | \$973 | | \$862 | | \$866 | |

Transportation To Work (2015)

| | | | | | | |
|---|-------|-------|--------|-------|---------|-------|
| Drive to Work Alone | 6,548 | 79.9% | 52,790 | 77.3% | 157,186 | 76.4% |
| Drive to Work in Carpool | 826 | 10.1% | 7,537 | 11.0% | 22,826 | 11.1% |
| Travel to Work by Public Transportation | 80 | 1.0% | 1,650 | 2.4% | 5,827 | 2.8% |
| Drive to Work on Motorcycle | 93 | 1.1% | 397 | 0.6% | 1,185 | 0.6% |
| Walk or Bicycle to Work | 210 | 2.6% | 1,723 | 2.5% | 6,598 | 3.2% |
| Other Means | 67 | 0.8% | 848 | 1.2% | 2,347 | 1.1% |
| Work at Home | 368 | 4.5% | 3,366 | 4.9% | 9,662 | 4.7% |

Travel Time (2015)

| | | | | | | |
|--------------------------------------|-------|-------|--------|-------|--------|-------|
| Travel to Work in 14 Minutes or Less | 2,116 | 27.0% | 18,168 | 28.0% | 55,740 | 28.4% |
| Travel to Work in 15 to 29 Minutes | 4,565 | 58.3% | 34,419 | 53.0% | 98,587 | 50.3% |
| Travel to Work in 30 to 59 Minutes | 2,202 | 28.1% | 17,564 | 27.0% | 53,498 | 27.3% |
| Travel to Work in 60 Minutes or More | 440 | 5.6% | 3,944 | 6.1% | 11,098 | 5.7% |
| Average Minutes Travel to Work | 20.6 | | 20.4 | | 20.8 | |

This report was produced using data from private and government sources deemed to be reliable. The information herein is provided without representation or warranty.