

Typical Plan | Floors 2-6



Brian S. Waterman
Vice Chairman
(212) 372-2299
bwaterman@ngkf.com

Paul V. Ippolito
Executive Vice President
(212) 372-2360
pippolito@ngkf.com

Staci L. Goodman
Associate Director
(212) 372-2089
sgoodman@ngkf.com

Typical Plan | Floors 7-10



Brian S. Waterman
Vice Chairman
(212) 372-2299
bwaterman@ngkf.com

Paul V. Ippolito
Executive Vice President
(212) 372-2360
pippolito@ngkf.com

Staci L. Goodman
Associate Director
(212) 372-2089
sgoodman@ngkf.com

Typical Plan | Floors 11-15

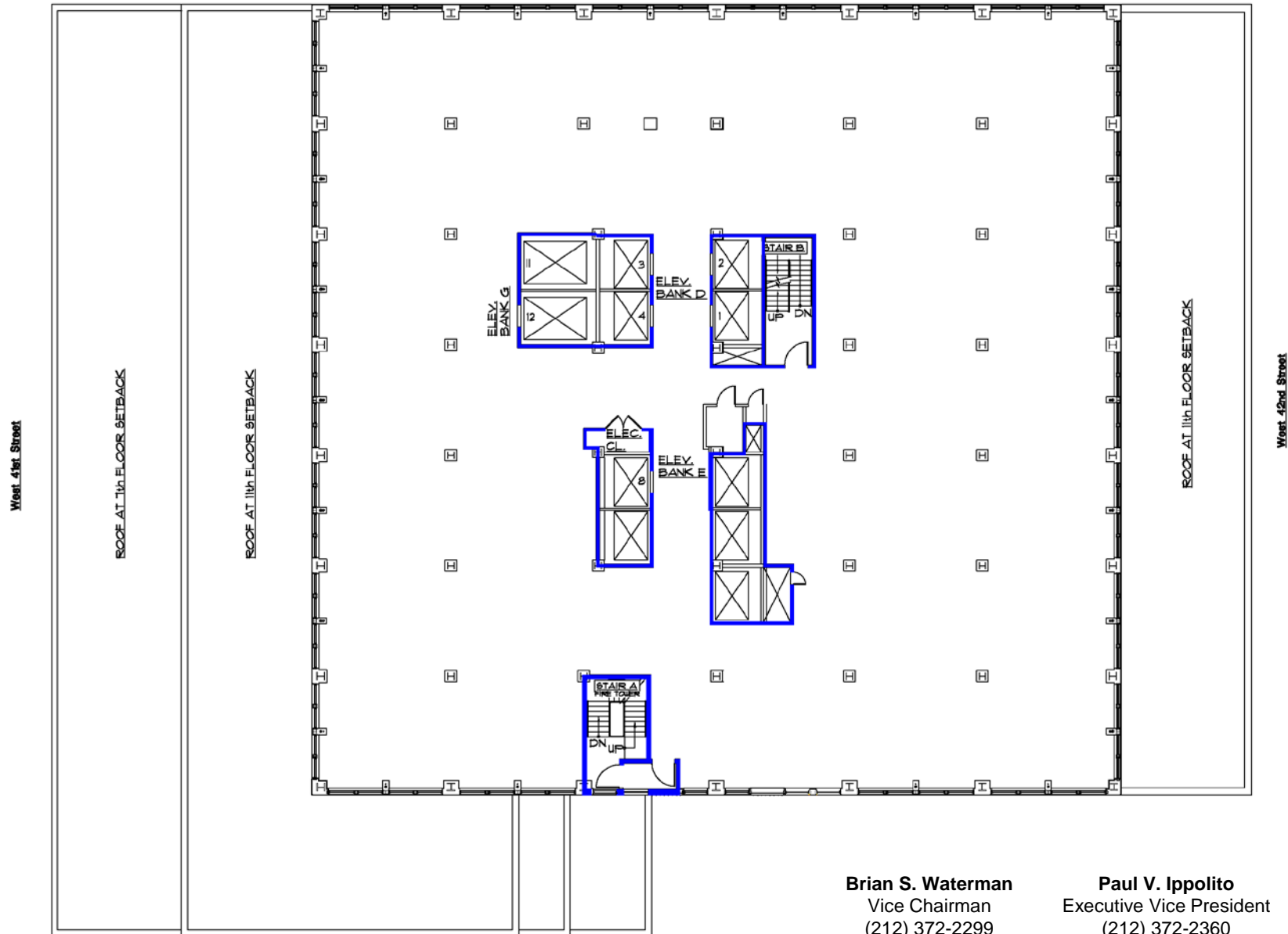

Brian S. Waterman
Vice Chairman
(212) 372-2299
bwateman@ngkf.com

Paul V. Ippolito
Executive Vice President
(212) 372-2360
pippolito@ngkf.com

Staci L. Goodman
Associate Director
(212) 372-2089
sgoodman@ngkf.com

Typical Plan | Floors 16-31

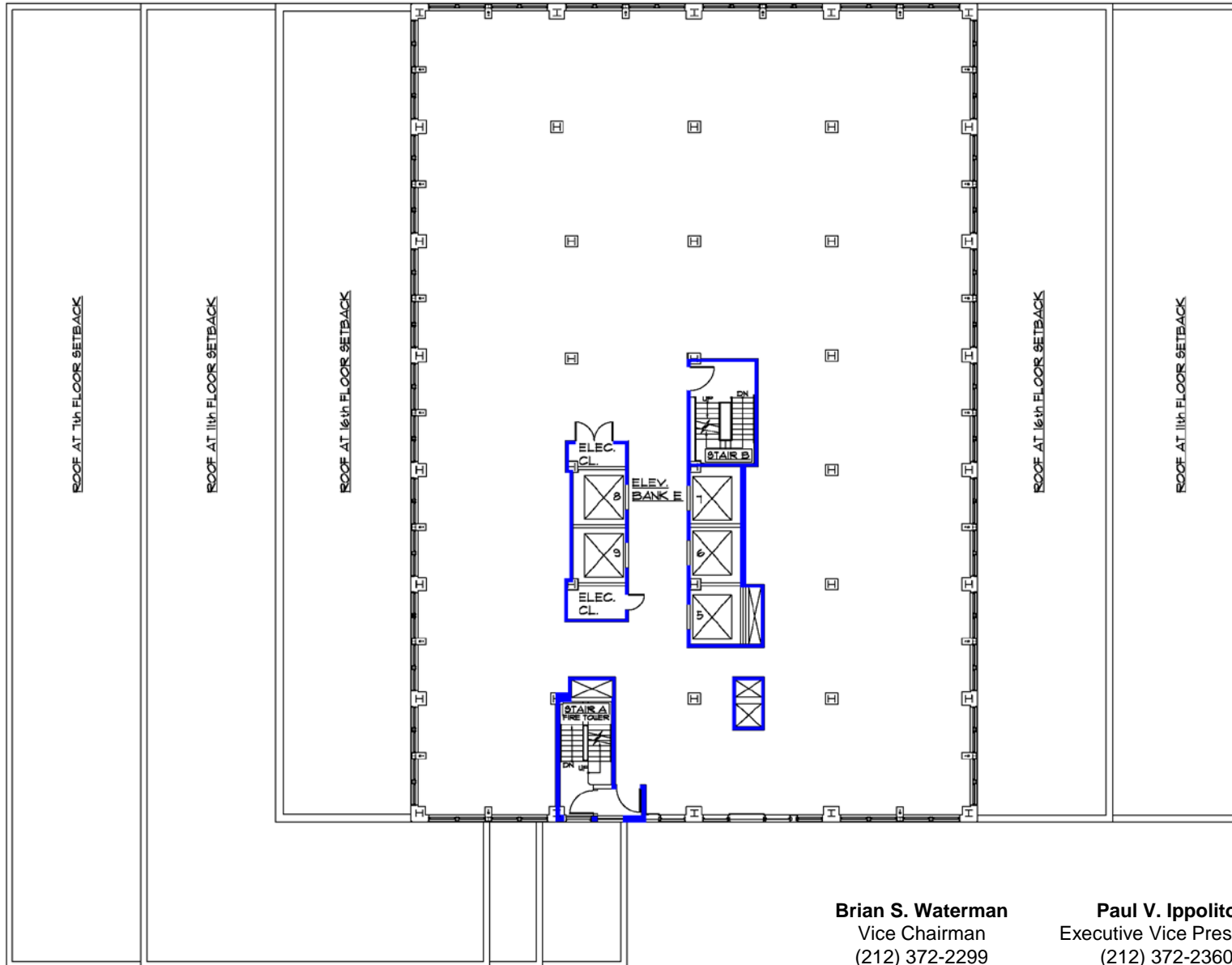

Brian S. Waterman
Vice Chairman
(212) 372-2299
bwateman@ngkf.com

Paul V. Ippolito
Executive Vice President
(212) 372-2360
pippolito@ngkf.com

Staci L. Goodman
Associate Director
(212) 372-2089
sgoodman@ngkf.com

Typical Plan | Floors 32-33

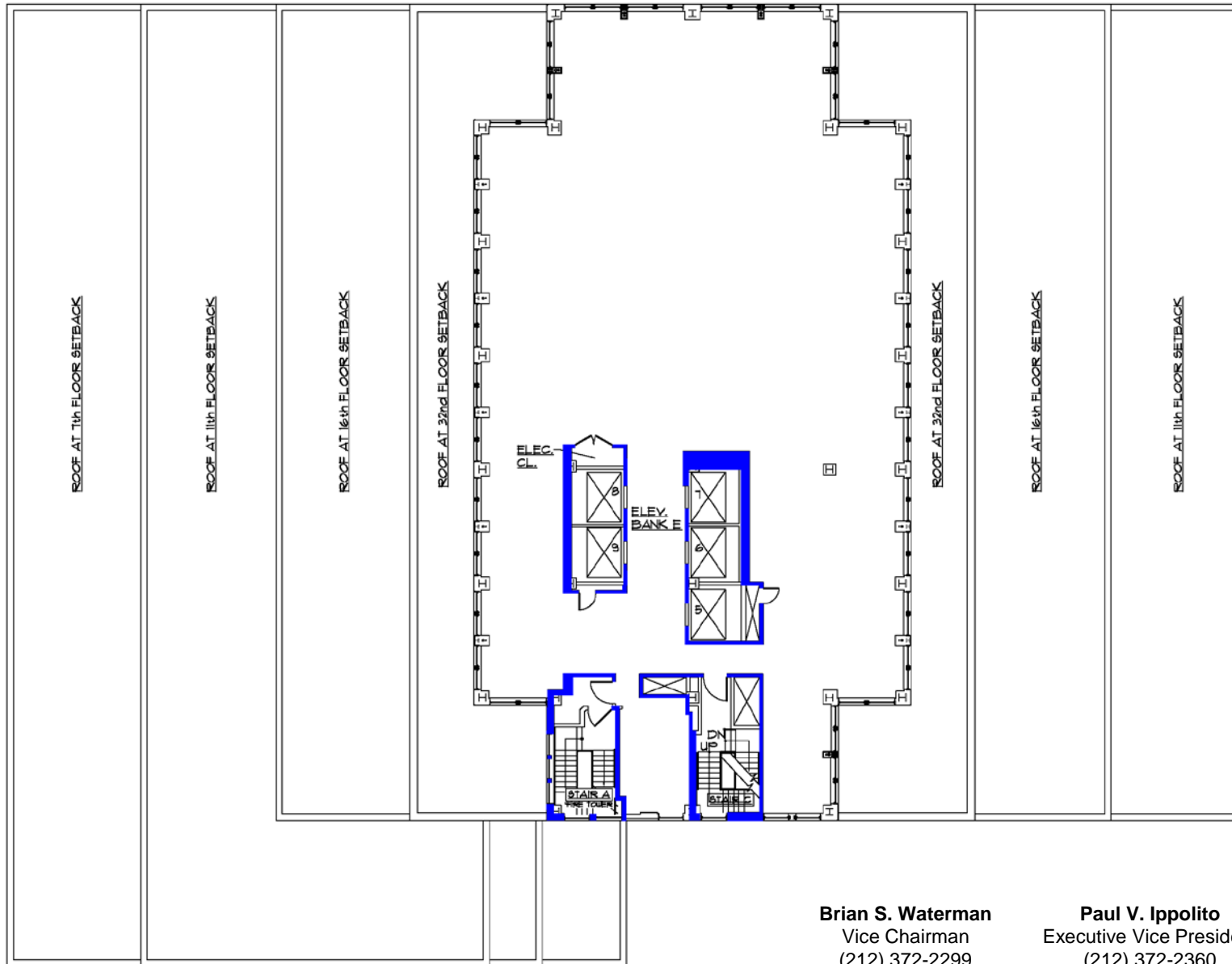

Brian S. Waterman
Vice Chairman
(212) 372-2299
bwaterman@ngkf.com

Paul V. Ippolito
Executive Vice President
(212) 372-2360
pippolito@ngkf.com

Staci L. Goodman
Associate Director
(212) 372-2089
sgoodman@ngkf.com