

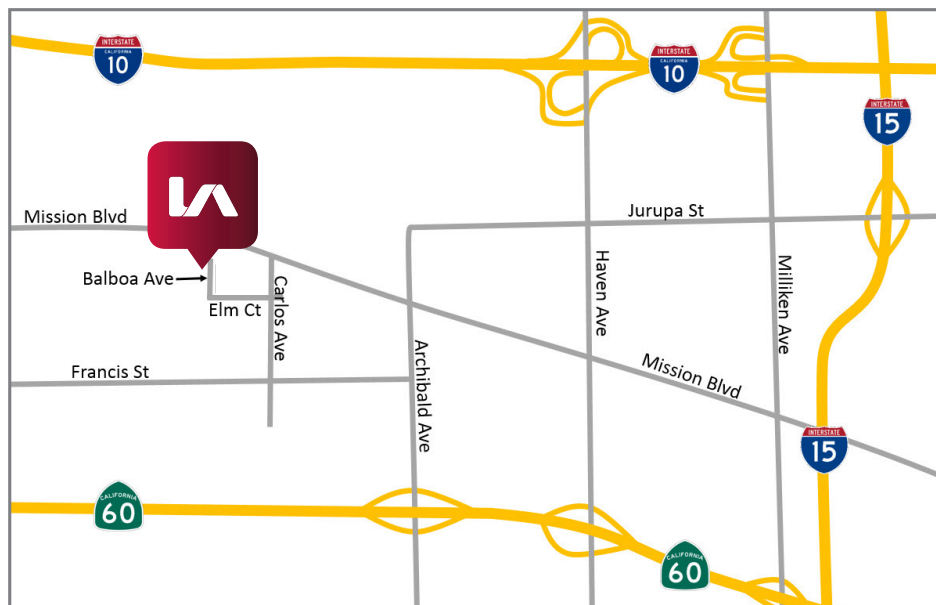

1420 S. BALBOA AVENUE | ONTARIO, CALIFORNIA 91761  
± 32,521 SF | AVAILABLE FOR LEASE

## PROPERTY FEATURES:

- ±32,521 SF Available for Lease
- ±3,028 SF of Office Space
- Fenced Yard Area
- Three (3) Dock High Doors
- Two (2) Ground Level Doors
- .50/2,000 SF Sprinkler System
- 22' Minimum Clearance Height
- 800 Amps, 277/480 Volts, 3 Phase
- IG Zoning (General Industrial)



**Don Kazanjian**

President

909.373.2929

dkazanjan@lee-assoc.com

DRE #00860886

**Lee & Associates® - Ontario**

3535 Inland Empire Blvd, Ontario, CA 91764 | 909.989.7771 | lee-assoc.com  
Corp ID 00976995

1420 S. BALBOA AVENUE | ONTARIO, CALIFORNIA 91761  
± 32,521 SF | AVAILABLE FOR LEASE

Aerial

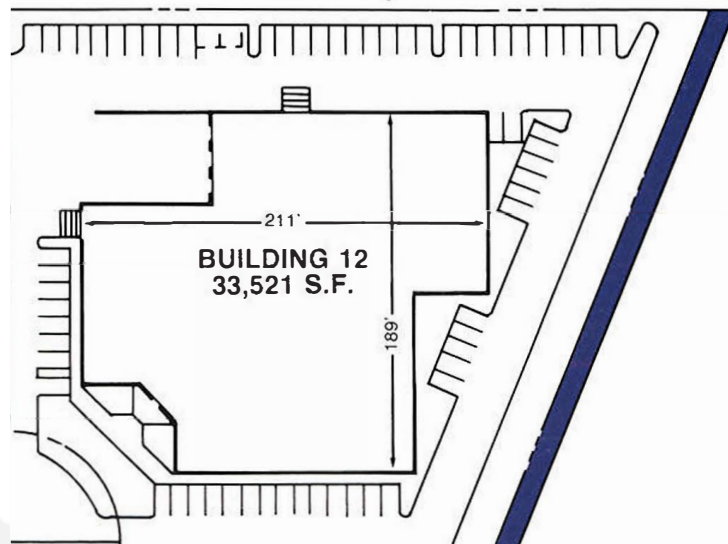

**Don Kazanjian**

President

909.373.2929

dkazanjian@lee-assoc.com

DRE #00860886

**Lee & Associates® - Ontario**

3535 Inland Empire Blvd, Ontario, CA 91764 | 909.989.7771 | lee-assoc.com  
Corp ID 00976995