

FOUNDER'S SQUARE

12 N. CENTRAL AVE.

MARSHFIELD, WI

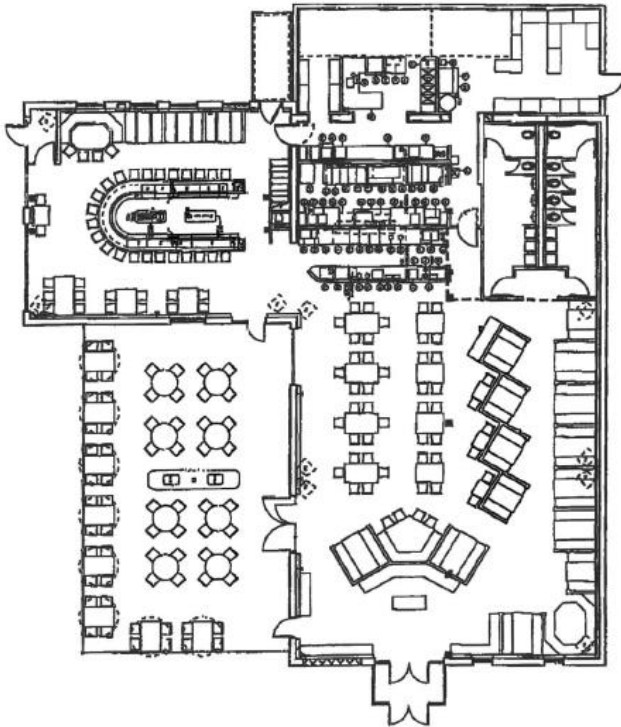
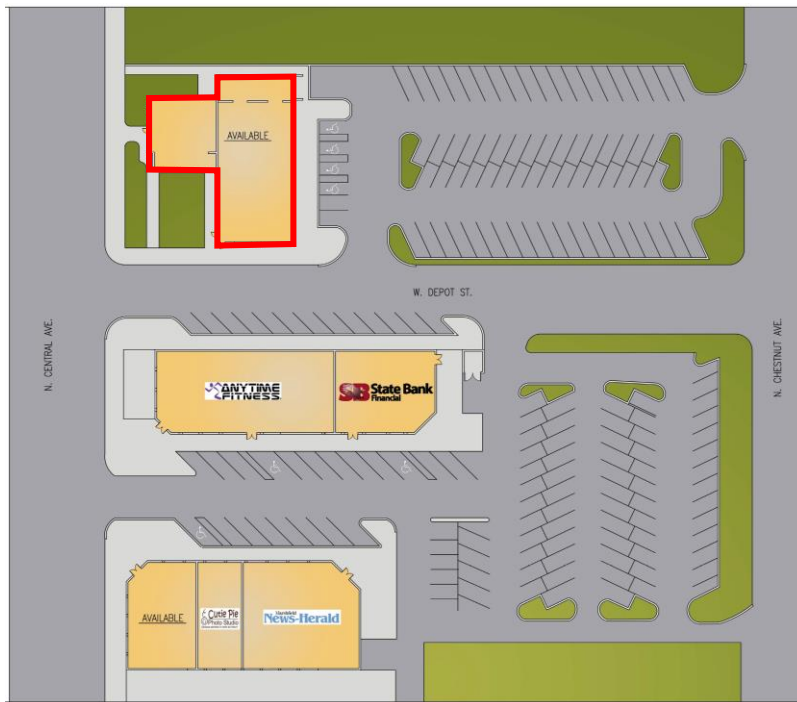

SUITE III-12 INFO

6,353 Square Feet

Great visibility from Central Ave.
(11,400 CPD)

Men's and Women's restrooms

Full kitchen and bar

Lease rate: \$10.00 NNN

Sale price: \$950,000

AMENITIES

- Located in the center of Marshfield's Business District
- At intersection of Hwy 13 & 97
- Diverse tenant mix featuring professional offices, fitness club, and bank
- 70 stall parking lot
- Across street from Kwik Trip gas station/convenience store

