



**CUSHMAN &
WAKEFIELD**
Commerce

FOR LEASE

4730 South 500 West
Murray, Utah 84123



Lease Rate: \$0.55 PSF MG

Property Highlights

- 6,574 SF
- Office: can be built to suit
- (1) 12' x 12' ground level overhead door
- (1) 10' x 10' dock high overhead door
- 3 phase power
- Great location and close to access to I-15



Bob Mills
Executive Director
+1 801 303 5551
bmills@comre.com

170 South Main Street, Suite 1600
Salt Lake City, UT 84101
Main +1 801 322 2000
Fax +1 801 322 2040
comre.com

Independently Owned and Operated / A Member of the Cushman & Wakefield Alliance

Cushman & Wakefield Copyright 2017. No warranty or representation, express or implied, is made to the accuracy or completeness of the information contained herein, and same is submitted subject to errors, omissions, change of price, rental or other conditions, withdrawal without notice, and to any special listing conditions imposed by the property owner(s). As applicable, we make no representation as to the condition of the property (or properties) in question. (path: G:\1 - Projects\Mills, B\1 - Flyers\4730s500w)



**CUSHMAN &
WAKEFIELD**
Commerce

FOR LEASE

4730 South 500 West
Murray, Utah 84123

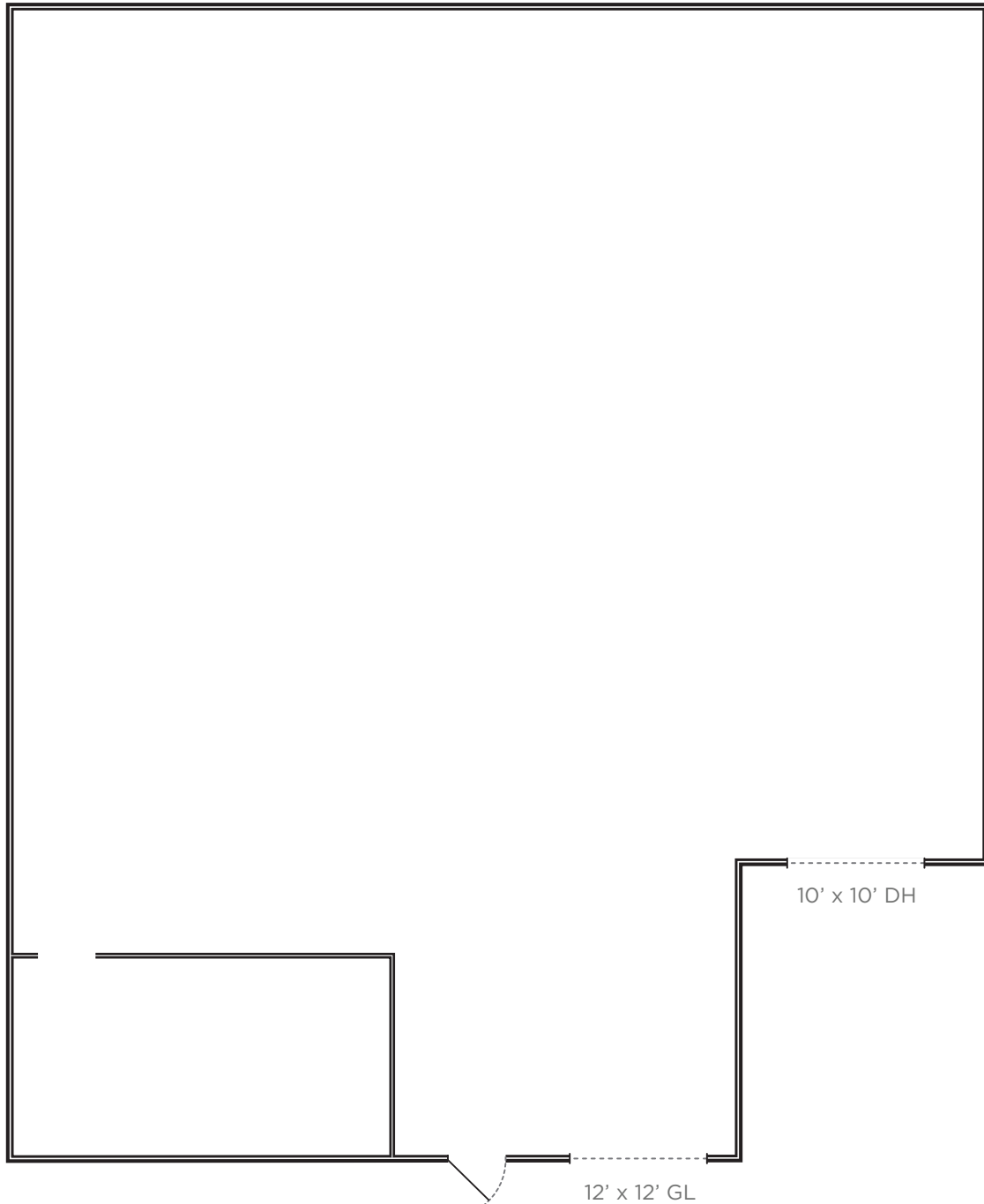

Bob Mills
Executive Director
+1 801 303 5551
bmills@comre.com

170 South Main Street, Suite 1600
Salt Lake City, UT 84101
Main +1 801 322 2000
Fax +1 801 322 2040
comre.com

Independently Owned and Operated / A Member of the Cushman & Wakefield Alliance

Cushman & Wakefield Copyright 2017. No warranty or representation, express or implied, is made to the accuracy or completeness of the information contained herein, and same is submitted subject to errors, omissions, change of price, rental or other conditions, withdrawal without notice, and to any special listing conditions imposed by the property owner(s). As applicable, we make no representation as to the condition of the property (or properties) in question. (path: G:\1 - Projects\Mills, B\1 - Flyers\4730s500w)