

PROPERTY OVERVIEW

- 13.30 Acres available for Build-To-Suit or Sale
- Site can accommodate up to 252,000 SF
- Site can be developed as:
 - Option 1: 232,000 SF cross dock with 210 parking spaces
 - Option 2: 252,000 SF cross dock with 205 parking spaces
 - Option 3: 2 rear load buildings, 228,600 SF with 230 parking spaces
 - Option 3: 2 rear load buildings, 216,600 SF with 290 parking spaces
- This is a high quality, mature industrial park with over 2 million SF of buildings already in place.
- The Park is institutionally owned and maintained, and the site is fully entitled.
- Off-site water retention
- All utilities stubbed to the site(s)
- Zoned I-P (Industrial Park, City of Orlando)
- Buildings can be designed in any configuration. Site plans attached show rear load and cross dock configurations.

LOCATION OVERVIEW

Located within the Center of Commerce, a Class A Institutional Quality Industrial Park within the Silver Star Submarket.

ECONOMIC DATA

Owner will Build-to-Suit

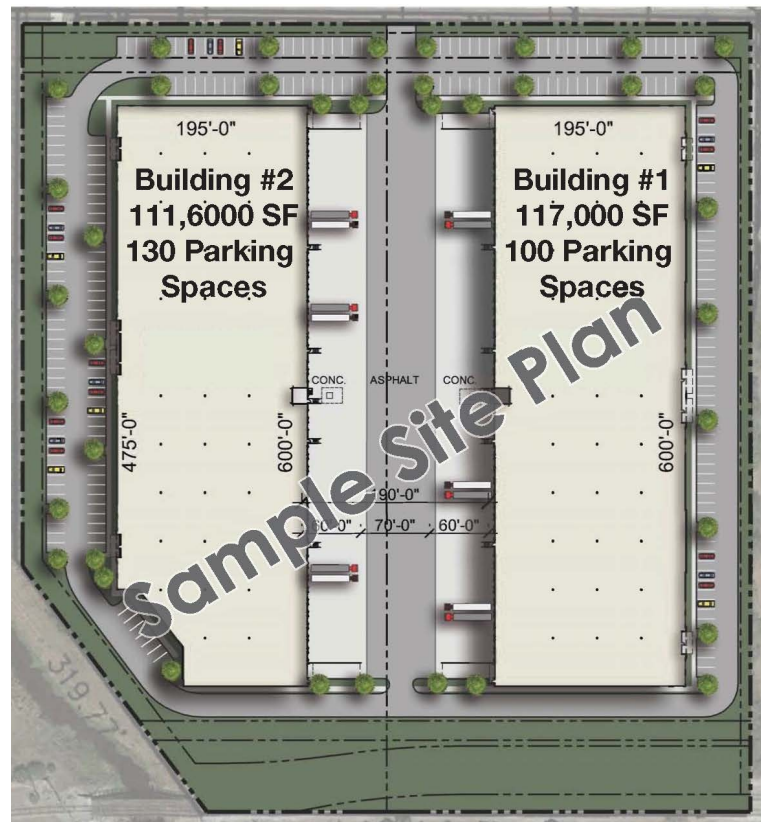



PROPERTY OVERVIEW

County: Orange
Submarket: Silverstar

LAND DATA

Total Land Size: 13.30 Acres available for Build-To-Suit
Zoning: I-P (Industrial Park, City of Orlando)

TRANSPORTATION

Distance To:
I-4: 4.19 Miles
E/W / SR 408: 4.14 Miles
FL Turnpike: 9.30 Miles

