

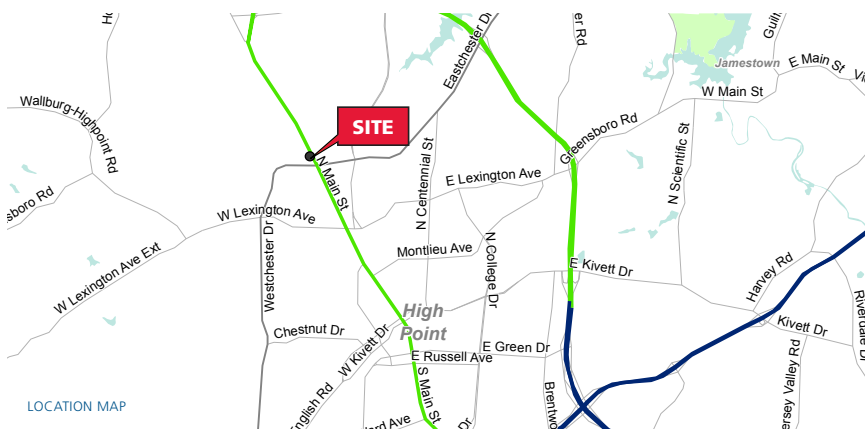

NEW DEVELOPMENT IN HIGH POINT, NC

2209 N. MAIN STREET | HIGH POINT, NC



PROPERTY INFORMATION

SHOP SF AVAILABLE:

Up to 4,200 SF Available for ground lease or build-to-suit

PROPERTY HIGHLIGHTS

- Excellent exposure on N. Main Street
- Drive Thru Capability
- Over 29,000 cars per day in front of the site
- Full Access (Via Parris Ave)
- Surrounding retails include Target, Wal-Mart, Harris teeter, PetSmart, TJ Maxx, Ross and Homegoods.

DEMOGRAPHICS (2015)

	1 MILE	3 MILE	5 MILE
Population	8,724	59,717	111,177
Average HH Income	\$49,443	\$51,762	\$57,095
Business Establishments	690	3,026	5,334
Daytime Employment	5,973	33,786	65,446

NEW DEVELOPMENT IN HIGH POINT, NC

2209 N. MAIN STREET | HIGH POINT, NC

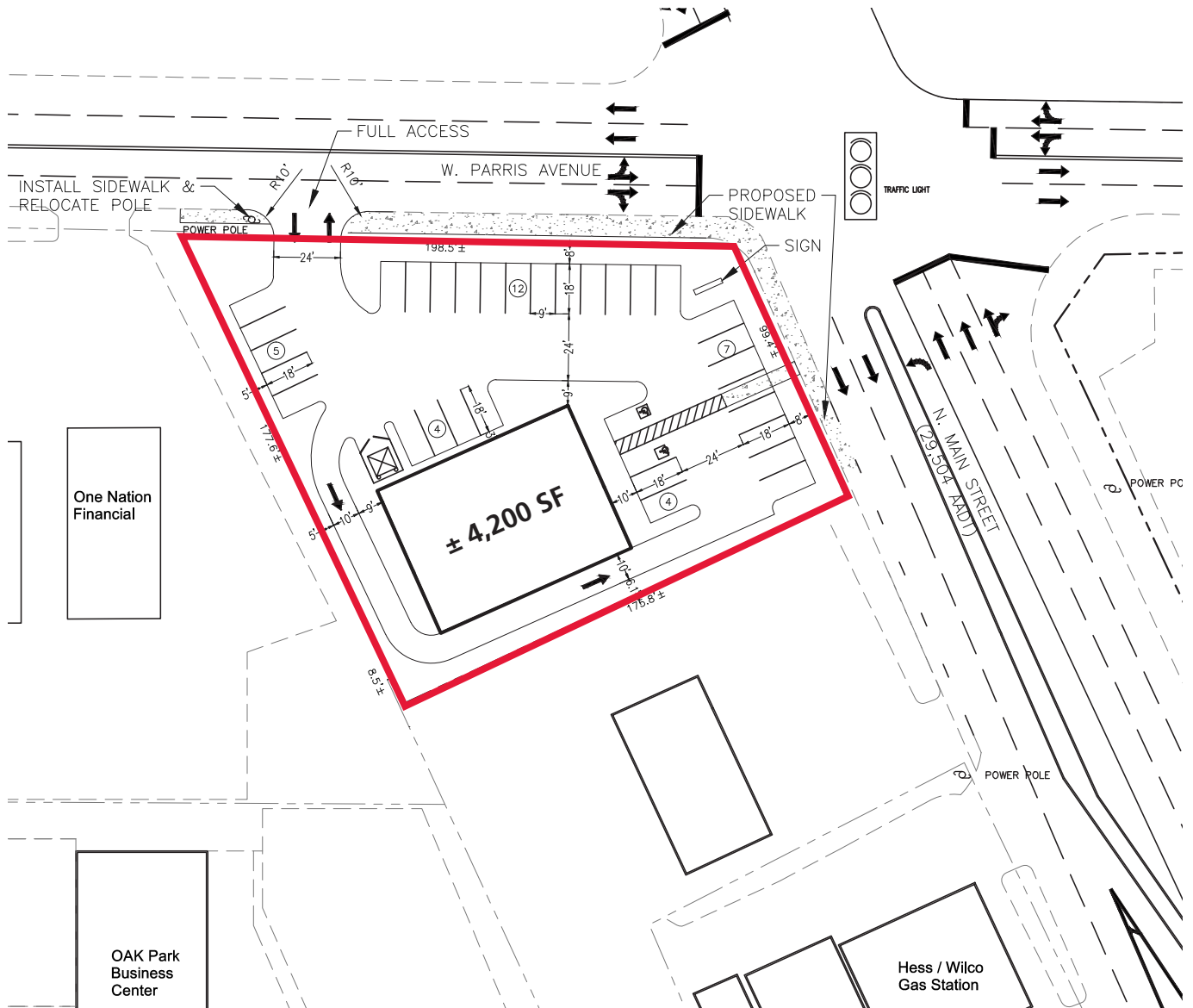

TRAFFIC COUNTS 2015 (NCDOT)

- 29,000 VPD on North Main Street

1616 Camden Rd. Suite 550 | Charlotte, NC 28203 | Phone (704) 644-4595 | Fax (704) 973-0737
Wes Thurmond | wthurmond@providencegroup.com | www.providencegroup.com

