

For Lease  
2,691 SF



## 2451 Stone Myers Parkway Grapevine, Texas 76051

### Property Features

- Convenient Access to DFW International Airport, Highway 121 and Highway 360
- New Construction
- Medical/Office/Showroom Ready
- Building Signage Available

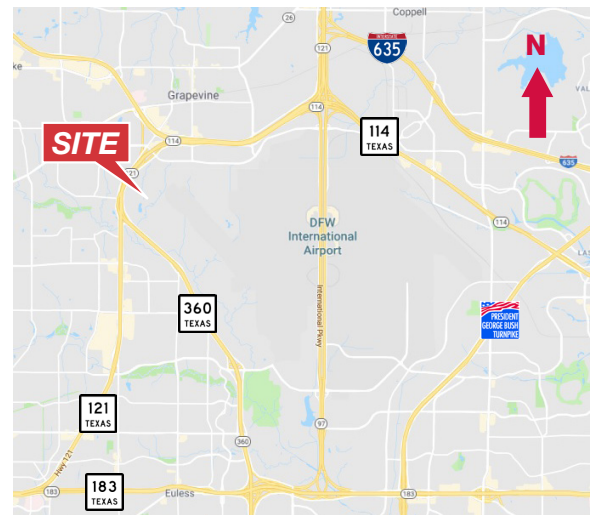

**Colt Power, SIOR, CCIM**

817 872 3905  
cpower@robertlynn.com

**Rob Kearney**

817 872 3912  
rkearney@robertlynn.com



THE INFORMATION CONTAINED HEREIN HAS BEEN GIVEN TO US BY THE OWNER OF THE PROPERTY OR OTHER SOURCES WE DEEM RELIABLE. WE HAVE NO REASON TO DOUBT ITS ACCURACY, BUT WE DO NOT GUARANTEE IT. ALL INFORMATION SHOULD BE VERIFIED PRIOR TO PURCHASE OR LEASE.

1200 Summit Avenue Suite 800  
Fort Worth TX 76102  
817 885 8333

[nairl.com](http://nairl.com)

For Lease  
**2,691 SF**

# 2451 Stone Myers Parkway

Grapevine, Texas 76051

## Potential Layout

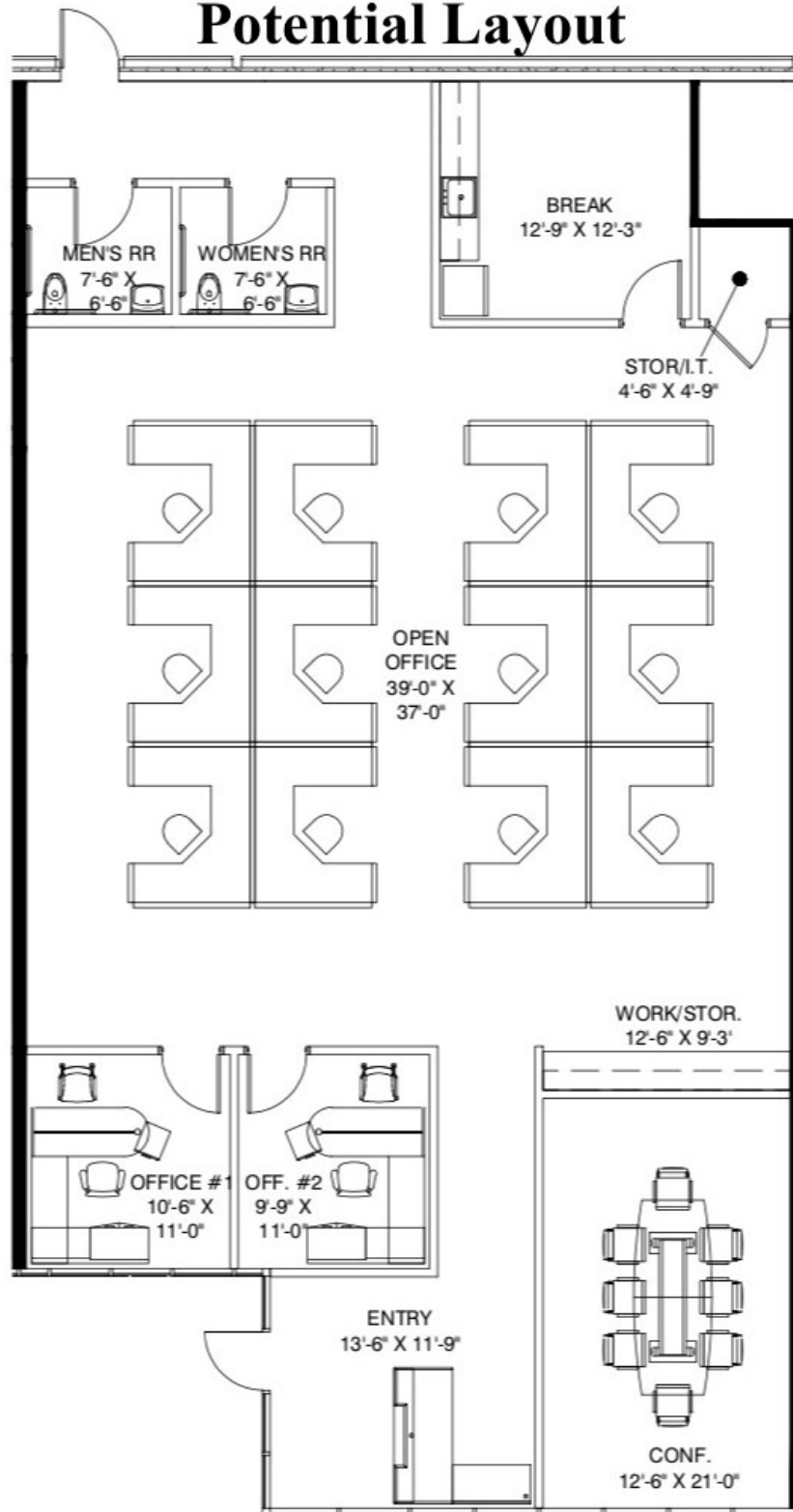

For Lease  
**2,691 SF**

# 2451 Stone Myers Parkway

Grapevine, Texas 76051

## Site Plan

