

For Sale

±5,866 SF

353 W. Grove Avenue, Orange



Features:

- High Image Corner Unit
- ±1,068 Square Feet Windowed Office Space
- 18' Warehouse Clearance
- One (1) Ground Level Loading Door
- 400 Amps of 120/208 voltage (verify)
- Fully Fire Sprinklered
- Built in 2005
- Bonus Mezzanine Storage
- Immediate Access to Orange (57), Costa Mesa (55), Riverside (91) and Santa Ana (5) Freeways

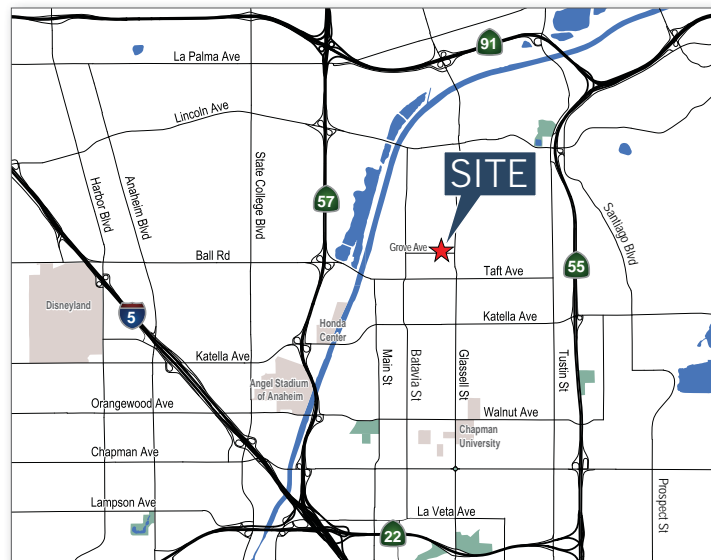

Jason DiRocco

714.935.2305

JDiRocco@voitco.com

Lic#01842301

Stan Kwak

714.935.2327

SKwak@voitco.com

Lic#01824776

Joe Miller

714.935.2315

JMiller@voitco.com

Lic#01326530

Voit

REAL ESTATE SERVICES

For Sale

±5,866 SF

353 W. Grove Avenue, Orange

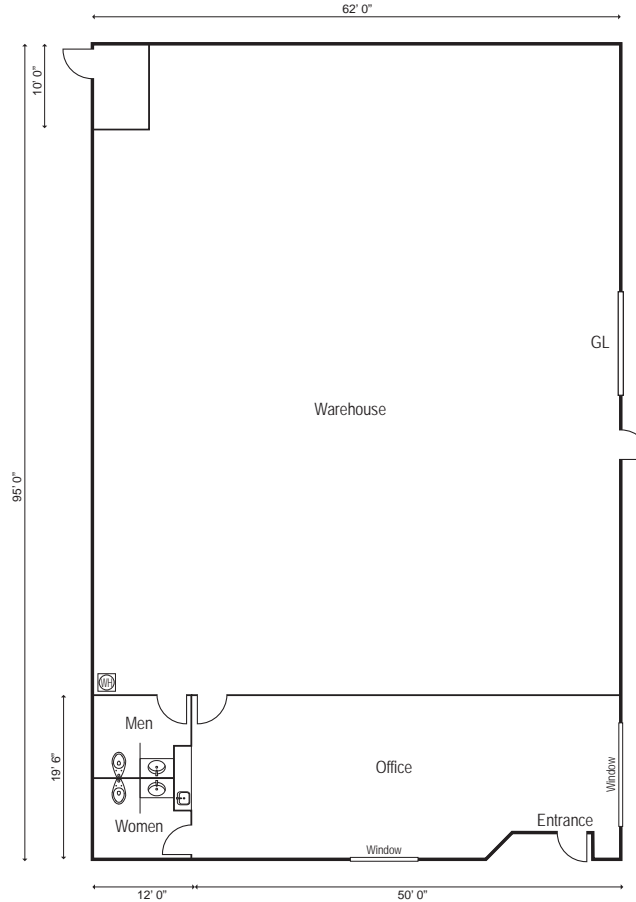

Jason DiRocco

714.935.2305

JDiRocco@voitco.com

Lic#01842301

Stan Kwak

714.935.2327

SKwak@voitco.com

Lic#01824776

Joe Miller

714.935.2315

JMiller@voitco.com

Lic#01326530

Voit

REAL ESTATE SERVICES

2400 E. Katella Avenue, Ste. 750, Anaheim, CA 92806 • Lic #01333376 | www.voitco.com

CORFAC
International

The information contained herein has been obtained from sources we deem reliable. While we have no reason to doubt its accuracy, we do not guarantee it.
©2014 Voit Real Estate Services, Inc. All Rights Reserved. Real People. Real Solutions.® is a registered trademark of Voit Real Estate Services.