

**Vacant Land** Mount Olive, New Jersey 07828



**RD**  
MANAGEMENT LLC

**Mount Olive, NJ**

**Vacant Land**



**Location:**

Adjacent to the International Trade Zone in Morris County at 56 Route 46 at the intersection of Rt. 46 and I-80 in Mount Olive, New Jersey 07828.

**Type:**

Vacant Land – 19.9 Acres

**GLA:**

To be determined

**Parking:**

To be determined

**Traffic:**

Two way average daily traffic  
45,000 cars per day

**Area Retailers:**

ITC Crossing:  
Walmart, TJ Maxx, Michael's,  
Bed Bath & Beyond, Lowe's,  
Old Navy, PetSmart, Pier 1  
Imports, Panera Bread

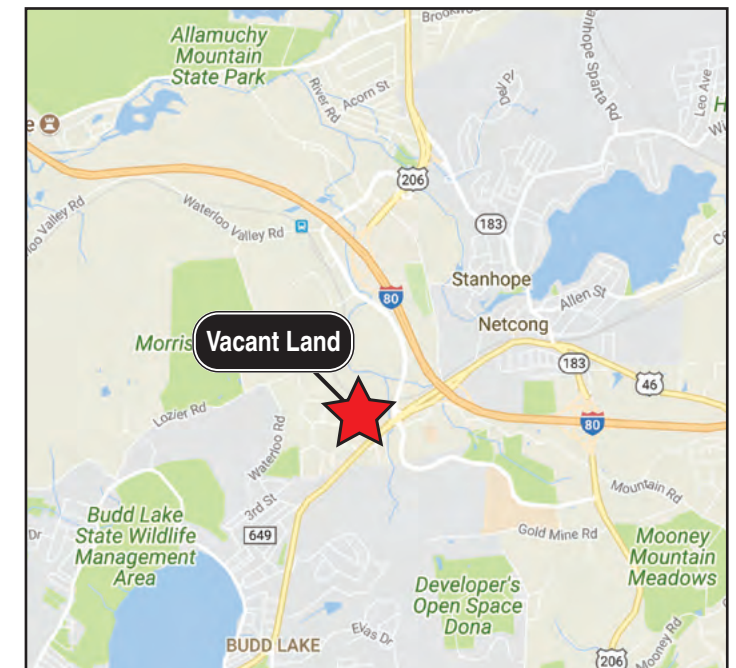

Demographics	3 mile	5 mile	7 mile
<b>Population</b>			
2023 (projection)	32,484	74,589	122,765
2018 (estimate)	32,621	74,824	123,555
2010 (census)	32,064	74,358	123,238
<b>Number of HH</b>			
2023 (projection)	13,289	29,816	49,101
2018 (estimate)	12,897	28,923	47,742
2010 (census)	12,364	27,925	46,121
<b>Average HH Income</b>			
2023 (projection)	\$136,677	\$156,566	\$161,198
2018 (estimate)	\$110,363	\$125,596	\$129,160
2010 (census)	\$87,642	\$94,909	\$99,863
<b>Median Age</b>			
2018 (estimate)	38.0	40.1	41.0
<b>Daytime Population</b>			
2018 (estimate)	19,374	47,793	81,956

**RD Management LLC**  
**Darren Sasso**  
212-265-6600 x354  
dsasso@rdmanagement.com

810 Seventh Avenue, 10th floor  
New York, NY 10019

**RD Management LLC is ranked one of the Top 100 Retail Real Estate Owners in the U.S.**

Information furnished is from sources deemed reliable, but is not guaranteed by RD Management and is subject to change in price, corrections, errors and omissions, prior sales or withdrawal without notice.

# Vacant Land

Route 46 & I-80

Mount Olive, New Jersey 07828



**Darren Sasso**  
212-265-6600 x354  
dsasso@rdmanagement.com  
810 Seventh Avenue, 10th floor  
New York, NY 10019

## RETAIL CONCEPT

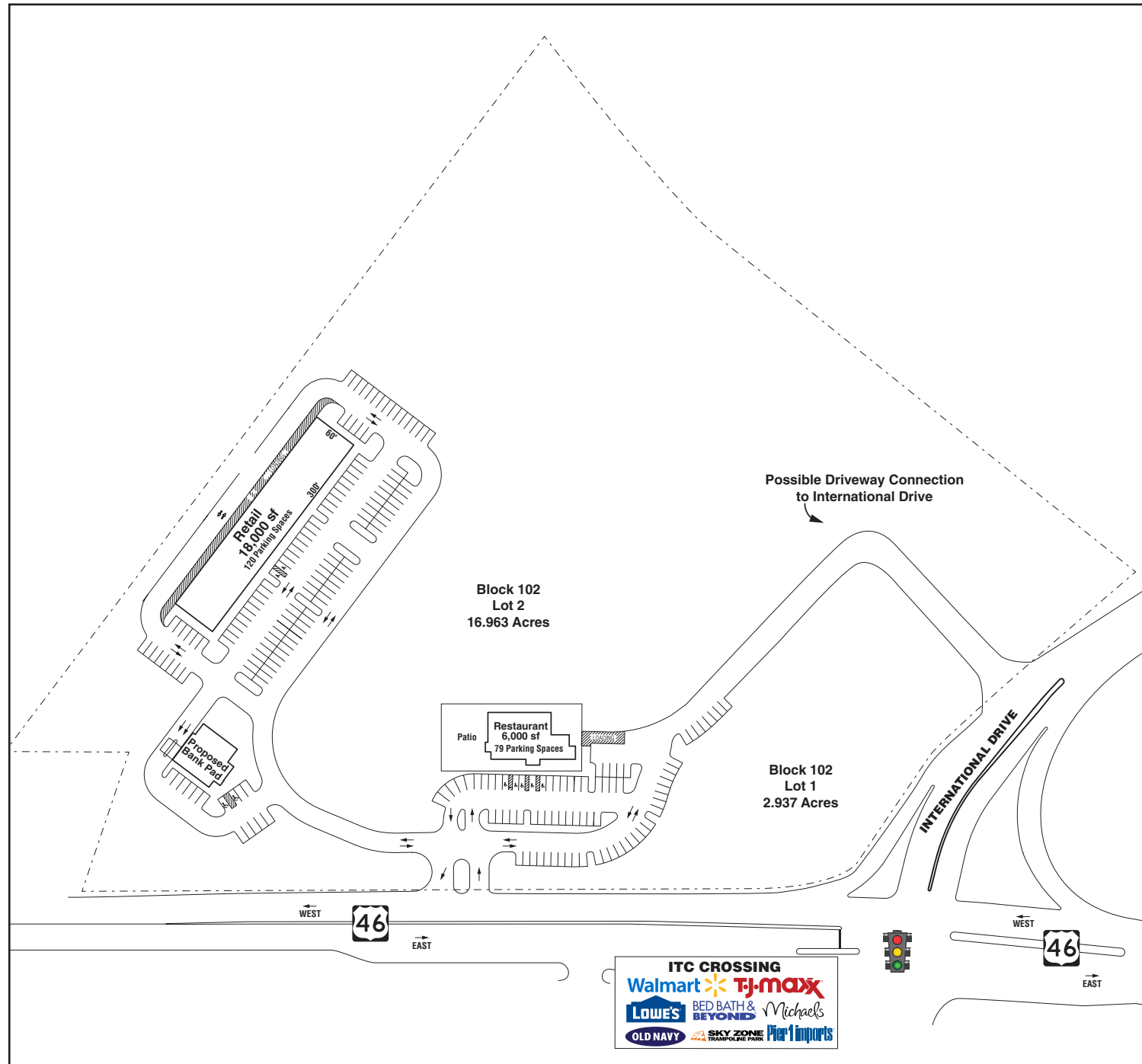

## RESTAURANT CONCEPT

