

# Stapleton Business Center North

5501 Havana Street

Denver, CO 80238 USA

**249,820 Square Feet Industrial Space For Lease**



**PROLOGIS**

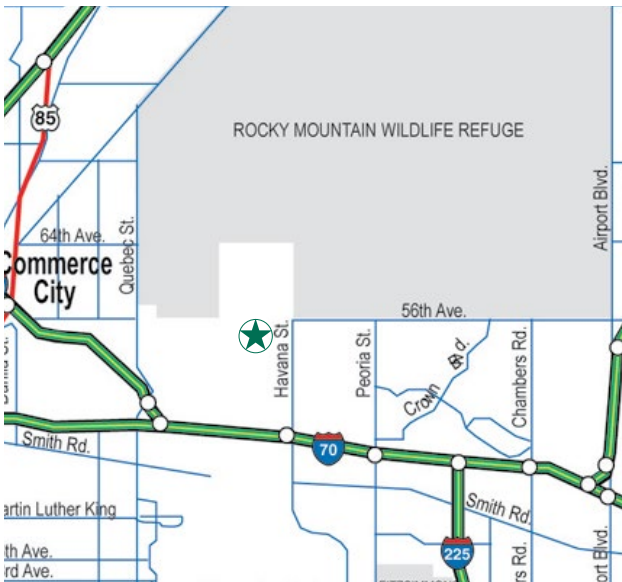

## location

- Easy access to 56th Avenue, Havana Street to I-70, I-225, I-25 and I-270
- 13 miles to DIA
- 9 miles to Downtown Denver
- Located in the Denver Enterprise Zone
- Prologis owned and operated

## features

- 249,820 SF for lease
- Office-to-suit
- Divisible to 40,000 SF
- 32' minimum clear height
- 185' truck courts
- 220' building depth
- 310 auto spaces (1:806)
- 59 trailer stalls (1:4,234)
- 32 dock-high doors
- 4 drive-in doors
- Front-park, rear-load
- 50' x 52' column spacing
- ESFR sprinkler system
- Denver CMU30 Industrial zoned
- Planned LEED Certification
- Energy efficient building features and design
- Q4-2015 expected delivery date

Jim Bolt  
james.bolt@cbre.com  
ph 720.528.6310

Mike Camp  
mike.camp@cbre.com  
ph 720.528.6313

Bill Thompson, SIOR  
bill.thompson@cbre.com  
ph 720.528.6373

**CBRE**

8390 E. Crescent Pkwy., Ste. 300  
Greenwood Village, CO 80111  
www.cbre.com/denver



**PROLOGIS**

**Prologis**  
Wayne E. Barrett  
wbarrett@prologis.com  
ph 303.567.5688  
fax 303.567.5903

4545 Airport Way  
Denver, CO 80239  
www.prologis.com

# Stapleton Business Center North

5501 Havana Street

Denver, CO 80238 USA

249,820 Square Feet Industrial Space For Lease



**PROLOGIS**

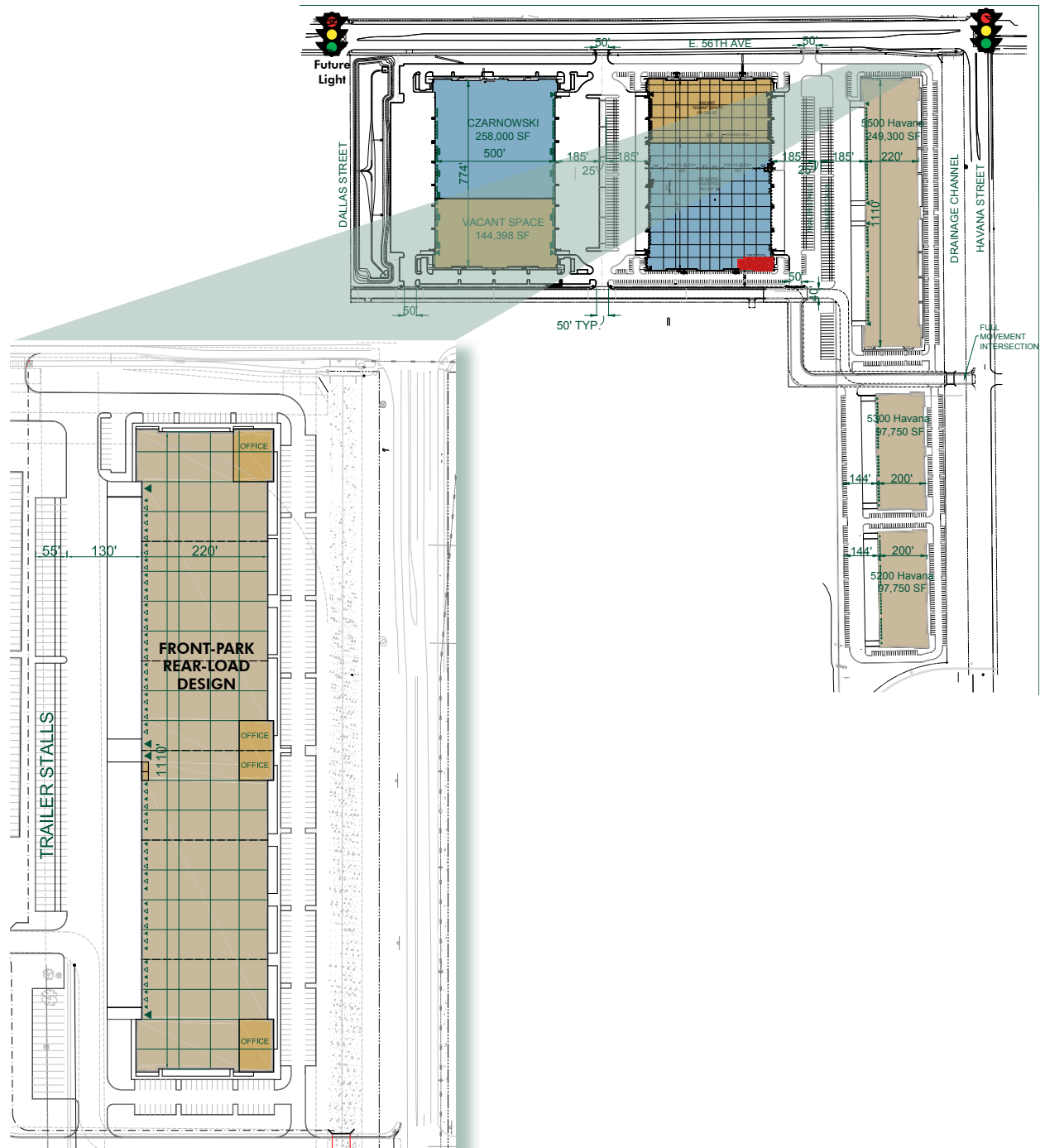

Jim Bolt  
james.bolt@cbre.com  
ph 720.528.6310

Mike Camp  
mike.camp@cbre.com  
ph 720.528.6313

Bill Thompson, SIOR  
bill.thompson@cbre.com  
ph 720.528.6373

**CBRE**

8390 E. Crescent Pkwy., Ste. 300  
Greenwood Village, CO 80111  
www.cbre.com/denver

**Prologis**  
Wayne E. Barrett  
wbarrett@prologis.com  
ph 303.567.5688  
fax 303.567.5903



**PROLOGIS**

4545 Airport Way  
Denver, CO 80239  
www.prologis.com