

# 224

STRAWBRIDGE DRIVE

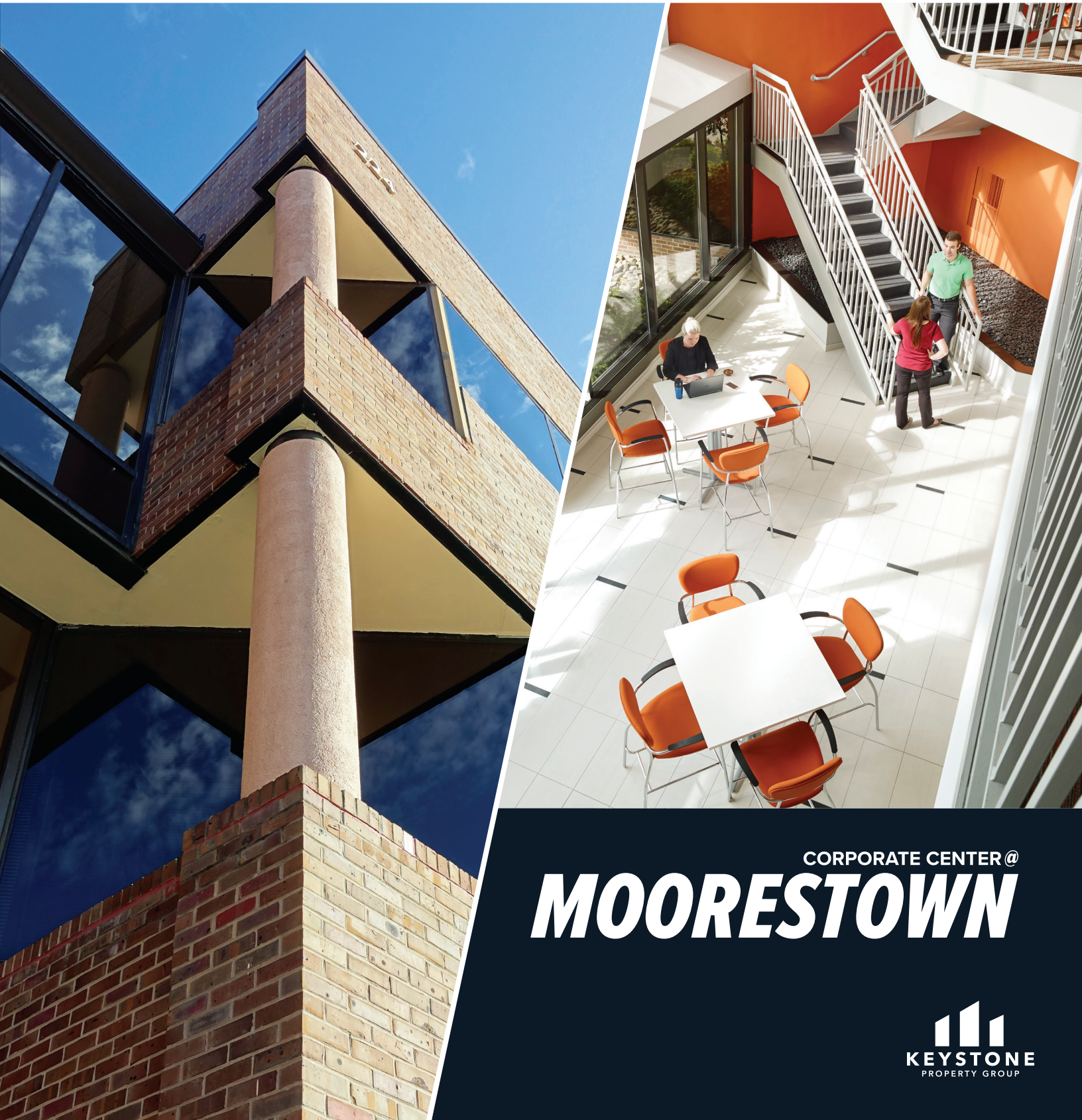

CORPORATE CENTER @  
**MOORESTOWN**

  
**KEYSTONE**  
PROPERTY GROUP





# BE A WORKFORCE TO BE RECKONED WITH

## COLLABORATE

New, modern lobby offers a creative space outside the office to collaborate and network, enhanced by complimentary KeystoneConnect Wifi.

## CREATE

Create a work space that inspires. 224 offers flexible floorplans with seamless window lines providing abundant natural light.

## THRIVE

224 thrives on ease of access with a prominent location on Route 38 proximate to I-295 and the NJ Turnpike, and convenient to dining and retail.

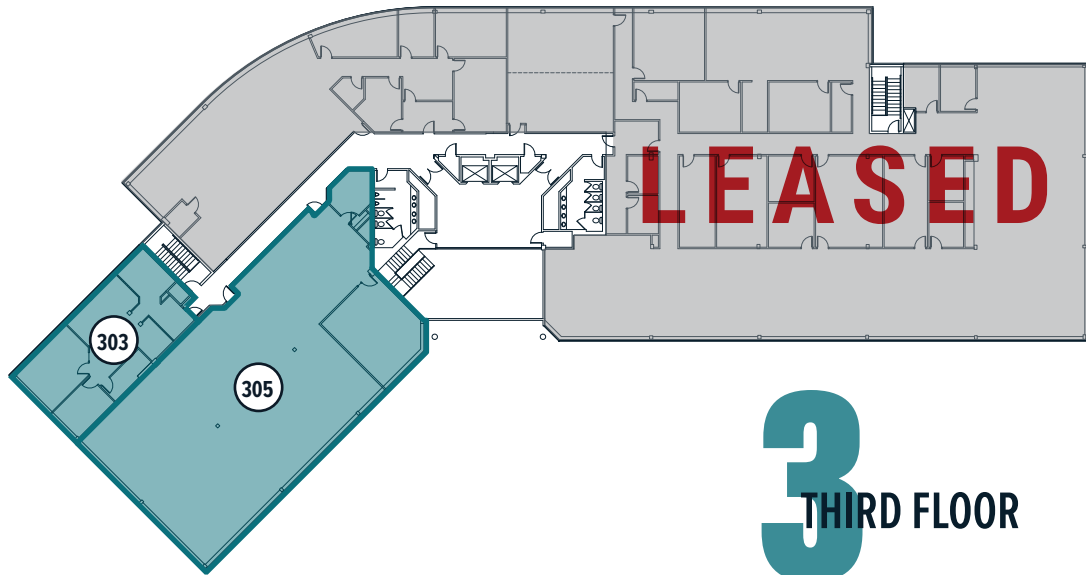

**3**  
THIRD FLOOR



**2**  
SECOND FLOOR

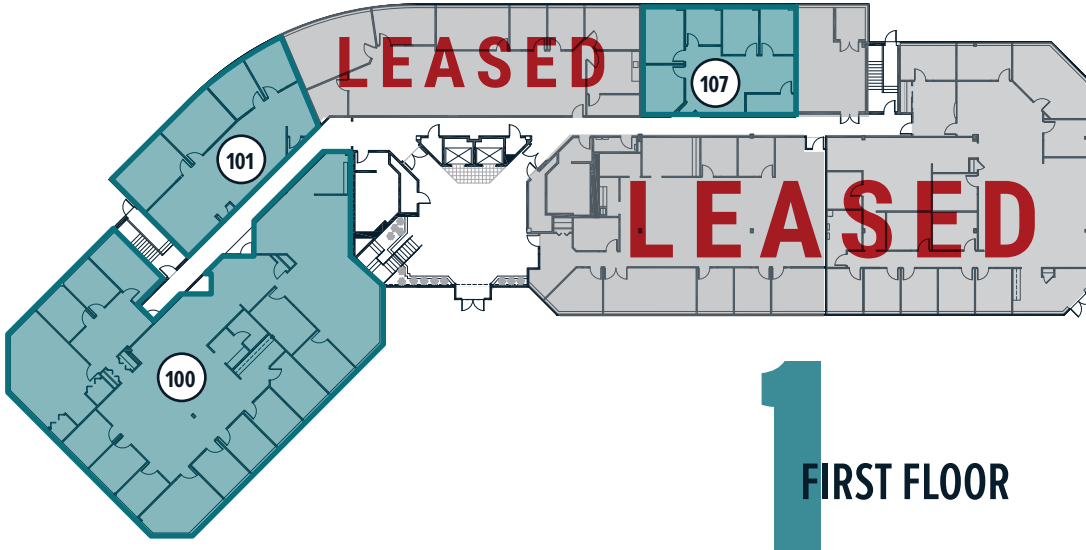

**1**  
FIRST FLOOR

**AVAILABILITIES**

- 1ST FL**
- Ste 100: 6,670 SF
- Ste 101: 1,960 SF
- Ste 107: 1,451 SF
- 3RD FL**
- Ste 303: 1,526 SF
- Ste 305: 5,828 SF

## YOU ARE HERE

- ◆ Located on Route 38 with easy access to I-295 & the New Jersey Turnpike
- ◆ 15 minutes to Center City Philadelphia
- ◆ Nearby bus stops for NJ Transit Routes 317 & 407

## 1 MILE

Moorestown Mall  
Firebird's  
Yard House  
Harvest Grill  
Catelli Duo  
Chipotle  
Corner Bakery  
PJ Whelihan's

## 2 MILES

Homewood Suites  
DoubleTree Suites  
Courtyard Marriot  
Iron Hill Brewery

## 3 MILES

Wyndham Hotel  
FedEx  
Wawa  
Wegman's  
Target  
Starbucks  
Panera Bread  
Chick-Fil-A

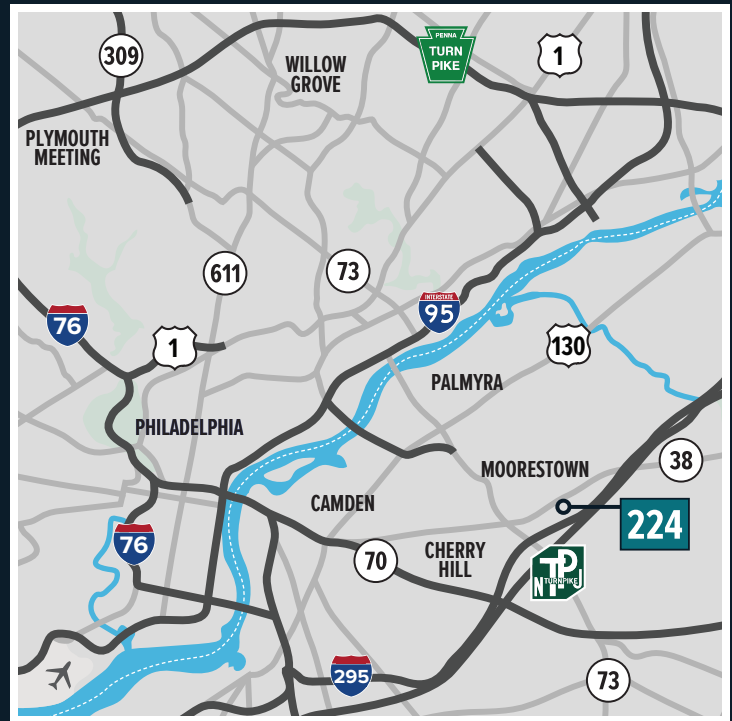

## LEASING INFO

### Anne Klein

Executive Managing Director  
(856) 334-2110  
aklein@ngkf.com

### Keith McClure

Associate Director  
(856) 334-2122  
kmcclure@ngkf.com

40 Lake Center Executive Park  
401 Route 73 North  
Suite 120  
Marlton, NJ 08053

Office: 856.334.2100  
www.ngkf.com



**Keystone** develops and invests in commercial properties, with a focus on creating inspired work and retail spaces that encourage collaboration and cultural vibrancy.

Headquartered in PA with offices in NJ, NY and FL, Keystone operates in strategic locations to build, revitalize & unlock potential in office buildings designed to meet the evolving demands of the modern workplace.

125 E. Elm Street  
Conshohocken, PA 19428  
610 980 7000

[www.keystonepropertygroup.com](http://www.keystonepropertygroup.com)  
[twitter.com/keystone](https://twitter.com/keystone)