

**FOR
LEASE**

575 & 551-B N BATAVIA STREET | ORANGE, CA

±20,072 SF INDUSTRIAL BUILDING & ±27,420 SF FENCED YARD



575 N BATAVIA HIGHLIGHTS:

- ±20,072 SF Industrial Building
- ±500 SF of Office
- Major Street Frontage
- 400 Amps (verify)
- Two (2) Roll Up Doors
- M2 Zoning
- Heavy Use Accepted
- Lease Term Through 8/31/2019
- Available with 30 Days Notice
- Can be Combined with 551-B N Batavia

551-B N BATAVIA HIGHLIGHTS:

- ±27,420 SF Fenced Yard
- M2 Zoning
- Heavy Use Accepted
- Lease Term Through 8/31/2019
- Can be Combined with 575 N Batavia

For more information, please contact:

JOHN MARTIN

SVP/Principal

T: 949.724.4701

F: 949.623.6301

E: john@lee-associates.com

CalBRE #: 01346629

CHRIS COYTE

SVP/Principal

T: 949.724.4747

F: 949.623.6347

E: ccoyle@lee-associates.com

CalBRE #: 01017328

**LEE &
ASSOCIATES**

COMMERCIAL REAL ESTATE SERVICES
LEE & ASSOCIATES - NEWPORT BEACH
100 BAYVIEW CIRCLE, SUITE 600
NEWPORT BEACH, CA 92660
949.724.1000 | WWW.LEE-ASSOCIATES.COM

575 & 551-B N BATAVIA STREET | ORANGE, CA

±20,072 SF INDUSTRIAL BUILDING & ±27,420 SF FENCED YARD

**FOR
LEASE**



575 N BATAVIA FLOOR PLAN

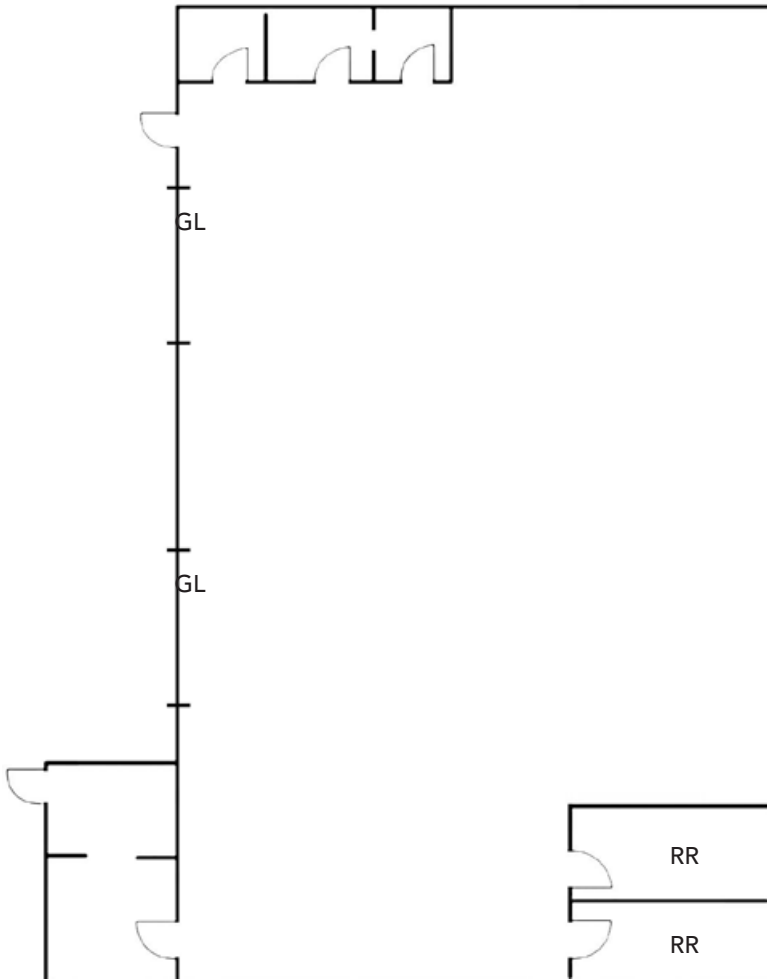

LOCATION MAP

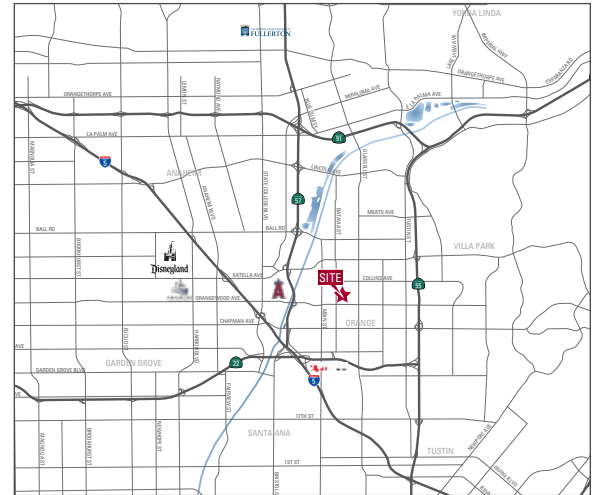

For more information, please contact:

JOHN MARTIN

SVP/Principal

T: 949.724.4701

F: 949.623.6301

E: john@lee-associates.com

CalBRE #: 01346629

CHRIS COYTE

SVP/Principal

T: 949.724.4747

F: 949.623.6347

E: ccoyle@lee-associates.com

CalBRE #: 01017328

DISCLAIMER: The information contained herein has been obtained from the property owner or other third party and is provided to you without verification as to accuracy. We (Lee & Associates, its brokers, employees, agents, principals, officers, directors and affiliates) make no warranty or representation regarding the information, property, or transaction. You and your attorneys, advisors and consultants should conduct your own investigation of the property and transaction.